

FAU	SECTION	COUNTY	TOTAL SHEETS	SHEET NO.
2503	(35)BR-2	KENDALL	129	62
STA. 7+00.00		TO STA. 7+28.75		
FED. ROAD DIST. NO.		ILLINOIS FED. AID PROJECT		
65	70	75	80	

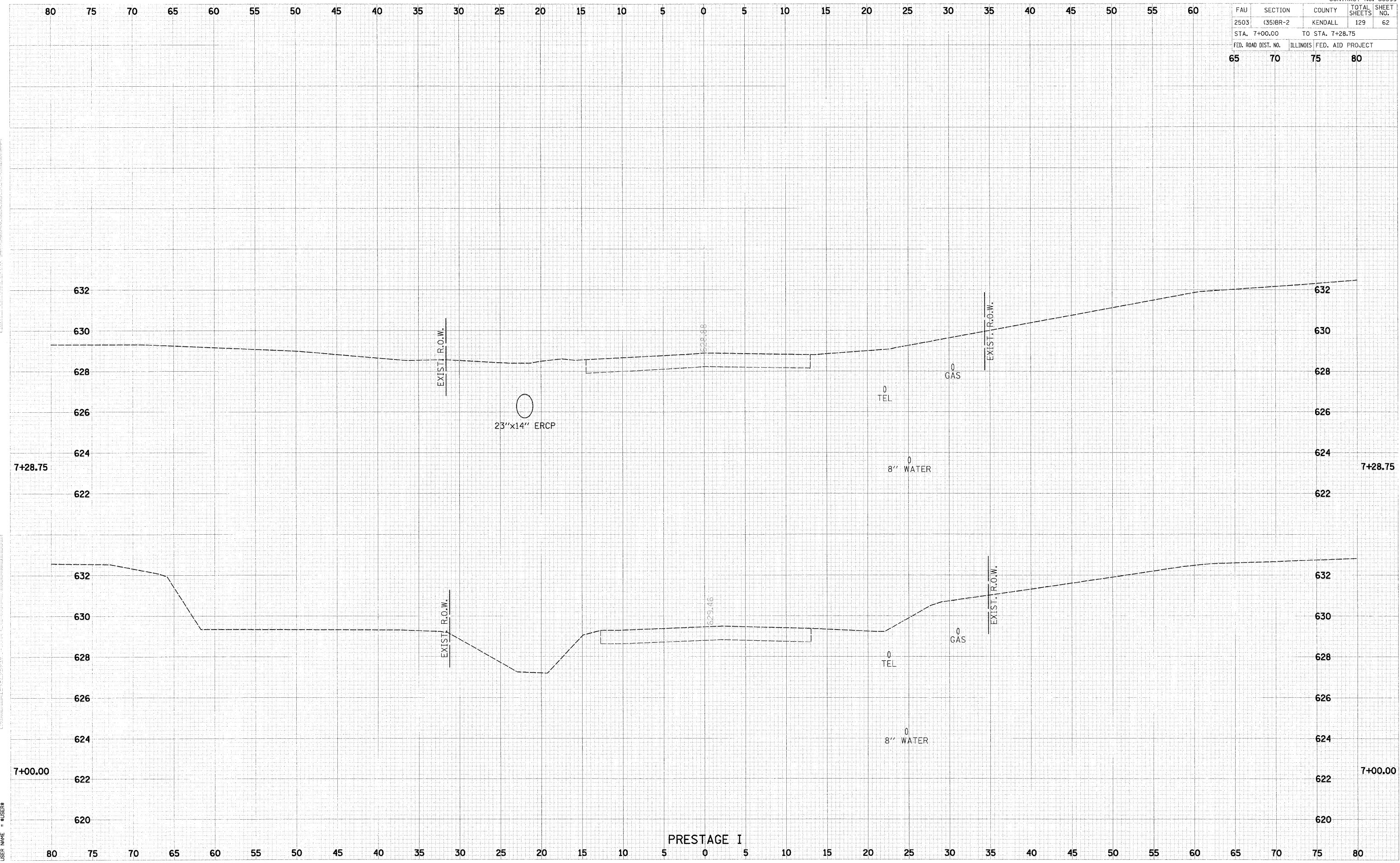

DATE: _____ BY: _____
 CHECKED: _____
 DESIGNED: _____
 DRAWN: _____
 PLOTTED: _____
 DATE PLOTTED: _____
 AREA CHECKED: _____

DATE: 1/31/2008
 FILE NAME: P:\12\260029\1\road\Phase II\06029-sht-xs-prestage1.dgn
 PLOT SCALE: 1/8" = 1'-0"
 USER NAME: JUSKIN