

FAU	SECTION	COUNTY	TOTAL SHEETS	SHEET NO.
2503	(35)BR-2	KENDALL	129	63
STA. 7+50.00		TO STA. 7+69.84		
FED. ROAD DIST. NO.		ILLINOIS	FED. AID PROJECT	
65	70	75	80	

DATE	BY

DATE	BY

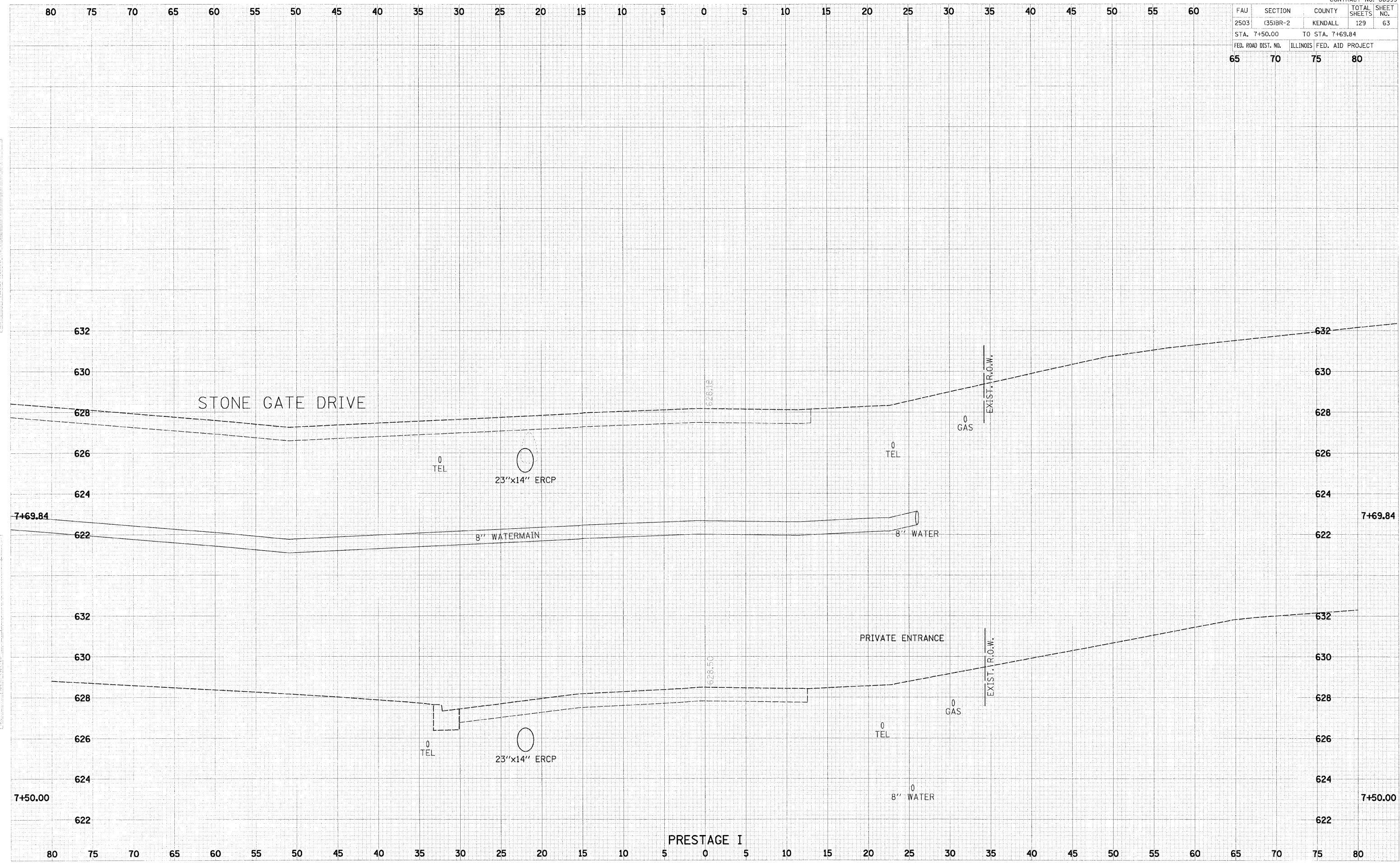

PRESTAGE I