

FAU	SECTION	COUNTY	TOTAL SHEETS	SHEET NO.
2503	(35)BR-2	KENDALL	129	74
STA. 14+00.00		TO STA. 14+00.00		
FED. ROAD DIST. NO.	ILLINOIS	FED. AID PROJECT		
65	70	75	80	

DATE	BY
DESIGNED	CHECKED
DRAWN	APPROVED
NOTED	
AREA	

DATE	BY
DESIGNED	CHECKED
DRAWN	APPROVED
NOTED	
AREA	

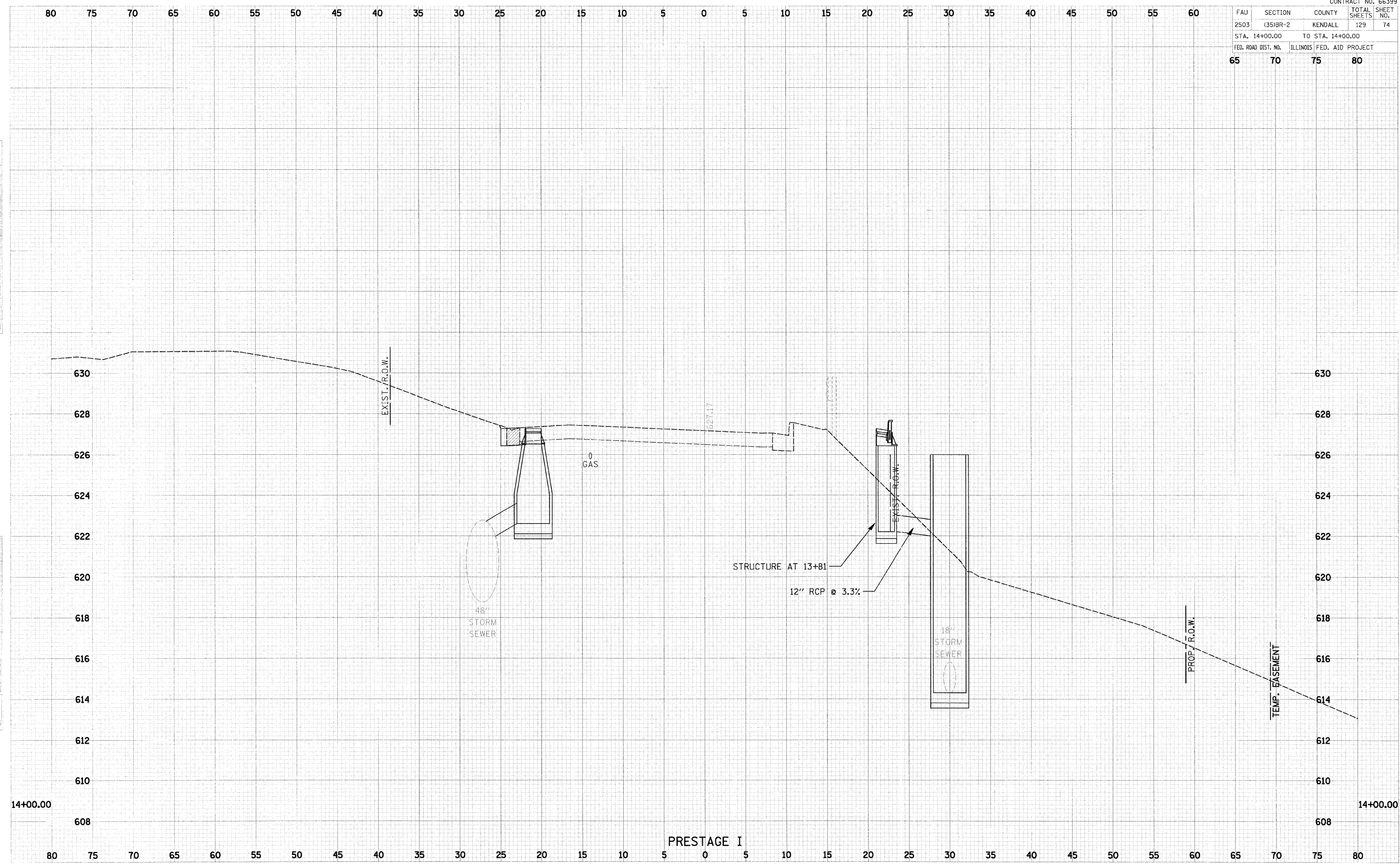

PRESTAGE I