

F.A.P. RTE.	SECTION	COUNTY	TOTAL SHEETS	SHEET NO.
310	(39B)1	McDONOUGH	38	5
STA. TO STA.		ILLINOIS FED. AID PROJECT		

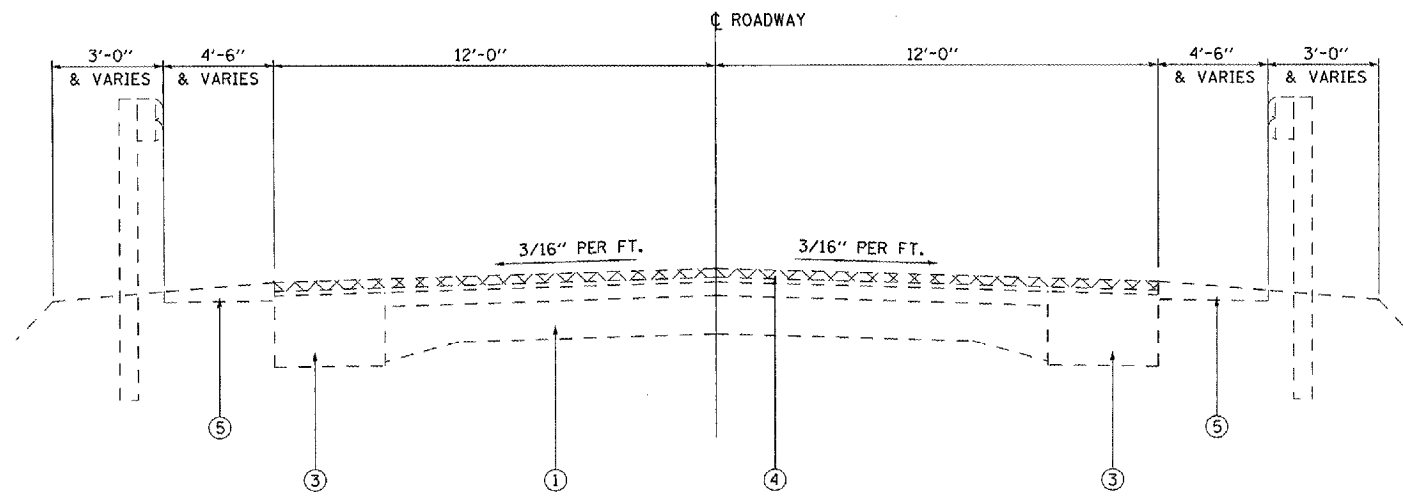

**EXISTING TYPICAL SECTION 1**

STA. 85+20 TO STA. 87+59.08  
STA. 88+74.92 TO STA. 91+40

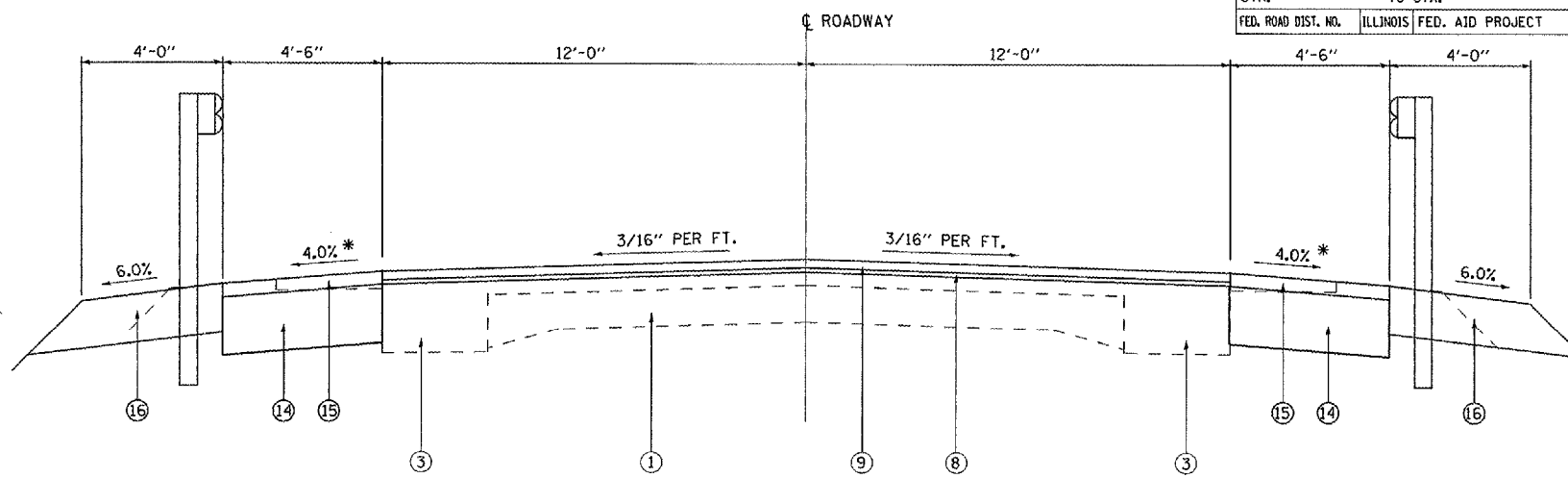

**PROPOSED TYPICAL SECTION 1**

STA. 85+20 TO STA. 87+59.08  
STA. 88+74.92 TO STA. 91+40

\* 4 % SLOPE ON SHOULDERS SHALL TRANSITION TO 1.5 % SLOPE PRIOR TO BRIDGE APPROACHES

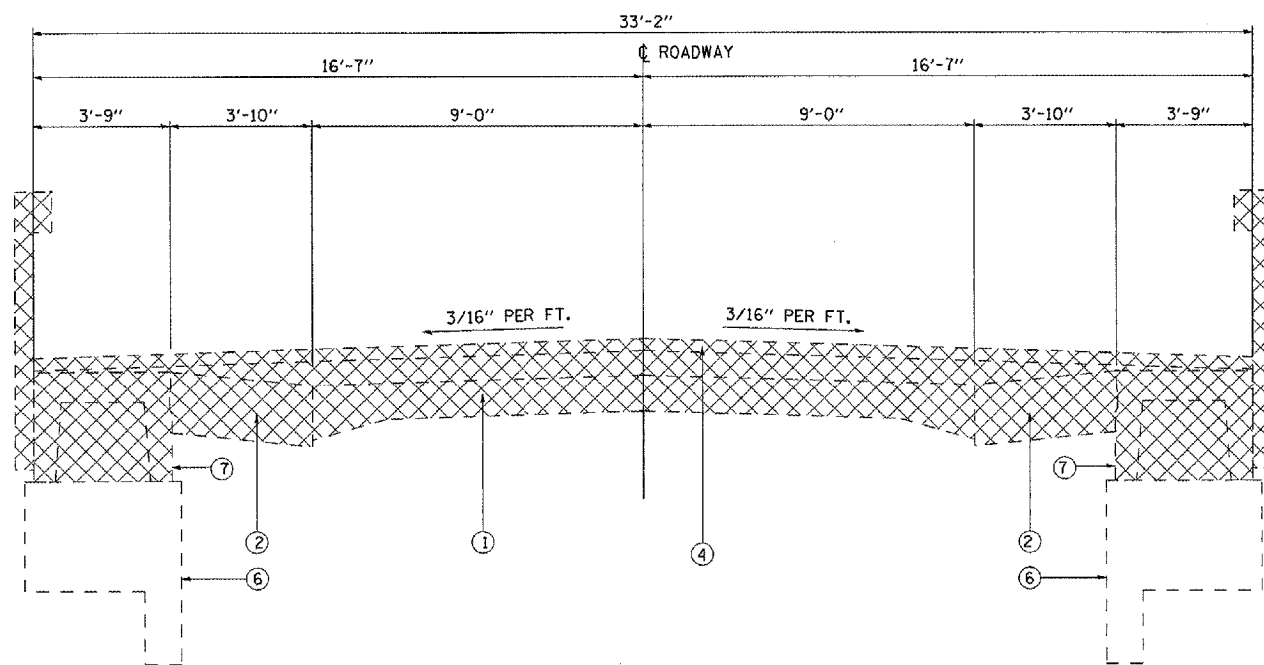

**EXISTING TYPICAL SECTION 2**

STA. 87+59.08 TO STA. 87+79  
STA. 88+55 TO STA. 88+74.92

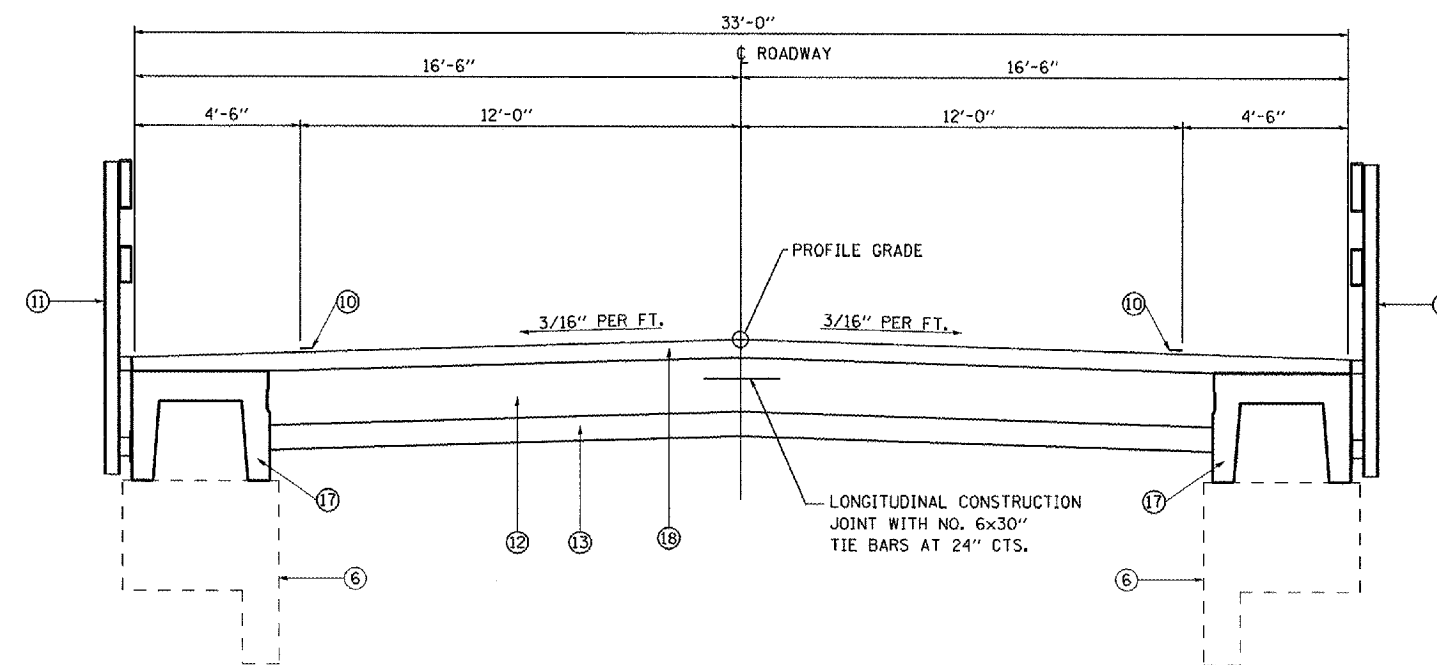

**PROPOSED TYPICAL SECTION 2**

STA. 87+59.08 TO STA. 87+79  
STA. 88+55 TO STA. 88+74.92

**LEGEND**

- |                                                                    |                                                      |
|--------------------------------------------------------------------|------------------------------------------------------|
| ① EX P.C.C. PAVEMENT, 9" - 6" - 9"                                 | ⑩ PR PAINT PAVT MK, LINE 4" (STRIPE FOR 12'-0")      |
| ② EX P.C.C. PAVEMENT, 10"                                          | ⑪ PR STEEL RAILING, TYPE SM                          |
| ③ EX BIT. CONC. BASE COURSE WIDENING, 10"                          | ⑫ PR PCC BASE COURSE 9"                              |
| ④ EX BIT. CONC. SURFACE                                            | ⑬ PR SUBBASE GRANULAR MATERIAL TYPE A, 4" AND VARIES |
| ⑤ EX AGG. SHOULDERS                                                | ⑭ PR HOT-MIX ASPHALT BASE CSE/WIDENING 10"           |
| ⑥ EX APPROACH CAPS (AT ENDS ONLY - NOT TO BE DISTURBED)            | ⑮ PR HOT-MIX ASPHALT SHOULDERS, 1 1/2" AND VARIES    |
| ⑦ EX PRECAST SHOULDER UNIT                                         | ⑯ PR GUARDRAIL AGGREGATE EROSION CONTROL             |
| ⑧ PR POLYMERIZED LEVELING BINDER (MACHINE METHOD), N50 (MIN. 3/4") | ⑰ PR PRECAST CONCRETE BRIDGE SLAB                    |
| ⑨ PR HOT-MIX ASPHALT SURF. CSE, MIX "D", N50 (1 1/2")              | ⑱ PR CONCRETE WEARING SURFACE, 5"                    |



REMOVAL

REVISIONS	
NAME	DATE

ILLINOIS DEPARTMENT OF TRANSPORTATION

TYPICAL SECTIONS  
US 67 OVER TROUBLESOME CREEK  
FAP 310 SECTION (39B)1  
McDONOUGH COUNTY

SCALE: VERT. NTS  
HORIZ. NTS  
DATE DEC 2007  
DRAWN BY AGG  
CHECKED BY MJS