

F.A.P. RTE.	SECTION	COUNTY	TOTAL SHEETS	SHEET NO.
310	(39B)	McDONOUGH	38	8
STA.		TO STA.		
FED. ROAD DIST. NO.		ILLINOIS FED. AID PROJECT		

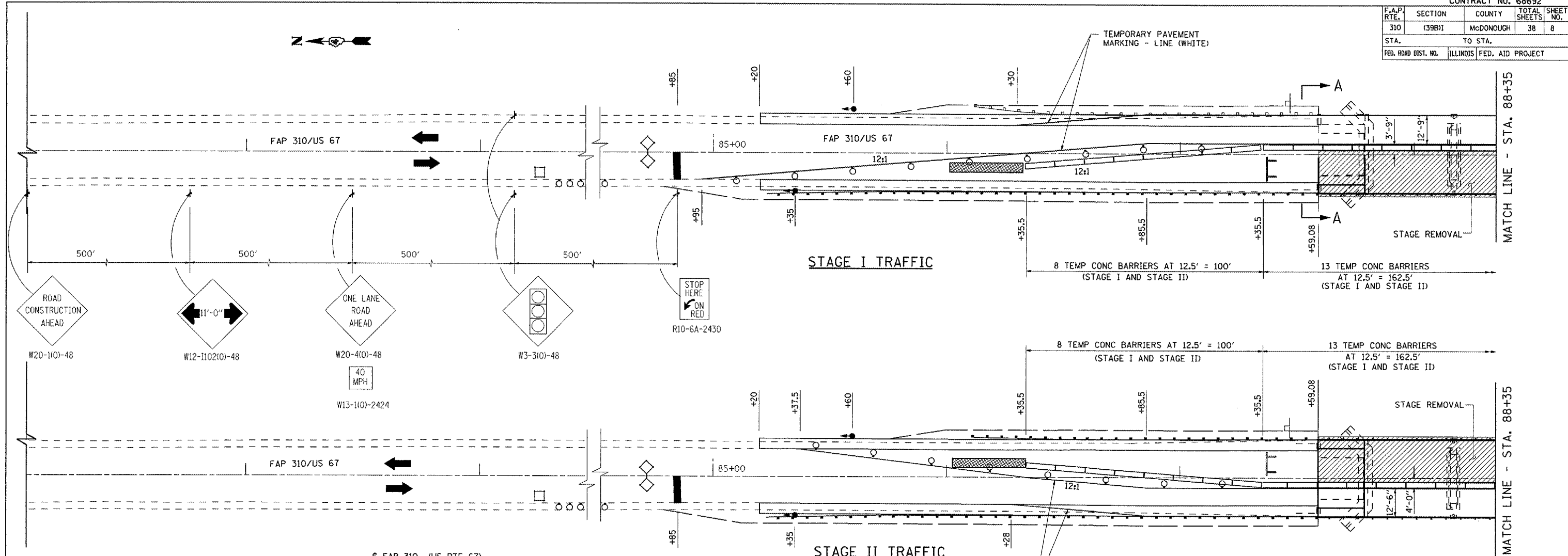

SUGGESTED STAGE CONSTRUCTION SEQUENCE

- STAGE I**
1. CONSTRUCT HMA BASE COURSE WIDENING STA. 85+20 TO STA. 87+59 AND STA. 88+75 TO 91+40 (STD 701326)
 2. ERECT TRAFFIC CONTROL FOR STAGE I.
 3. REMOVE EXISTING DECK RIGHT, @ STA. 88+17 AND EXISTING PAVEMENT RIGHT STA. 87+59.08 TO 87+79 AND STA. 88+55 TO 88+74.92.
 4. CONSTRUCT PROPOSED STAGE I PRECAST PRESTRESSED DECK @ STA. 88+17 AND PROPOSED PCC BASE CSE AND TEMPORARY RAMP AT ENDS OF PCC BASE CSE.
 5. CONSTRUCT PROPOSED GUARDRAIL & TERMINALS RIGHT STA. 85+22.19 TO STA. 90+61.82.
- STAGE II**
1. ERECT TRAFFIC CONTROL FOR STAGE II.
 2. REMOVE EXISTING DECK LEFT, @ STA. 88+17 AND EXISTING PAVEMENT LEFT STA. 87+59.08 TO 87+79 AND STA. 88+55 TO 88+74.92
 3. CONSTRUCT PROPOSED STAGE II PRECAST PRESTRESSED DECK @ STA. 88+17 AND PROPOSED PCC BASE CSE AND TEMPORARY RAMP AT ENDS OF PROPOSED PCC BASE CSE.
 4. CONSTRUCT PROPOSED GUARDRAIL & TERMINALS LEFT. STA. 86+09.69 TO STA. 91+36.82
- FINAL**
1. REMOVE ALL STAGE TRAFFIC CONTROL AND RE-ESTABLISH NORMAL TRAFFIC PATTERNS.
 2. COMPLETE HOT MIX ASPHALT SURFACE REMOVAL, HMA SHOULDERS 2", BINDER AND SURFACE COURSE UNDER TRAFFIC WITH FLAGGERS (STD 701201).
 3. FINAL STRIPING, SEEDING AND MISCELLANEOUS CLEANUP.

GENERAL NOTES

1. THIS TRAFFIC CONTROL DETAIL SHALL BE USED IN CONJUNCTION WITH STANDARD 701321.
2. EXISTING PAVEMENT MARKING THAT CONFLICT WITH THE REVISED STAGE TRAFFIC PATTERNS DURING ALL PHASES OF STAGE CONSTRUCTION SHALL BE REMOVED.
3. THE CONTRACTOR SHALL MAINTAIN ACCESS TO ALL PRIVATE AND COMMERCIAL PROPERTIES DURING ALL PHASES OF CONSTRUCTION.
4. EACH DETECTOR LOOP SHALL BE CONNECTED TO A SEPARATE DETECTOR AMPLIFIER.
5. WIDTH RESTRICTION SIGNING SHALL BE INSTALLED ACCORDING TO THE SPECIAL PROVISION TITLED "WIDTH RESTRICTION SIGNING". TWO SETS OF SIGNS, INCLUDING SIGN ASSEMBLY A AND SIGN ASSEMBLY B, WILL BE REQUIRED.

WORK THIS SHEET WITH SHEET 9 OF 38

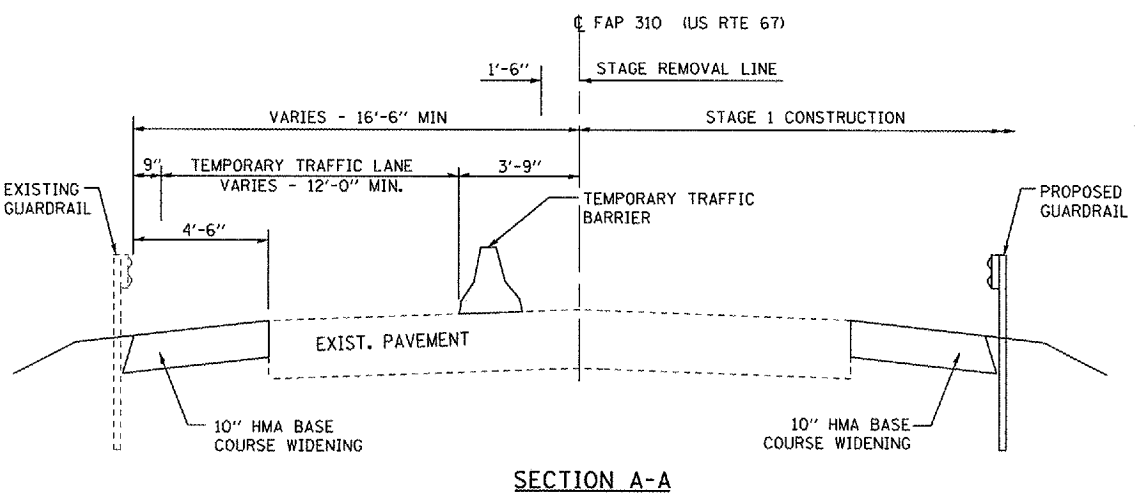
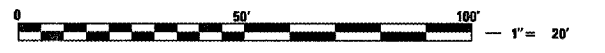

LEGEND

	WORK AREA		DRUM WITH STEADY BURNING LIGHT
	IMPACT ATTENUATOR		DOUBLE VERTICAL PANEL
	SIGN		TRAFFIC SIGNAL
	TYPE III BARRICADE		INDUCTION LOOP DETECTOR
			TEMPORARY CONCRETE BARRIER

TUG PROJ. # 3087023-01
 PLOT DATE = 1/22/2008 9:51:54 AM
 FILE NAME = P:\PROJECTS\68692\Drawings\TrafficControl\Sheet8.dwg

REVISIONS		ILLINOIS DEPARTMENT OF TRANSPORTATION
NAME	DATE	
		TRAFFIC CONTROL PLAN - STAGE I AND II US 67 OVER TROUBLESOME CREEK FAP 310 SECTION (39B)) McDONOUGH COUNTY SCALE: 1"=20' DATE DEC 2007

DRAWN BY GEW
CHECKED BY MJS