

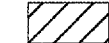





F.A.P. RTE.	SECTION	COUNTY	TOTAL SHEET SHEETS NO.
639	I123BII-2	MERCER	15 11
STA. 151+26.40 TO STA. 157+20.66			
FED. ROAD DIST. NO. 4 ILLINOIS		FED. AID PROJECT	

SYMBOLS

-  Work Area
-  Type II Barricade
-  Drum w/ steady burning light
-  Double Vertical Panels w/ steady-burning lights
-  Type C bidirectional reflector
-  Temporary Concrete Barrier
-  Impact Attenuator NRD TL3

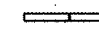

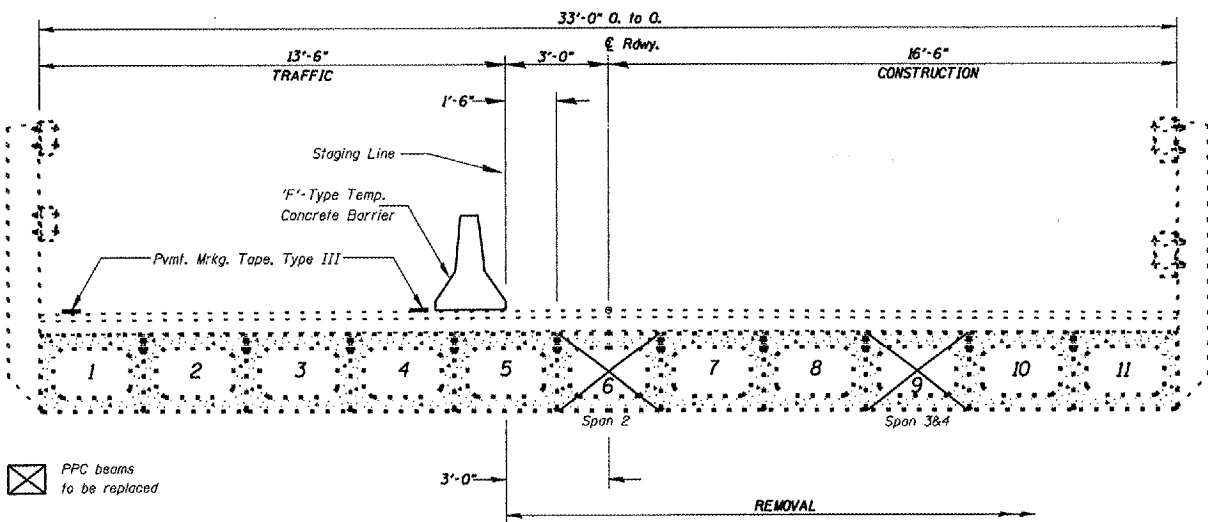
ELEVATION
(Looking East)

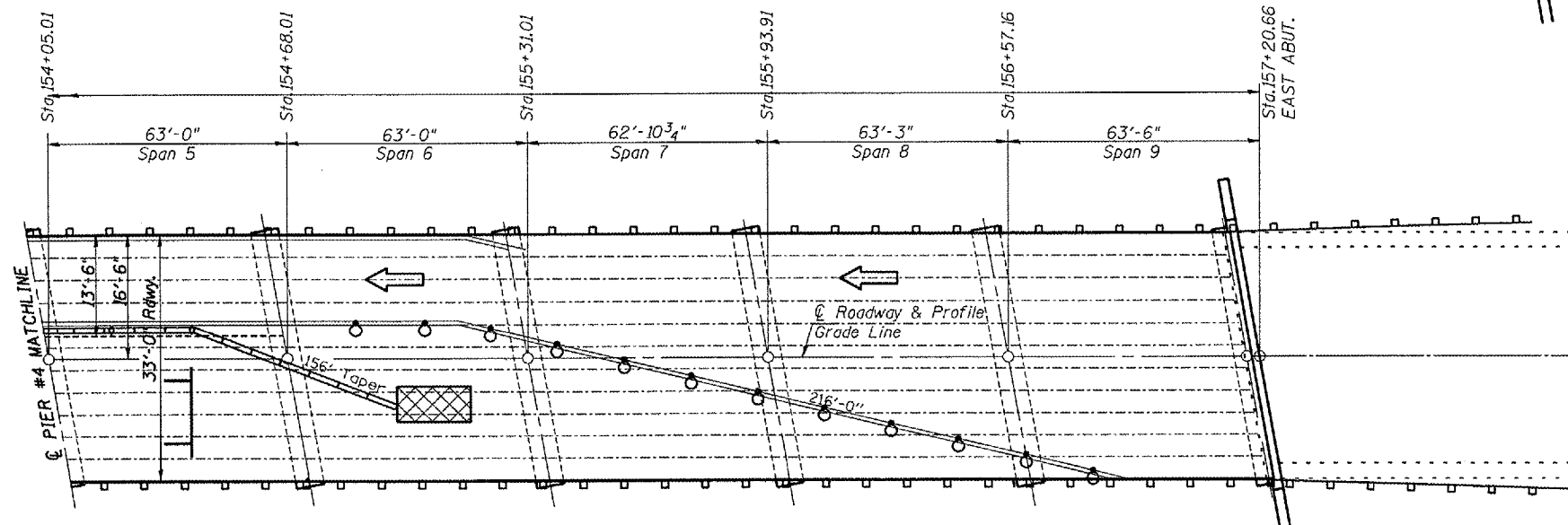
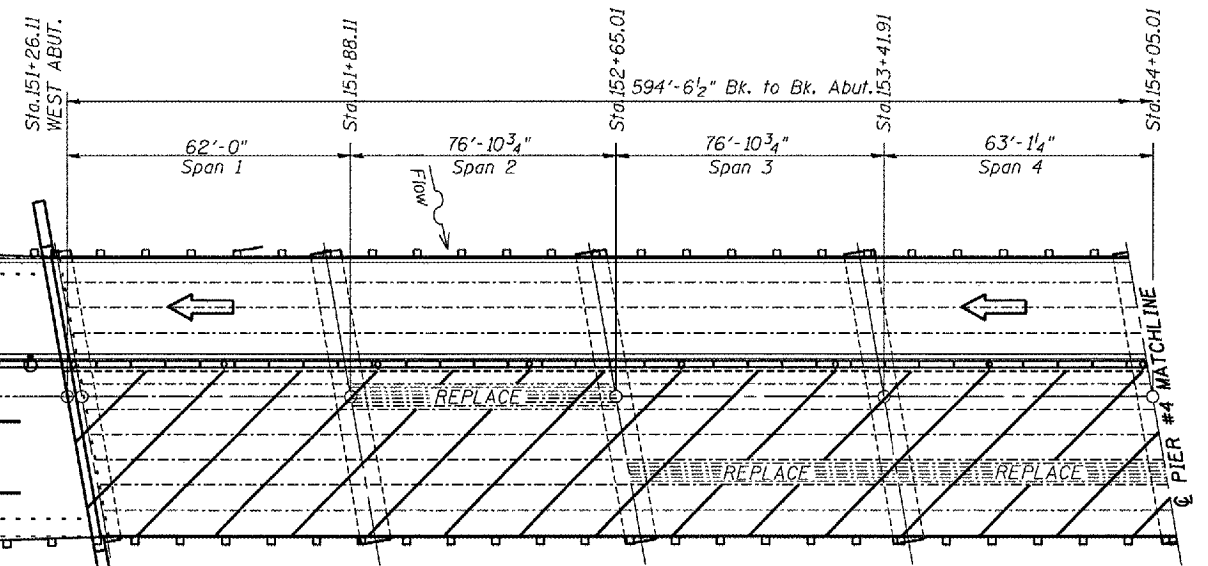

PLAN

NOTES
Refer to Highway Standard 701321 in conjunction with this sheet for exact placement of traffic management devices and other clarifications as construction staging symbols and dimensioning were duplicated off of this standard.
Barricades or Drums with bi-directional steady burn lights delineating the closed lane shall be placed in the work access opening during nonworking hours.

REVISIONS	
NAME	DATE

ILLINOIS DEPARTMENT OF TRANSPORTATION

TRAFFIC CONTROL

SCALE: VERT. HORIZ. DATE: 08-27-2007

DRAWN BY CEJ CHECKED BY

DATE: 08-24-07
SCALE: VERT. HORIZ. DATE: 08-27-2007
PROJECT: I123BII-2
DRAWN BY: CEJ
CHECKED BY: [blank]
APPROVED BY: [blank]
PROJECT: I123BII-2
DRAWN BY: CEJ
CHECKED BY: [blank]
APPROVED BY: [blank]