

STAGING

STAGE 1

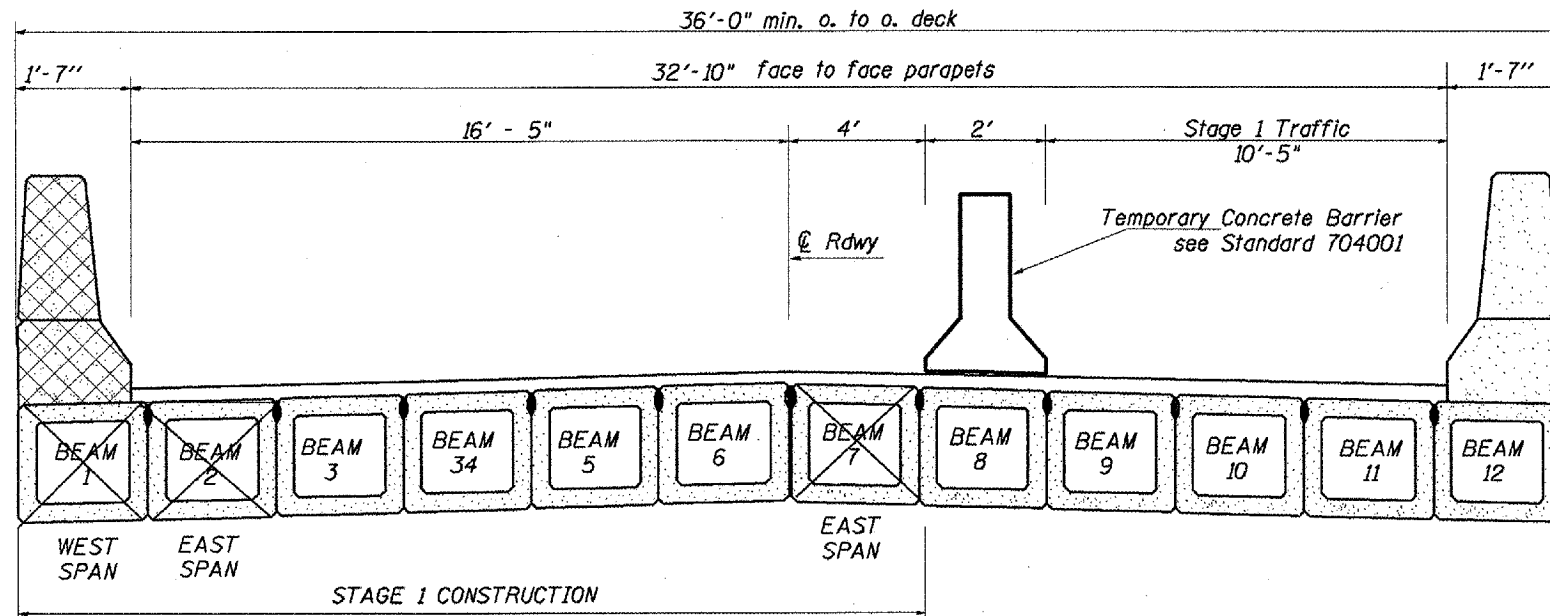

STAGE 2

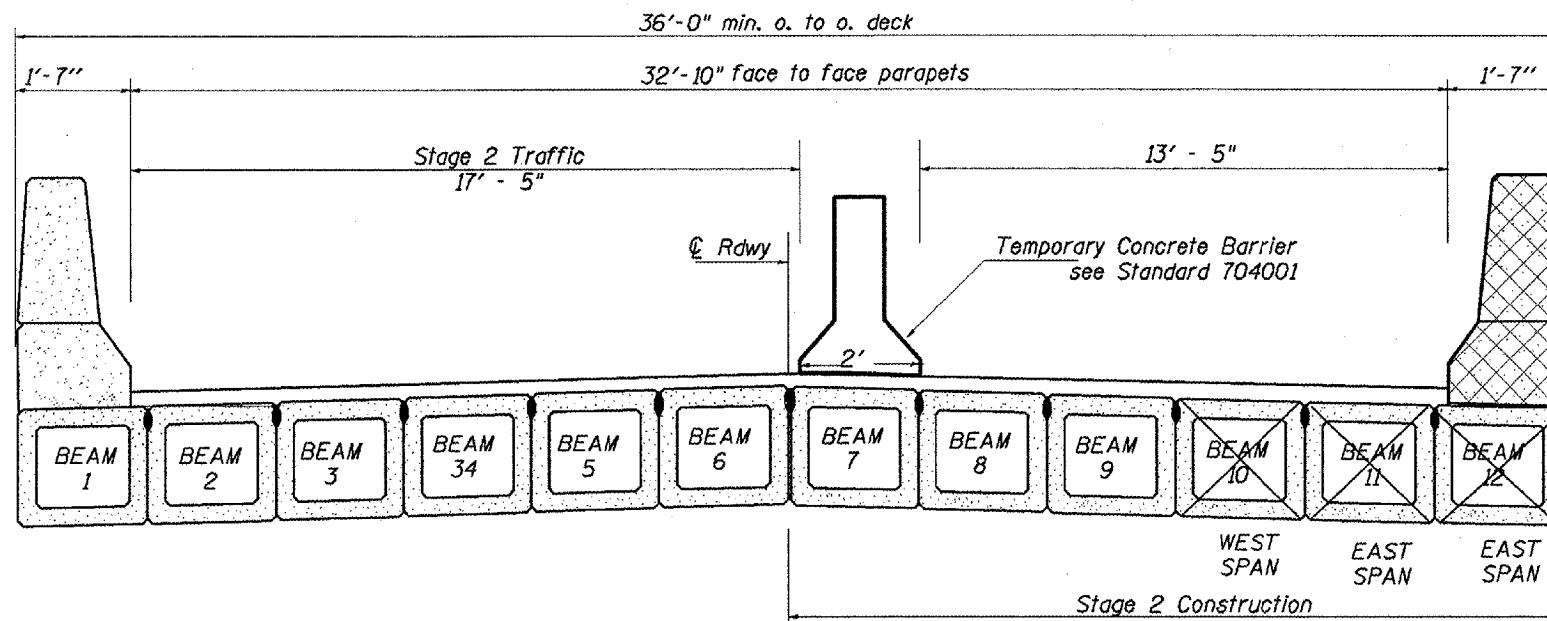

NOTE:

Five W12-I103 signs, as described in the width restriction signing Special Provisions, will be required. Two signs shall be placed at the intersection of US 34 and IL 164. Three signs shall be placed at the intersection of IL 94 and IL 164. Two sign assembly A's containing W12-I101 and W12-I102 signs as described in the width restriction signing Special Provision are also required. One shall be placed between Oquawka and the project and one between Gladstone and Oquawka. These signs shall be located at the direction of the Engineer. The costs shall be included with the cost of the TRAFFIC CONTROL AND PROTECTION STANDARD 701321.

Refer to Highway Standard 701321

High intensity flashing lights shall be placed on the RCA signs as directed by the Engineer.

The cost for all material, labor & equipment required to remove and reinstall the guardrail end section attached to the concrete parapet at Beam #1 and Beam #12 shall be included in the cost of Concrete Superstructure.