

EXIST. CURVE 1
 PI STA. = 61+30.10
 $\Delta = 44^\circ 00' 00''$ (RT)
 D = 5° 41' 59"
 R = 1,005.26'
 T = 406.15'
 L = 771.98'
 E = 78.95'
 e = -----
 T.R. = -----
 S.E. RUN = -----
 P.C. STA. = 57+23.95
 P.T. STA. = 64+95.93

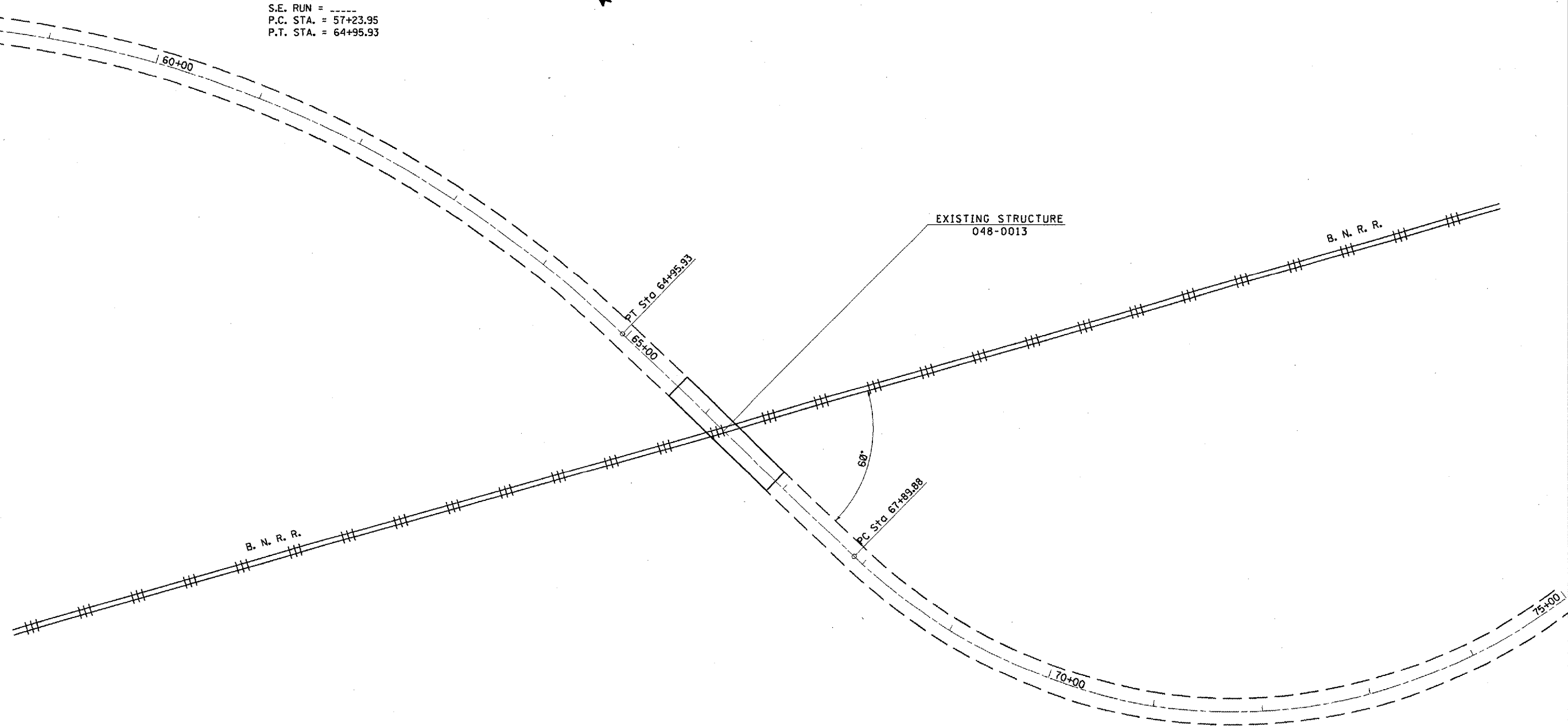

PC Sta 57+23.95



EXIST. CURVE 2
 PI STA. = 73+14.25
 $\Delta = 92^\circ 40' 00''$ (LT)
 D = 11° 26' 50"
 R = 500.52'
 T = 524.37'
 L = 809.50'
 E = 224.38'
 e = -----
 T.R. = -----
 S.E. RUN = -----
 P.C. STA. = 67+89.88
 P.T. STA. = 75+99.38

FILE NAME =
 c:\projects\us15\bridge\plan21.dgn

USER NAME = mofadden,jk	DESIGNED -	REVISED -
	DRAWN -	REVISED -
PLOT SCALE = 126.8888' / IN.	CHECKED -	REVISED -

STATE OF ILLINOIS
 DEPARTMENT OF TRANSPORTATION

PLAN VIEW

F.A.S. RTE.	SECTION	COUNTY	TOTAL SHEETS	SHEET NO.
2401	(40V)I-1	KNOX	13	9
			CONTRACT NO. 68780	