

F.A.S. RTE.	SECTION	COUNTY	TOTAL SHEETS	SHEET NO.
1517	D5 BEAM REPLACE 2008-2	PIATT	18	1
FED. ROAD DIST. NO.		ILLINOIS	CONTRACT NO. 70699	

STATE OF ILLINOIS
DEPARTMENT OF TRANSPORTATION
DIVISION OF HIGHWAYS

PROPOSED HIGHWAY PLANS

FAS ROUTE 1517 (US 150)
SECTION D5 BEAM REPLACE 2008-2
PIATT COUNTY

C-95-078-07

BRIDGE REPAIR

SOUTH BRANCH OF SALT CREEK 1.0 MILE EAST OF FARMER CITY

FOR INDEX OF SHEETS, SEE SHEET NO. 2
FOR SUMMARY OF QUANTITIES, SEE SHEET NO. 4

CURRENT ADT = 1,550 (2007) US 150

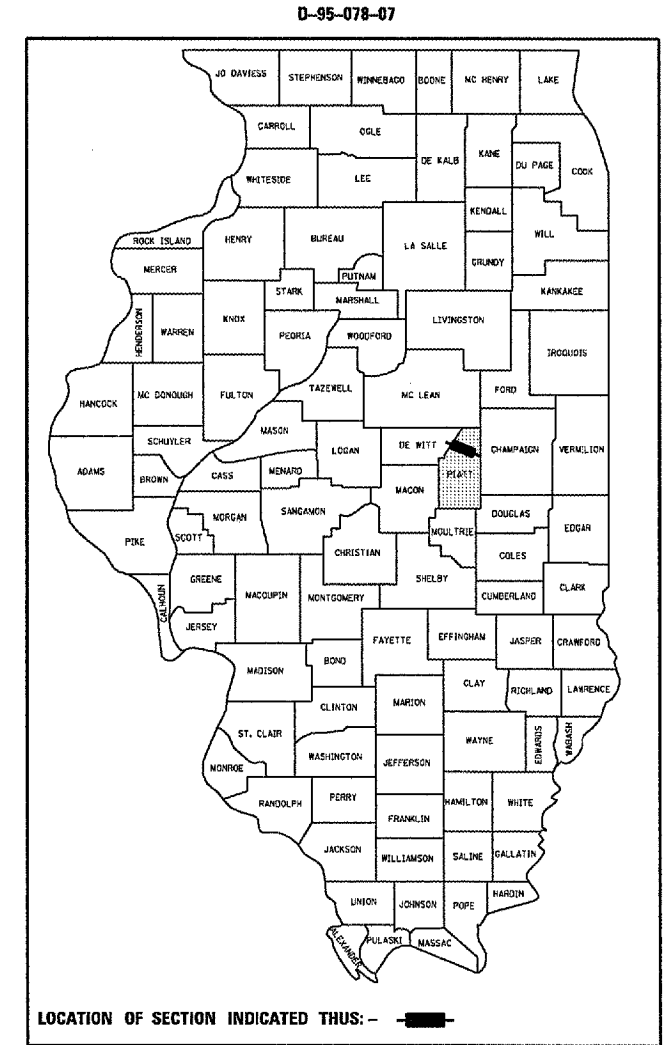

S. N. 074-0008
STATION 5+25.00

BEAM REPLACEMENT (NORTH BEAMS 1 THRU 4)
FROM STATION 4+89.42 TO STATION 5+60.59

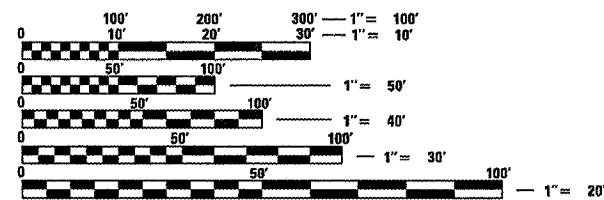

FULL SIZE PLANS HAVE BEEN PREPARED USING STANDARD ENGINEERING SCALES. REDUCED SIZED PLANS WILL NOT CONFORM TO STANDARD SCALES. IN MAKING MEASUREMENTS ON REDUCED PLANS, THE ABOVE SCALES MAY BE USED.

J.U.L.I.E.
JOINT UTILITY LOCATION INFORMATION FOR EXCAVATION
1-800-892-0123
OR 811

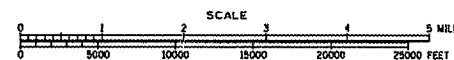
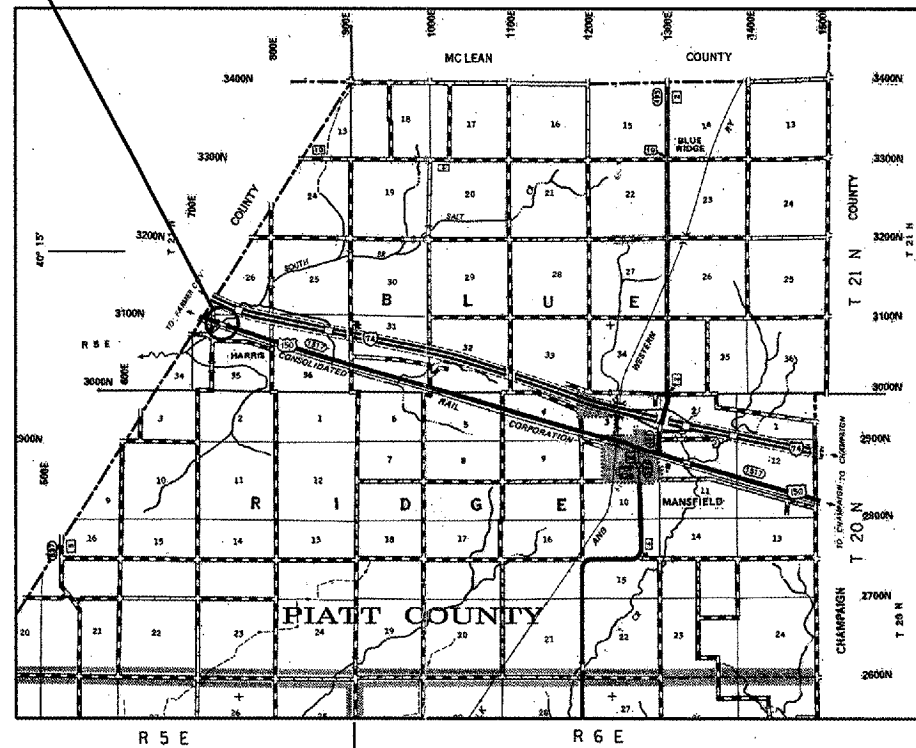

TOTAL LENGTH OF SECTION = 71.17 FEET = 0.0135 MILES
NET LENGTH OF SECTION = 71.17 FEET = 0.0135 MILES

PROJECT ENGINEER: NANCY FASIG
PROJECT MANAGER: TODD BLACK

CONTRACT NO. 70699

STATE OF ILLINOIS
DEPARTMENT OF TRANSPORTATION
DIVISION OF HIGHWAYS

SUBMITTED FEB 5 20 08

[Signature]
DEPUTY DIRECTOR OF HIGHWAYS, REGION ENGINEER

March 21, 20 08
[Signature]
INTERIM ENGINEER OF DESIGN AND ENVIRONMENT

March 21, 20 08
[Signature]
DIRECTOR OF HIGHWAYS, CHIEF ENGINEER

PRINTED BY THE AUTHORITY
OF THE STATE OF ILLINOIS