

Bench Mark: Top of ROW marker SW corner of intersection with Knollwood Road. Elev. 573.01.

Existing Structure: S.N. 084-0025 built 1959 as F.A.I. Route 55 (Service Road), Section 84-2B-1 at Station 291+20.00. Structure consists of 3 span continuous steel WF beams with reinforced concrete deck supported by spill thru abutments and hammerhead piers. 150'-0 1/4" back-to-back abutments. 30'-8" out-to-out deck. Concrete deck to be removed and replaced. Road to be closed and traffic detoured during construction.

No salvage

STATE OF ILLINOIS  
DEPARTMENT OF TRANSPORTATION

ROUTE NO.	SECTION	COUNTY	SHEETS	SHEET NO.
F.A.I. 55	84-2B-1	SANGAMON	31	10
FED. ROAD DIST. NO. 7		ILLINOIS	FED. AID PROJECT	

Contract #72349

INDEX OF SHEETS

1. General Plan
2. General Data
- 3.-4. Top of Slab Elevations
5. Superstructure
6. Superstructure Details
7. Diaphragm Details
8. Drainage Scupper, DS-II
9. Steel Railing, Type 2399
10. Structural Steel
11. Elastomeric Bearing Details
12. Concrete Removal
13. West Abutment
14. East Abutment

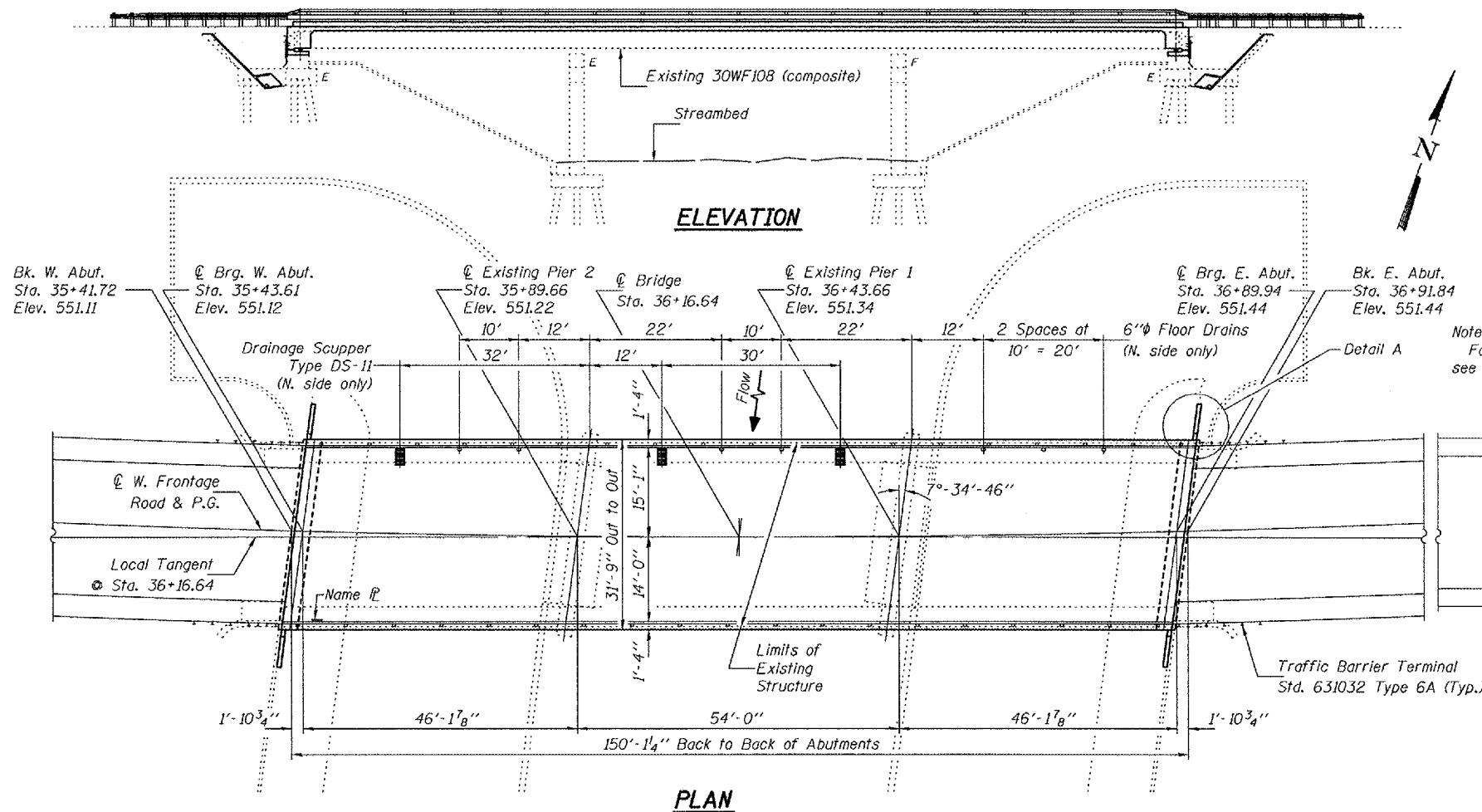

Note:  
For Detail A and Section Thru Abutment  
see sheet 4 of 14.

STATION 36+16.64  
REBUILT 20 BY  
STATE OF ILLINOIS  
F.A.I. ROUTE 55 - SECTION (84-2B-1) I-1  
LOADING HS20  
STRUCTURE NO. 084-0025

NAME PLATE

See Std. 515001  
Existing Name Plate shall be cleaned and  
relocated next to new Name Plate. Cost  
included with Name Plates.

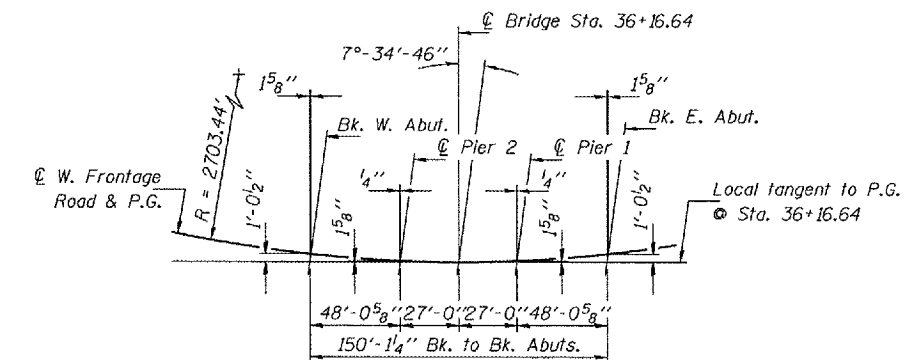

OFFSET SKETCH

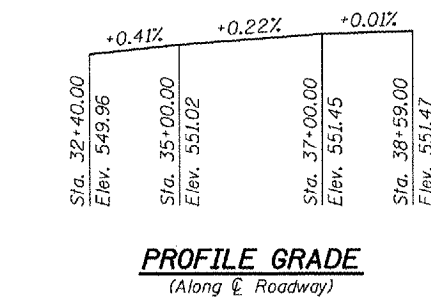

PROFILE GRADE

(Along @ Roadway)

DESIGNED *Tom K...*  
CHECKED *W.D. Collins*  
DRAWN *John F. Schneller Jr.*  
CHECKED *JLR P&C*

EXAMINED *Thomas...*  
PASSED *Ralph E. Anderson*

March 5, 2008

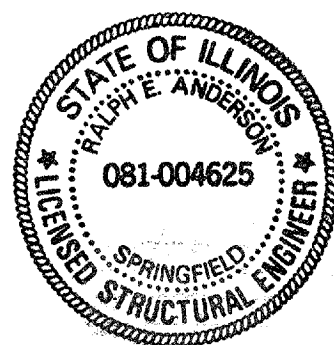

EXPIRES 11-30-2008

CURVE DATA

(@ of West Frontage Road)  
P.I. Sta. = 36+63.35  
 $\Delta = 5^{\circ}-18'-52.3''$   
 $D = 2^{\circ}-7'-9.7''$   
 $R = 2,703.44'$   
 $T = 125.47'$   
 $L = 250.76'$   
 $E = 2.91'$   
P.C. Sta. = 35+37.88  
P.C.C. Sta. = 37+88.64  
S.E. = 2.5%  
Attained from Sta. 32+20.25  
to Sta. 36+21.47

LOADING HS20-44

Allow 25 psf for future wearing surface.

DESIGN SPECIFICATIONS

2002 AASHTO

DESIGN STRESSES

FIELD UNITS (New Const.)  
 $f'_c = 3,500$  psi  
 $f_y = 60,000$  psi (reinforcement)

FIELD UNITS (Existing Const.)  
 $f_s = 18,000$  psi (steel)  
 $f_s = 20,000$  psi (rebar)  
 $f_c = 1,400$  psi (concrete)

SEISMIC DATA

Seismic Performance Category (SPC) = A  
Bedrock Acceleration Coefficient (A) = 4.8%g  
Site Coefficient (S) = 1.2

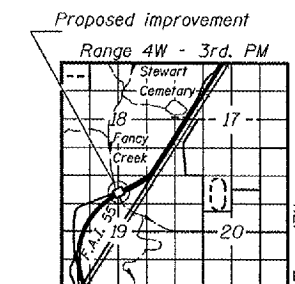

LOCATION SKETCH

GENERAL PLAN  
WEST FRONTAGE ROAD OVER  
FANCY CREEK  
F.A.I. ROUTE 55 - SEC. (84-2B-1) I-1  
SANGAMON COUNTY  
STATION 36+16.64  
STRUCTURE NO. 084-0025