

STATE OF ILLINOIS
 DEPARTMENT OF TRANSPORTATION
 DIVISION OF HIGHWAYS

**PROPOSED
 HIGHWAY PLANS**

FAP ROUTE 332 (IL. 1)
 SECTION D7 BEAM REPAIR 2008-2
 LAWRENCE COUNTY
 C-97-035-08

F.A.P. RTE.	SECTION	COUNTY	TOTAL SHEETS	SHEET NO.
322	D7 BEAM REPAIR 2008-2	LAWRENCE	11	1
FED. ROAD DIST. NO.	ILLINOIS	CONTRACT NO.	74290	

FOR INDEX OF SHEETS, SEE SHEET NO. 2

2007 ADT = 4150

PROJECT LOCATION:
 SECTION: D7 BEAM REPAIR 2008-2
 S.N. 051-0006
 STA. 13 + 85

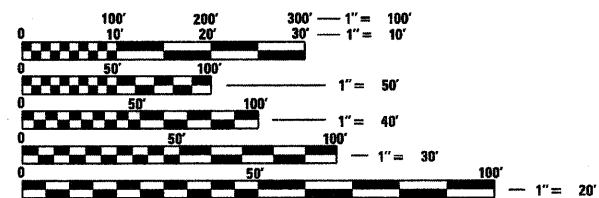

FULL SIZE PLANS HAVE BEEN PREPARED USING STANDARD ENGINEERING SCALES. REDUCED SIZED PLANS WILL NOT CONFORM TO STANDARD SCALES. IN MAKING MEASUREMENTS ON REDUCED PLANS, THE ABOVE SCALES MAY BE USED.

J.U.L.I.E.
 JOINT UTILITY LOCATION INFORMATION FOR EXCAVATION
 1-800-892-0123
 OR 811

TOWNSHIP: LAWRENCE

PROJECT ENGINEER: GARY WELTON
 PROJECT MANAGER: JENNIFER WENTHE

CONTRACT NO 74290

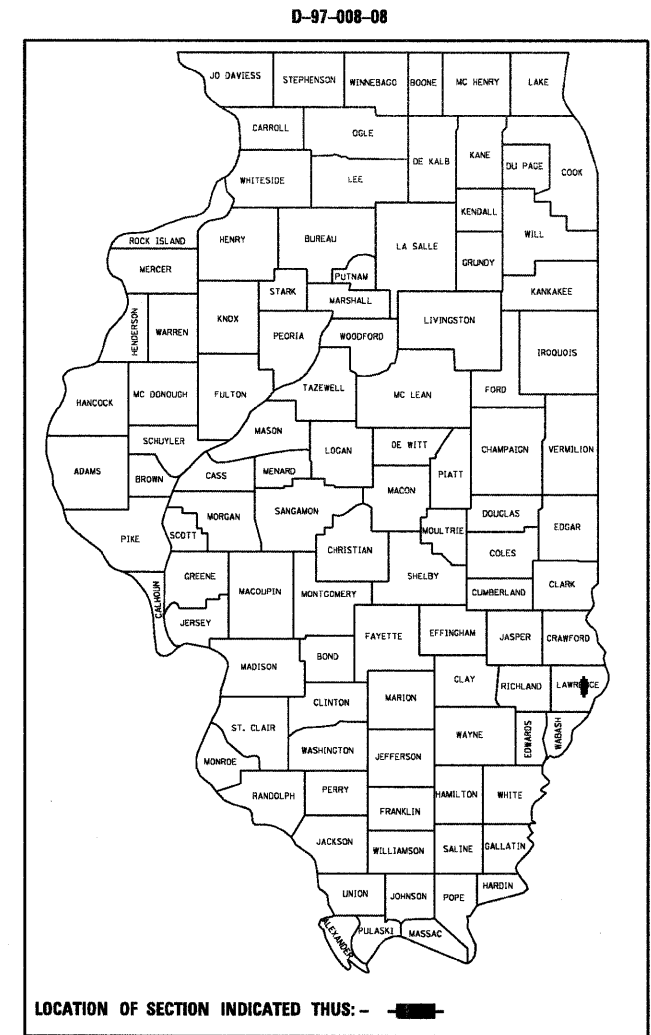
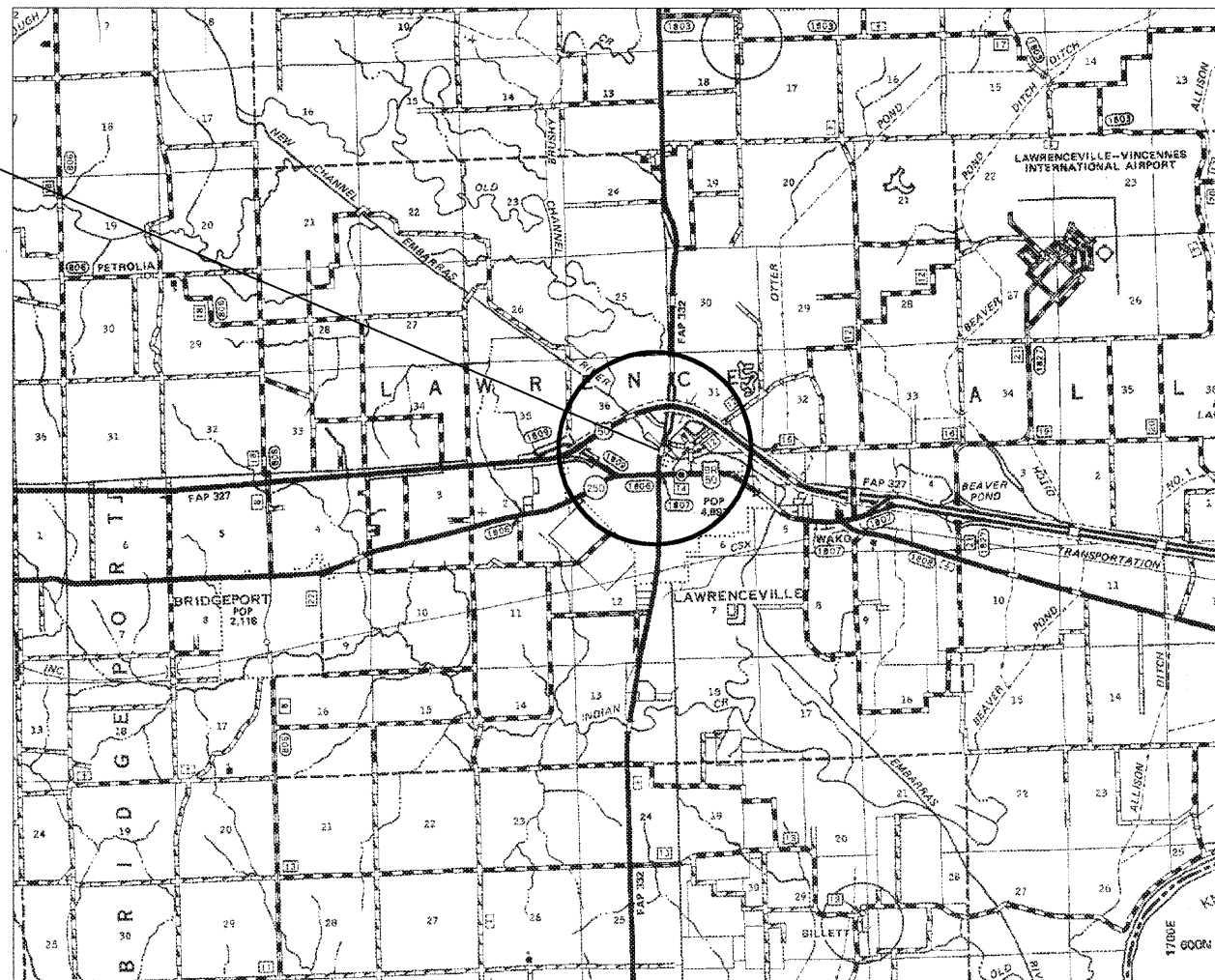

STATE OF ILLINOIS
 DEPARTMENT OF TRANSPORTATION
 DIVISION OF HIGHWAYS

SUBMITTED February 5 20 08

Christine M. Reed
 DEPUTY DIRECTOR OF HIGHWAYS, REGION ENGINEER

March 21, 20 08
Eric E. Harrel
 INTERIM ENGINEER OF DESIGN AND ENVIRONMENT

March 21, 20 08
Christine M. Reed
 DIRECTOR OF HIGHWAYS, CHIEF ENGINEER

**PRINTED BY THE AUTHORITY
 OF THE STATE OF ILLINOIS**