

DATE	
BY	
REVISIONS	
NO.	
DATE	
BY	
REVISIONS	
NO.	
DATE	
BY	
REVISIONS	
NO.	
DATE	
BY	
REVISIONS	
NO.	
DATE	
BY	
REVISIONS	
NO.	

DATE	
BY	
REVISIONS	
NO.	
DATE	
BY	
REVISIONS	
NO.	
DATE	
BY	
REVISIONS	
NO.	
DATE	
BY	
REVISIONS	
NO.	
DATE	
BY	
REVISIONS	
NO.	

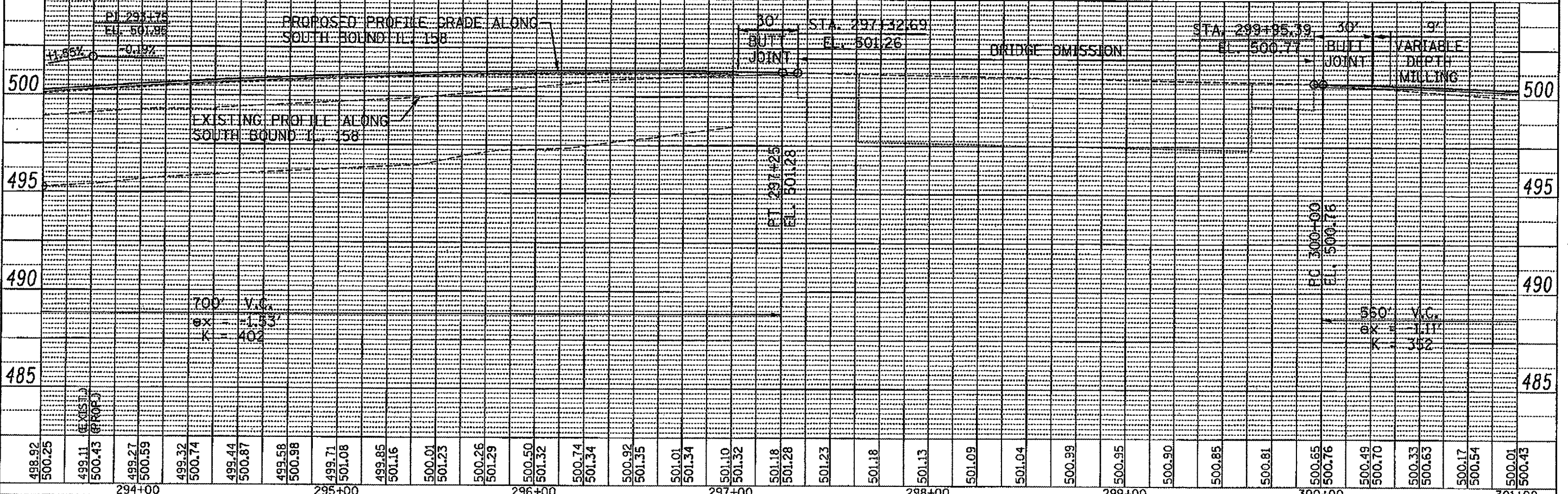
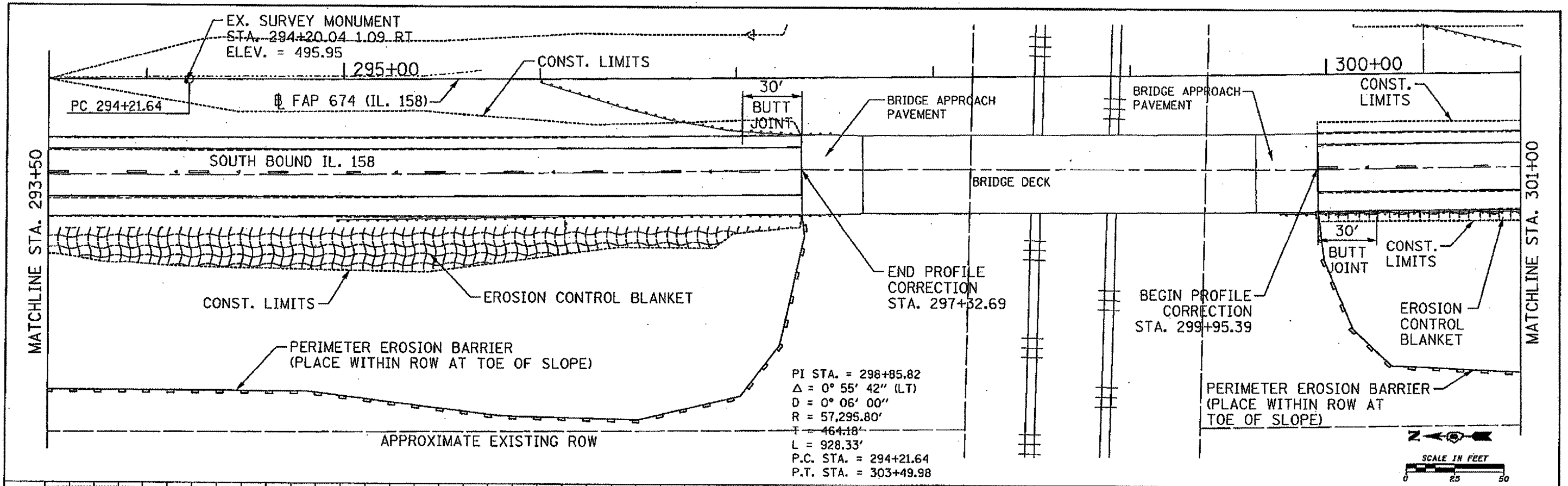

FILE NAME = C:\PF02.SBIL158.dgn	USER NAME = Jackson	DESIGNED - OHP	REVISED - 03/12/08	<b>STATE OF ILLINOIS</b> <b>DEPARTMENT OF TRANSPORTATION</b>	<b>PLAN &amp; PROFILE IL. 158 SOUTH BOUND</b>	SECTION 410, 410-1-1	COUNTY ST. CLAIR	TOTAL SHEETS 41	SHEET NO. 19				
PLOT SCALE = 25:1	CHECKED - SAR	REVISED -	SCALE:							SHEET NO. OF SHEETS	STA. TO STA.	FED. ROAD DIST. NO.	ILLINOIS FED. AID PROJECT
PLOT DATE = 3/13/2008	DATE = 01/30/08	REVISED -											