

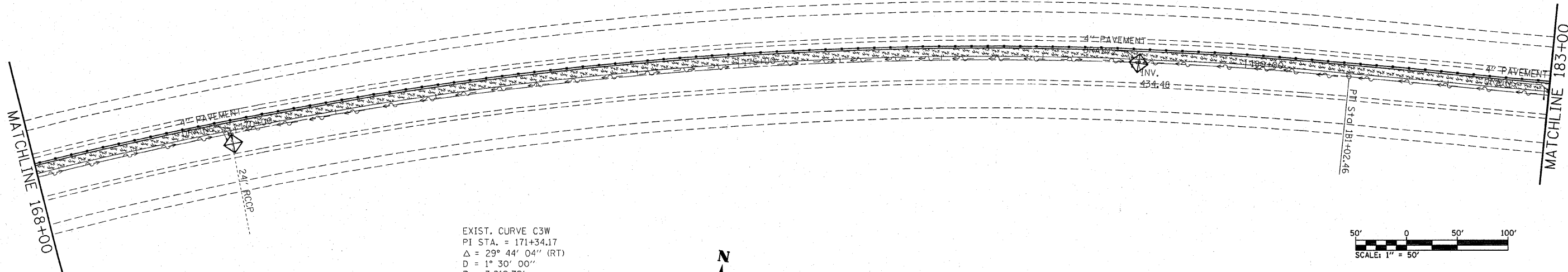

F.A.I. RTE.	SECTION	COUNTY	TOTAL SHEETS	SHEET NO.
270	60-(1,2,3,4,5)I	MADISON	46	33

STA. 156+52	TO STA. 183+00
FED. ROAD DIST. NO. ILLINOIS	FED. AID PROJECT

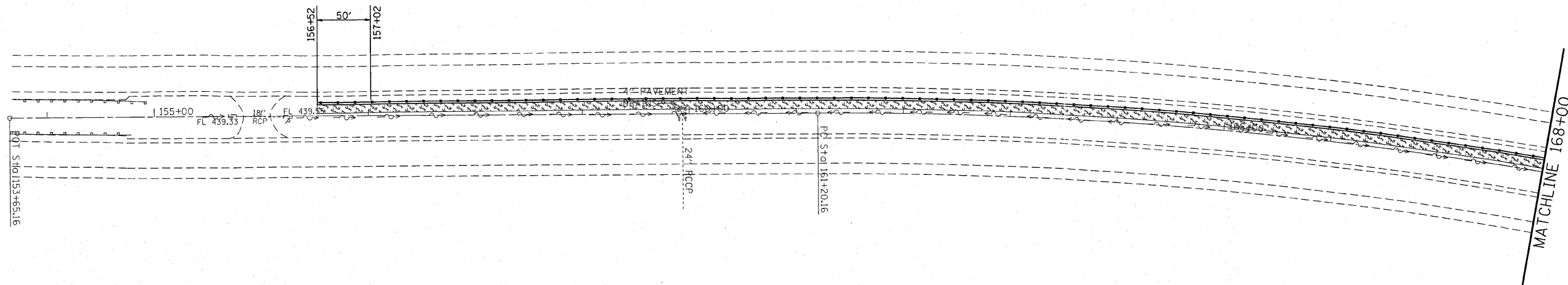

EXIST. CURVE C3W
 PI STA. = 171+34.17
 $\Delta = 29^\circ 44' 04''$ (RT)
 $D = 1^\circ 30' 00''$
 $R = 3,819.72'$
 $T = 1,014.01'$
 $L = 1,982.30'$
 $E = 132.30'$
 $\theta =$
 $T.R. =$
 $S.E. RUN =$
 $P.C. STA. = 161+20.16$
 $P.T. STA. = 181+02.46$

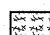

-  INLET AND PIPE PROTECTION
-  MULCH

REVISIONS	
NAME	DATE

ILLINOIS DEPARTMENT OF TRANSPORTATION
EROSION CONTROL PLAN
AREA#1
 FAI RTE 270
 SECTION 60-(1,2,3,4,5)I
 MADISON COUNTY

SCALE: VERT. _____
 HORIZ. _____

DRAWN BY _____
 CHECKED BY _____

PLOT DATE = 12/12/2007
 FILE NAME = s:\projects\685207\plan\eropl063207.dgn
 PLOT SCALE = 50.000000 / IN.
 REFERENCE = #REF#