

CONTRACT NO. 76B17			
F.A.I. RTE.	SECTION	COUNTY	TOTAL SHEETS
270	60-(1,2,3,4,5)I	MADISON	46
STA. 700+00	TO STA. 730+00		
ILLINOIS FED. AID PROJECT			

EXIST. CURVE CUR3
 PI STA. = 706+93.47
 $\Delta = 20^{\circ} 43' 53''$ (RT)
 $D = 1^{\circ} 30' 00''$
 $R = 3,819.72'$
 $T = 698.69'$
 $L = 1,382.09'$
 $E = 63.37'$
 $e =$ -----
 $T.R. =$ -----
 $S.E. RUN =$ -----
 $P.C. STA. = 699+94.78$
 $P.T. STA. = 713+76.87$

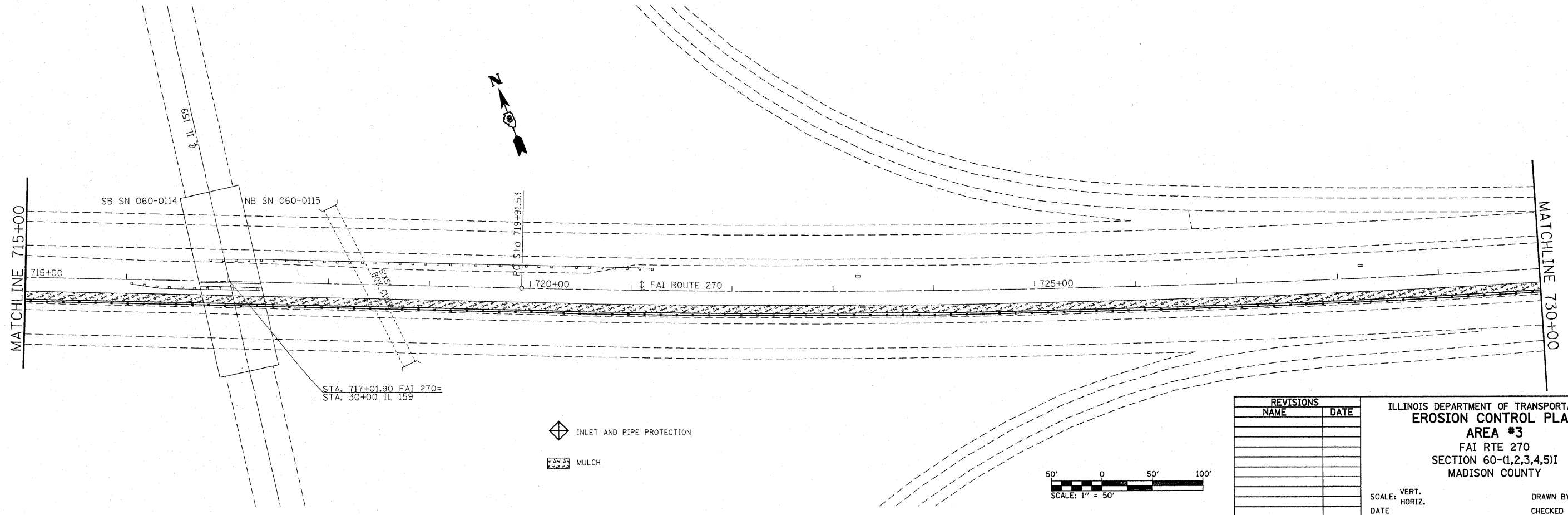
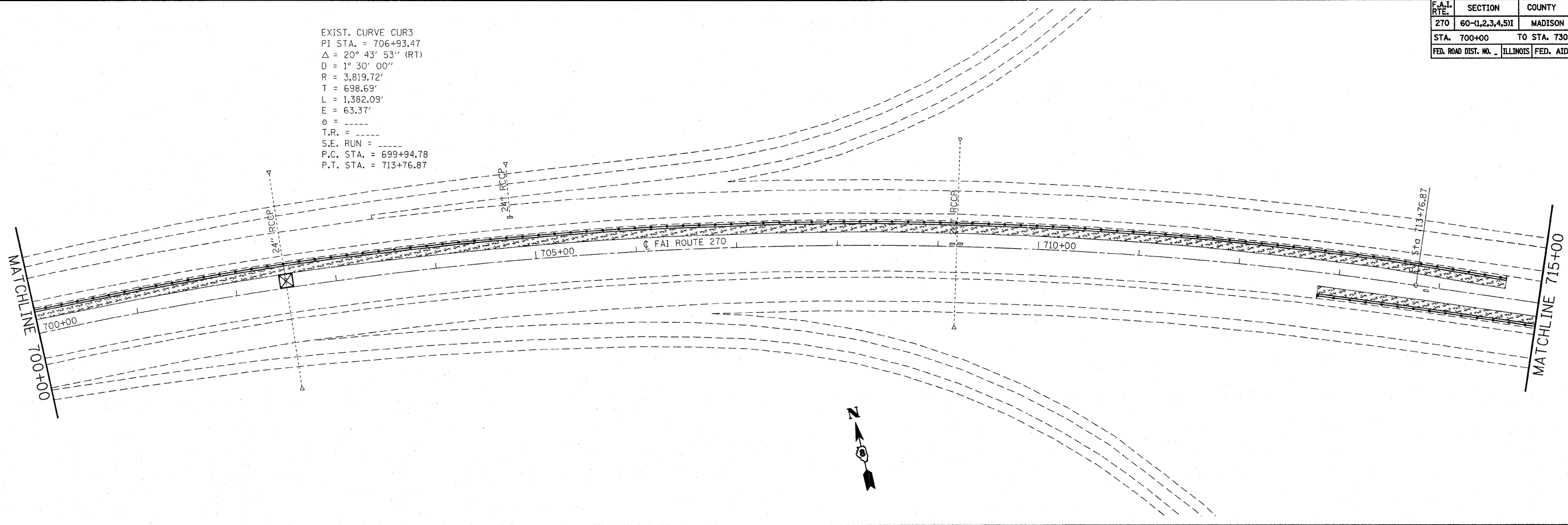
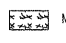

PLT DATE = 12/12/2007
 FILE NAME = c:\pcc\projects\76b17\plan\eroc\eroc207b.dgn
 PLOT SCALE = 5/8" = 1' IN.
 REFERENCE = #REF*

◆ INLET AND PIPE PROTECTION
 MULCH



REVISIONS	
NAME	DATE

ILLINOIS DEPARTMENT OF TRANSPORTATION
 EROSION CONTROL PLAN
 AREA #3
 FAI RTE 270
 SECTION 60-(1,2,3,4,5)I
 MADISON COUNTY

SCALE: VERT. _____
 HORIZ. _____
 DATE _____ DRAWN BY _____
 CHECKED BY _____