

F.A.I. RTE.	SECTION	COUNTY	TOTAL SHEETS	SHEET NO.
270	60-(1,2,3,4,5)I	MADISON	46	44

STA. 790+00 TO STA. 820+00

FED. ROAD DIST. NO. ILLINOIS FED. AID PROJECT

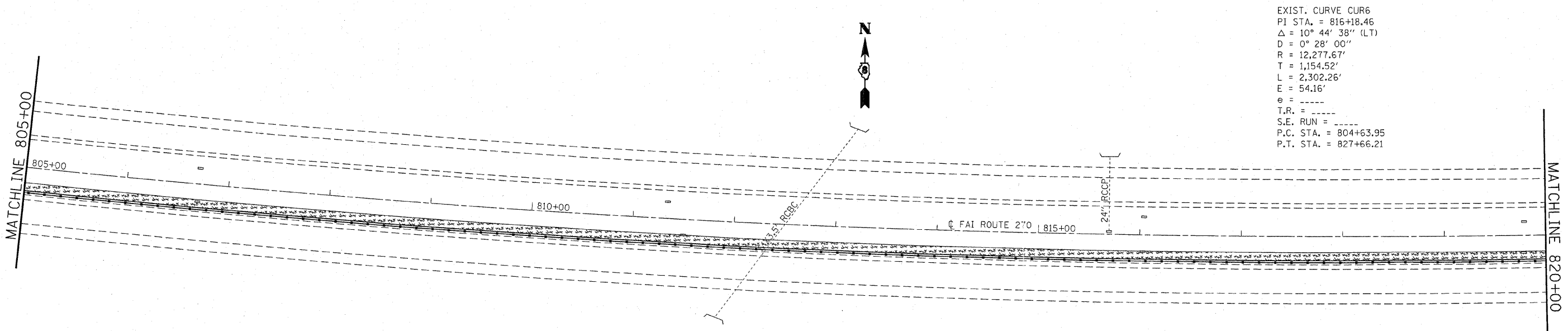
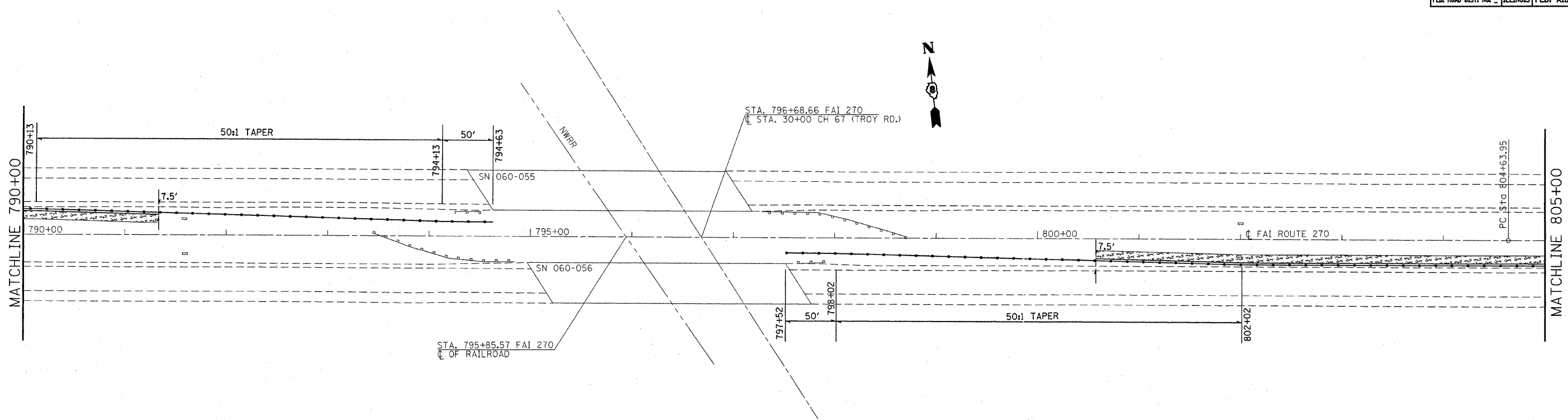

EXIST. CURVE CUR6  
 PI STA. = 816+18.46  
 $\Delta = 10^\circ 44' 38''$  (LT)  
 $D = 0^\circ 28' 00''$   
 $R = 12,277.67'$   
 $T = 1,154.52'$   
 $L = 2,302.26'$   
 $E = 54.16'$   
 $e = \text{-----}$   
 $T.R. = \text{-----}$   
 $S.E. \text{ RUN} = \text{-----}$   
 $P.C. \text{ STA.} = 804+63.95$   
 $P.T. \text{ STA.} = 827+66.21$

PLOT DATE = 12/12/2007  
 FILE NAME = c:\projects\erod\92076\plan\erod\92076b.dgn  
 PLOT SCALE = 50.00000' / IN.  
 REFERENCE = REF#

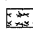
-  INLET AND PIPE PROTECTION
-  MULCH

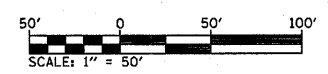

REVISIONS	
NAME	DATE

ILLINOIS DEPARTMENT OF TRANSPORTATION  
**EROSION CONTROL PLAN**  
**AREA #3**  
 FAI RTE 270  
 SECTION 60-(1,2,3,4,5)I  
 MADISON COUNTY

SCALE: VERT. \_\_\_\_\_  
 HORIZ. \_\_\_\_\_

DATE \_\_\_\_\_ DRAWN BY \_\_\_\_\_  
 CHECKED BY \_\_\_\_\_