

F.A.P. RTE.	SECTION	COUNTY	TOTAL SHEETS	SHEET NO.
2794	06-00109-00-WR	COOK	24	9
STA. 87+00		TO STA. 102+00		
FED. ROAD DIST. NO.	ILLINOIS	FED. AID PROJECT		

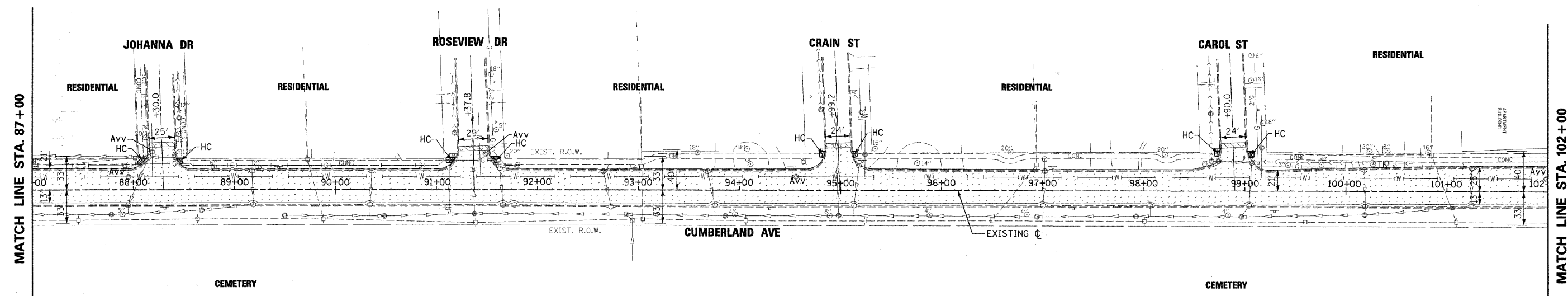

PLAN	SURVEYED	DATE
	PLOTTED	
	CHECKED	
	BY	
	NO.	

PROFILE	SURVEYED	DATE
	PLOTTED	
	CHECKED	
	BY	
	NO.	



LEGEND

	PROPOSED BUTT JOINT (HOT-MIX ASPHALT REMOVAL - BUTT JOINT)		PROPOSED PCC DRIVEWAY (DRIVEWAY PAVEMENT REMOVAL PCC DRIVEWAY PAVEMENT, 8')
	PROPOSED PAVEMENT RESURFACING (HOT-MIX ASPHALT SURFACE REMOVAL, 4" HOT-MIX ASPHALT SURFACE COURSE, MIX D, N70 HOT-MIX ASPHALT BINDER COURSE, IL-19, N70)		SIDEWALK REMOVAL
	PROPOSED PAVEMENT WIDENING (HOT-MIX ASPHALT SURFACE COURSE, MIX D, N70 HOT-MIX ASPHALT BINDER COURSE, IL-19, N70 HOT-MIX ASPHALT BASE COURSE SUB-BASE GRANULAR MATERIAL, TYPE B COMBINATION CONC. CURB & GUTTER, TYPE B-6.12)	Acb	CATCH BASIN TO BE ADJUSTED
		Amh	SANITARY/STORM MANHOLE TO BE ADJUSTED
		Avv	VALVE VAULT TO BE ADJUSTED
		HC	HANDICAP ACCESSIBLE RAMP WITH DETECTABLE WARNINGS

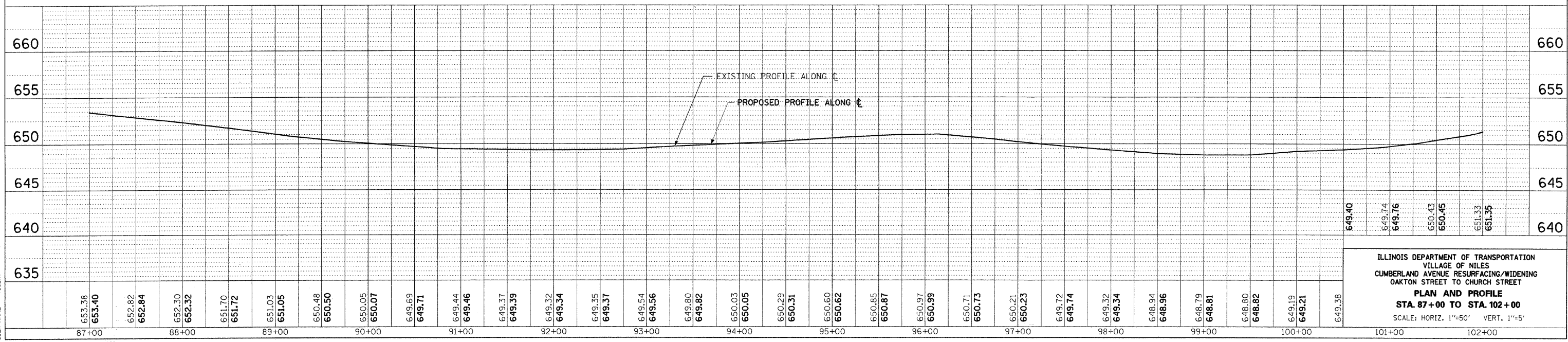

ILLINOIS DEPARTMENT OF TRANSPORTATION
VILLAGE OF NILES
CUMBERLAND AVENUE RESURFACING/WIDENING
OAKTON STREET TO CHURCH STREET
PLAN AND PROFILE
STA. 87+00 TO STA. 102+00
SCALE: HORIZ. 1"=50' VERT. 1"=5'

PLOT DATE = 1/29/2008
FILE NAME = 8662038
PLOT SCALE = 1"=50'
USER NAME = MUSERS