

F.A.U. RTE.	SECTION	COUNTY	TOTAL SHEETS	SHEET NO.
6761	04-00057-06-WR	TAZEWELL	154	26
STA. 13+00		TO STA. 25+00		
FED. ROAD DIST. NO. 4 ILLINOIS FED. AID PROJECT				

IRONWOOD DRIVE

REMOVAL LEGEND

-  ① PAVEMENT REMOVAL
-  ② CCC&G REMOVAL
-  ③ DRIVEWAY PAVEMENT REMOVAL

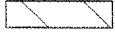
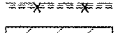
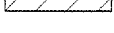
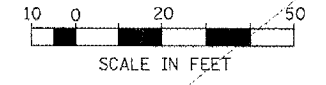
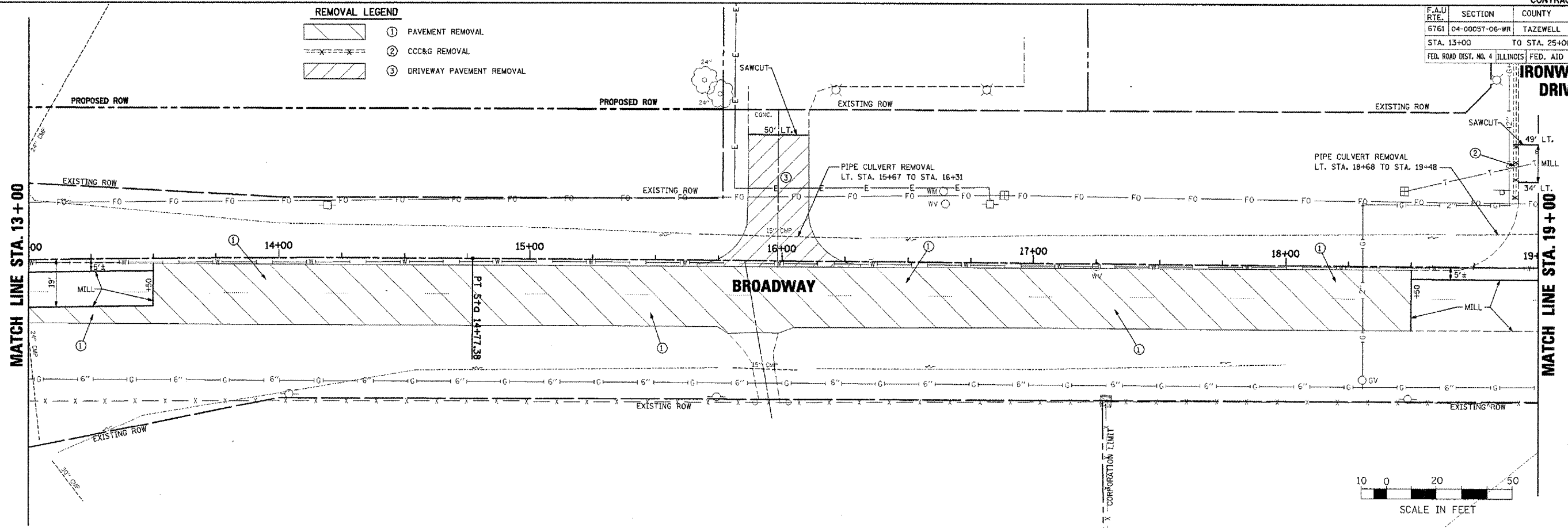

PLAN	DATE	BY
REVISION		
DATE		
BY		
NO.		

PROFILE	DATE	BY
REVISION		
DATE		
BY		
NO.		

PLOT DATE = 2/29/2008
 FILE NAME = I:\2008\08\87\plan\plans\BROADWAY-26-13-25.dgn
 USER NAME = BDT

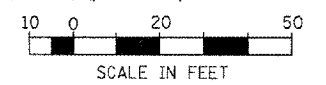
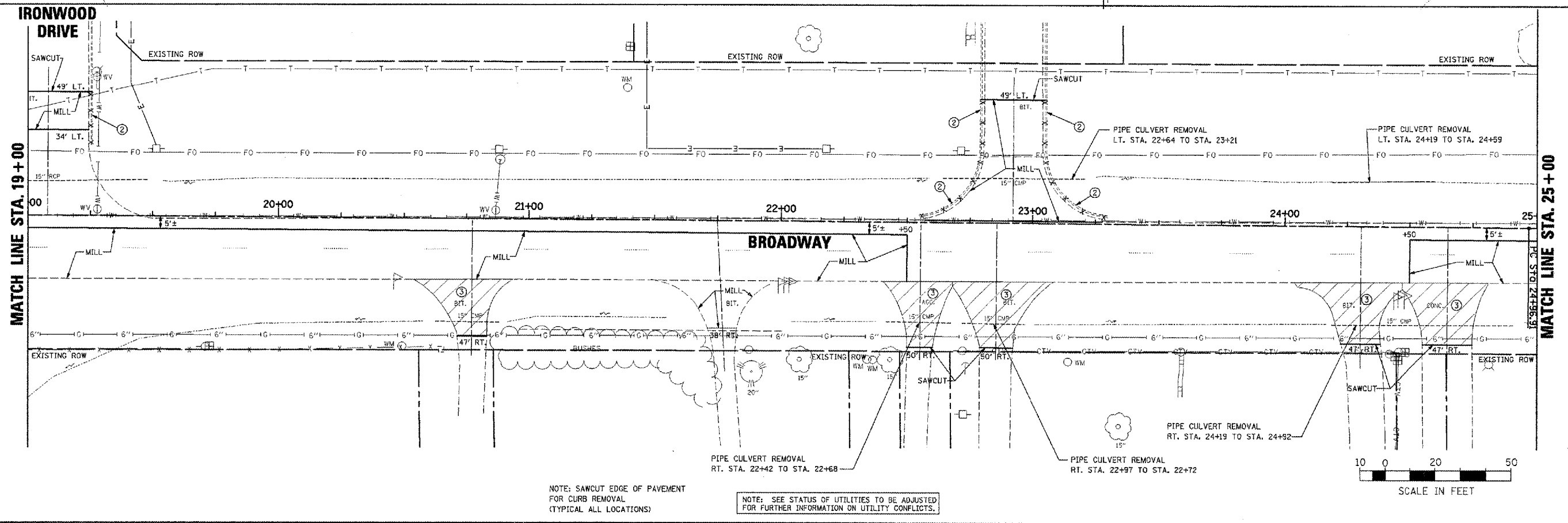

NOTE: SAWCUT EDGE OF PAVEMENT FOR CURB REMOVAL (TYPICAL ALL LOCATIONS)

NOTE: SEE STATUS OF UTILITIES TO BE ADJUSTED FOR FURTHER INFORMATION ON UTILITY CONFLICTS.

BROADWAY - REMOVAL PLANS - STA. 13+00 TO STA. 25+00