

CONTRACT NO. 89347				
F.A.U. RTE.	SECTION	COUNTY	TOTAL SHEETS	SHEET NO.
676L	04-00057-06-WR	TAZEWELL	154	133
STA. TO STA.				
FED. ROAD DIST. NO. 4 ILLINOIS FED. AID PROJECT				

DATE	
BY	
APPROVED	
DESIGNED	
PLOTTED	
INSTRUMENTED	
REVISIONS	
NO.	

DATE	
BY	
APPROVED	
DESIGNED	
PLOTTED	
INSTRUMENTED	
REVISIONS	
NO.	

PLOT DATE = 2/2/2008
 USER NAME = J. WOODRUFF
 PLOT SCALE = 1" = 20'
 USER NAME = J. WOODRUFF

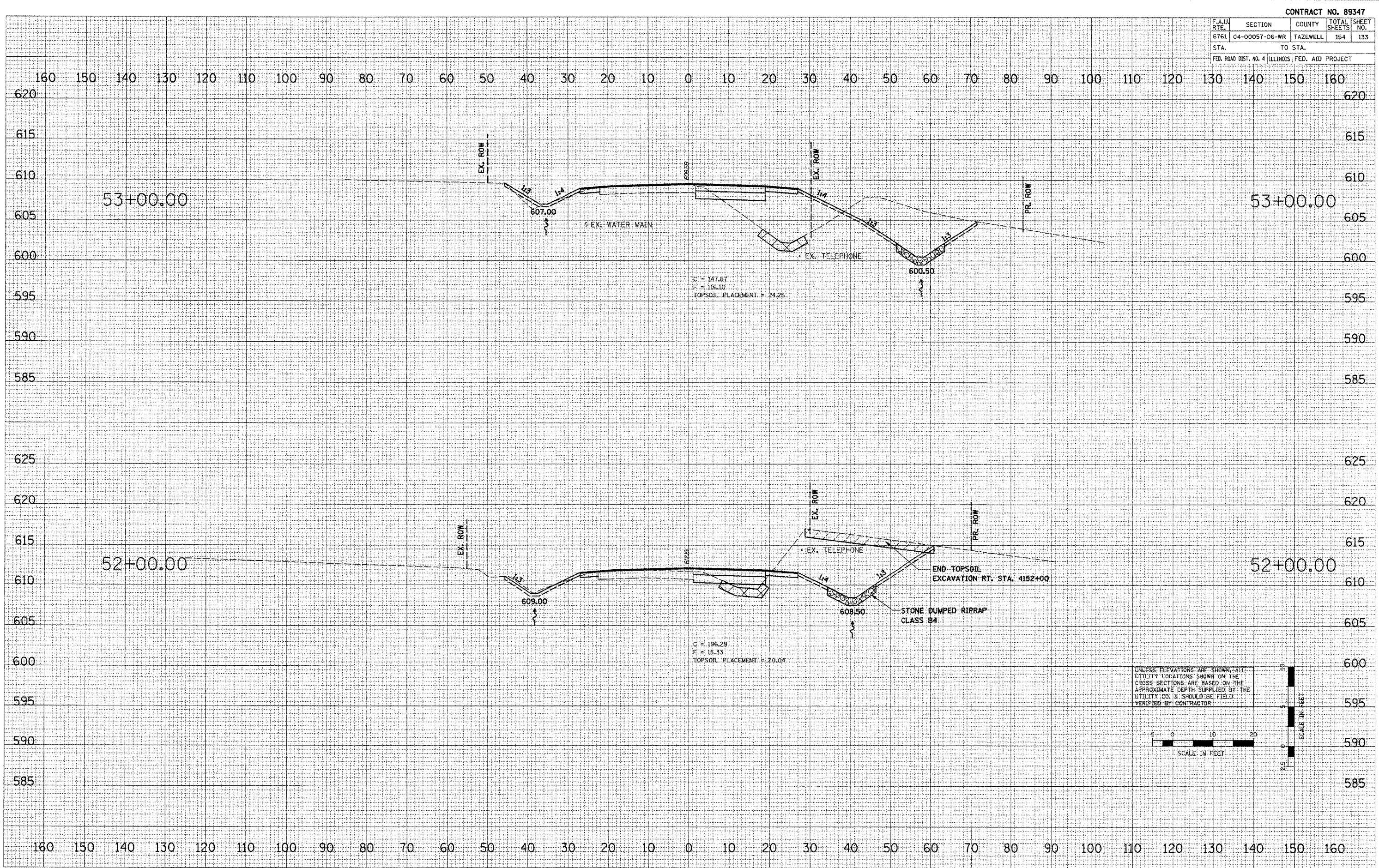

UNLESS ELEVATIONS ARE SHOWN, ALL UTILITY LOCATIONS SHOWN ON THE CROSS SECTIONS ARE BASED ON THE APPROXIMATE DEPTH SUPPLIED BY THE UTILITY CO. & SHOULD BE FIELD VERIFIED BY CONTRACTOR

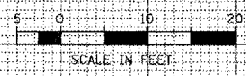

BROADWAY - CROSS SECTIONS