

| STATION | TREE TRUNK PROTECTION |
|------------------------|-----------------------|
| 108+40.25, 122.02' LT. | 1 |
| 108+42.91, 70.57' LT. | 1 |
| 108+84.64, 85.33' LT. | 1 |
| 108+96.03, 70.70' RT. | 1 |
| 109+08.48, 45.34' RT. | 1 |
| 109+58.99, 54.75' RT. | 1 |
| 110+06.97, 66.48' RT. | 1 |
| 110+63.40, 78.92' RT. | 1 |
| 110+80.15, 77.14' RT. | 1 |
| 111+49.31, 70.81' LT. | 1 |
| 111+99.32, 51.02' LT. | 1 |
| 112+02.99, 66.32' LT. | 1 |
| 112+37.98, 52.41' LT. | 1 |
| 112+84.56, 53.50' LT. | 1 |
| TOTAL | 14 |

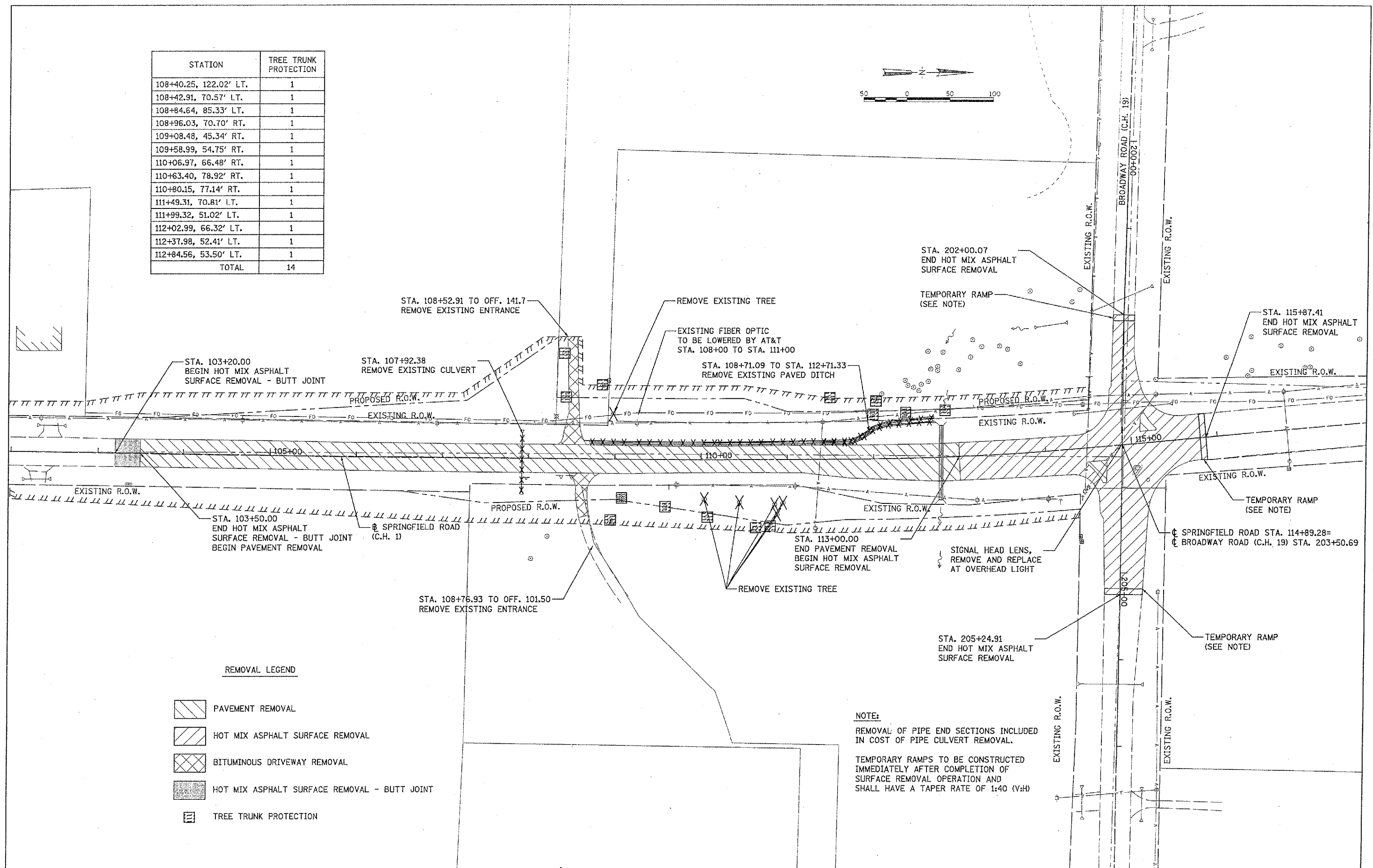
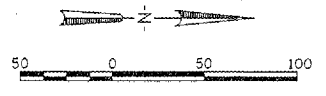

REMOVAL LEGEND

- PAVEMENT REMOVAL
- HOT MIX ASPHALT SURFACE REMOVAL
- BITUMINOUS DRIVEWAY REMOVAL
- HOT MIX ASPHALT SURFACE REMOVAL - BUTT JOINT
- TREE TRUNK PROTECTION

NOTE:
 REMOVAL OF PIPE END SECTIONS INCLUDED IN COST OF PIPE CULVERT REMOVAL.
 TEMPORARY RAMPS TO BE CONSTRUCTED IMMEDIATELY AFTER COMPLETION OF SURFACE REMOVAL OPERATION AND SHALL HAVE A TAPER RATE OF 1:40 (V:H)

| | | | |
|-----------------------------------------|------------------------|----------------|-----------|
| FILE NAME = | USER NAME = Ande-00848 | DESIGNED - MPB | REVISED - |
| \\25jobs\25p2284\civil\sheet\10-121.dwg | | DRAWN - MAD | REVISED - |
| PLOT SCALE = 1/32" = 1' / IN. | | CHECKED - | REVISED - |
| PLOT DATE = 22/11/2023, 11:19 AM | | DATE - | REVISED - |

**STATE OF ILLINOIS
 DEPARTMENT OF TRANSPORTATION**

REMOVAL PLAN

SCALE: 1:50 SHEET NO. OF SHEETS STA. TO STA.

| | | | | |
|-------------------------------------------------|----------------|----------|--------------------|-----------|
| F.A. RTE. | SECTION | COUNTY | TOTAL SHEETS | SHEET NO. |
| 464 | 07-00014-00-SP | TAZEWELL | 44 | 8 |
| FED. ROAD DIST. NO. 7 ILLINOIS FED. AID PROJECT | | | CONTRACT NO. 89480 | |
| | | | HS 1467-104 | |