

ROUTE NO.	SECTION	COUNTY	TOTAL SHEETS	SHEET NO.
FAS 683	*	EDGAR	160	101
STA. 80+00.00		TO STA. 81+00.00		
FED. RD. DIST. NO. 7		ILLINOIS PROJECT		
*05-00092-01-PK				

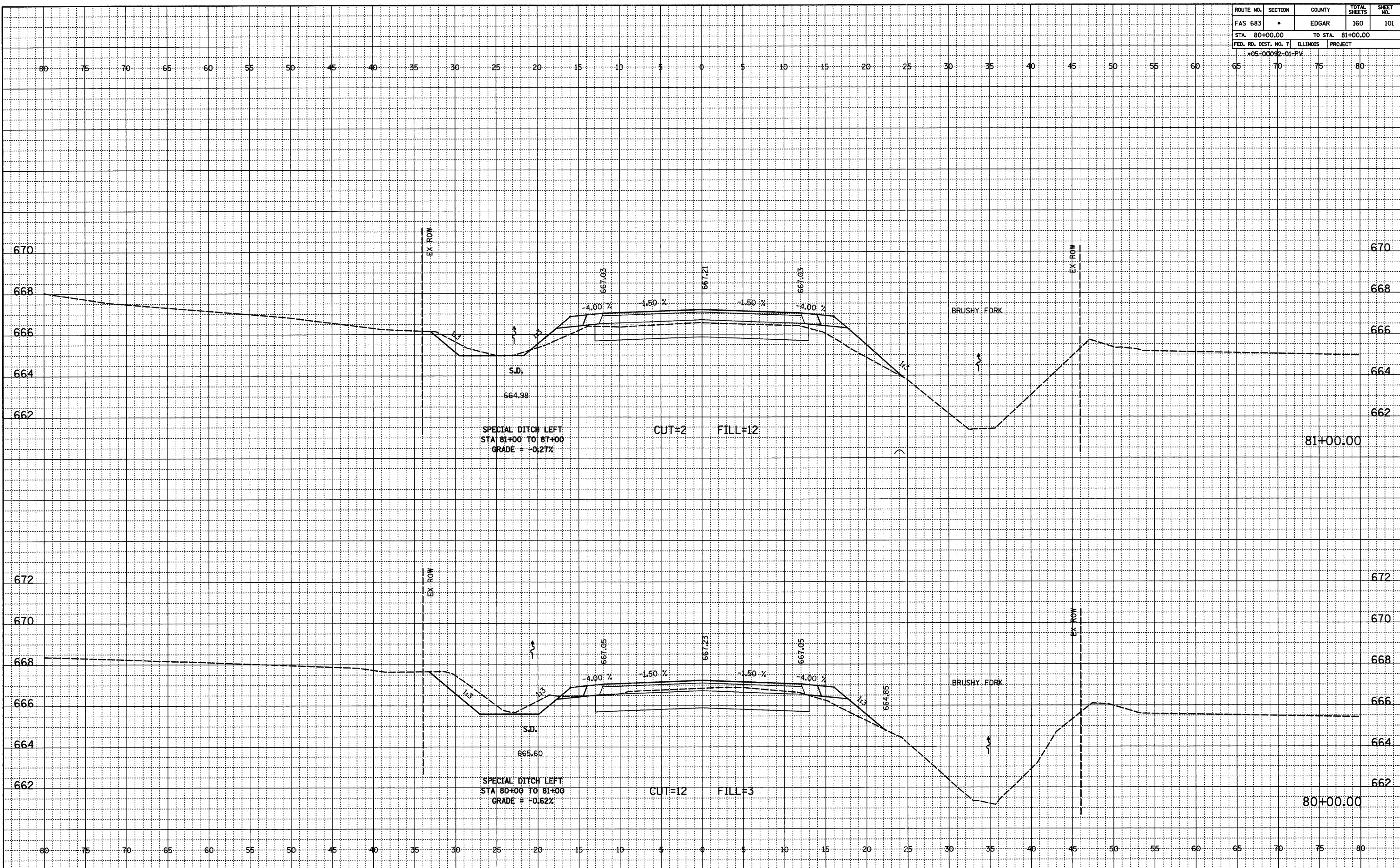

FINAL SURVEYED  
 NOTEBOOK  
 NO. \_\_\_\_\_

DATE \_\_\_\_\_

BY \_\_\_\_\_

PLOTTED  
 CHECKED  
 RT. BY \_\_\_\_\_

ORIGINAL SURVEYED  
 NOTEBOOK  
 NO. \_\_\_\_\_

DATE \_\_\_\_\_

BY \_\_\_\_\_

PLOTTED  
 CHECKED  
 STRUCTURE NOTATIONS OK'D