

ROUTE NO.	SECTION	COUNTY	TOTAL SHEETS	SHEET NO.
FAS 683	*	EDGAR	160	141
STA. 297+00.00		TO STA. 298+00.00		
FED. RD. DIST. NO. 7		ILLINOIS PROJECT		
*05-00092-D1-PV				

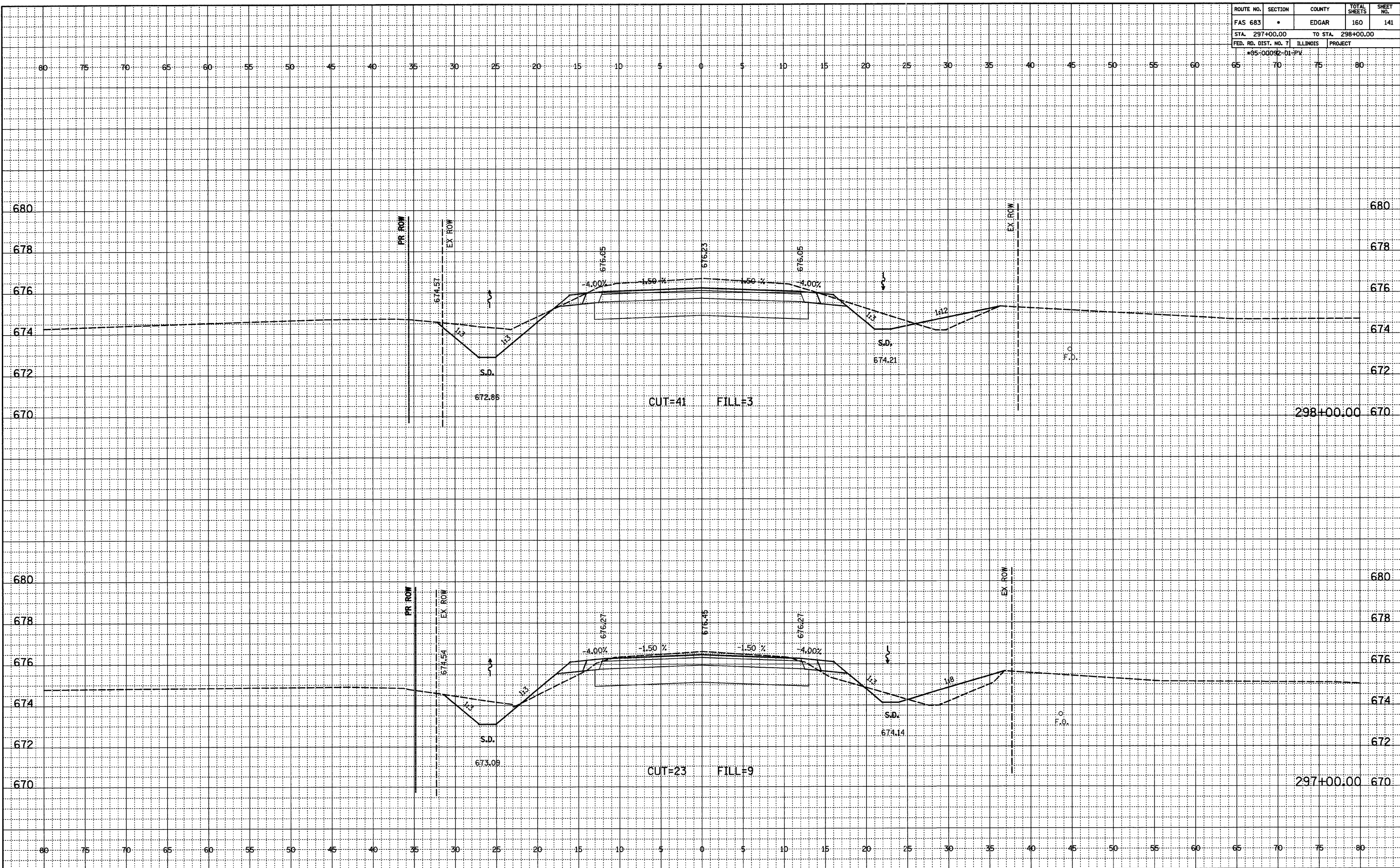

FINAL SURVEYED BY DATE  
 NOTEBOOK NO. OF WAY CHECKED  
 RT. OF WAY CHECKED

ORIGINAL SURVEYED BY DATE  
 NOTEBOOK NO. OF WAY CHECKED  
 RT. OF WAY CHECKED  
 STRUCTURE NOTATIONS OK'D