

F.A.S. RTE.	SECTION	COUNTY	TOTAL SHEETS	SHEET NO.
642	00-00127-00-WR	COLES	91	3
STA.		TO STA.		
FED. ROAD DIST. NO.		ILLINOIS FED. AID PROJECT		

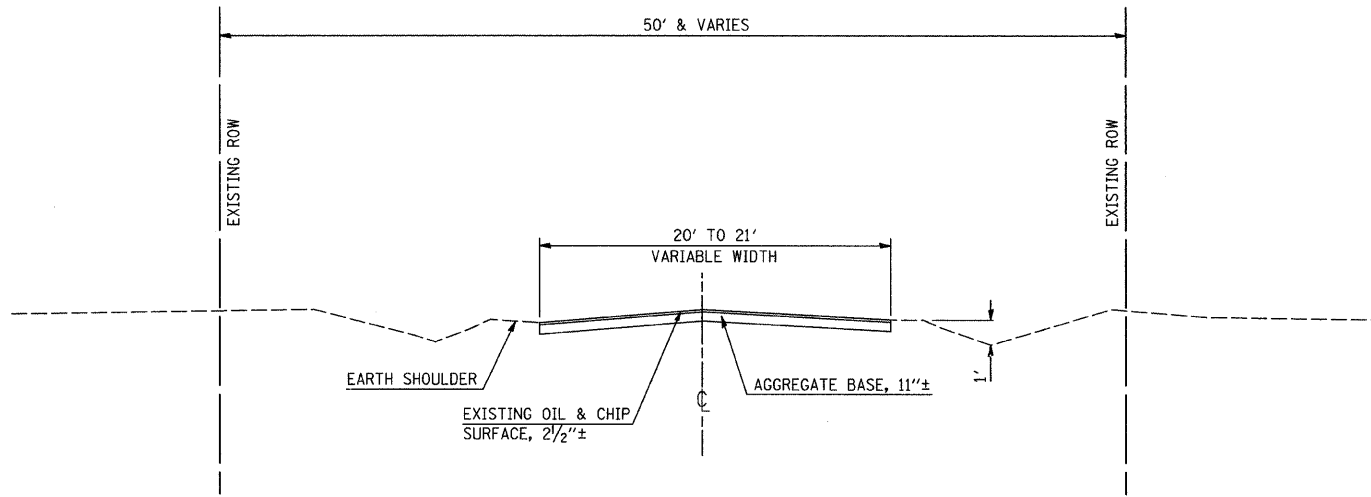

**EXISTING TYPICAL SECTION 1**

EXISTING C.H. 18  
 STA. 200+24 (STA. 23+98.23 PROPOSED C.H. 18) TO  
 STA. 220+91.55 (STA. 46+35.29 PROPOSED C.H.18)

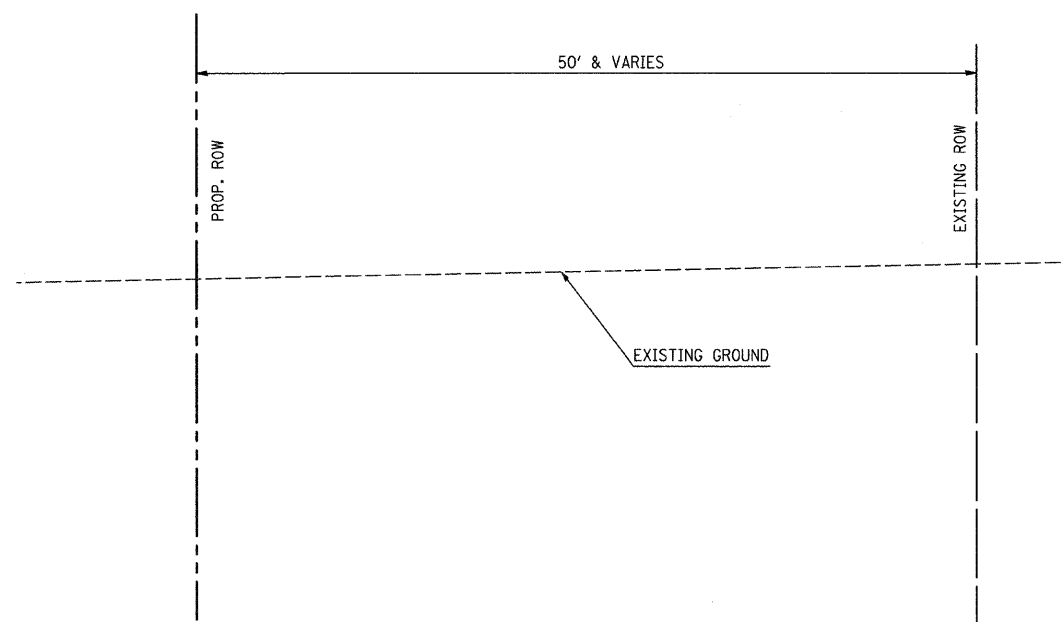

**EXISTING TYPICAL SECTION 3**

C.H. 18 RELOCATION  
 STA. 22+90.24 TO STA. 41+00

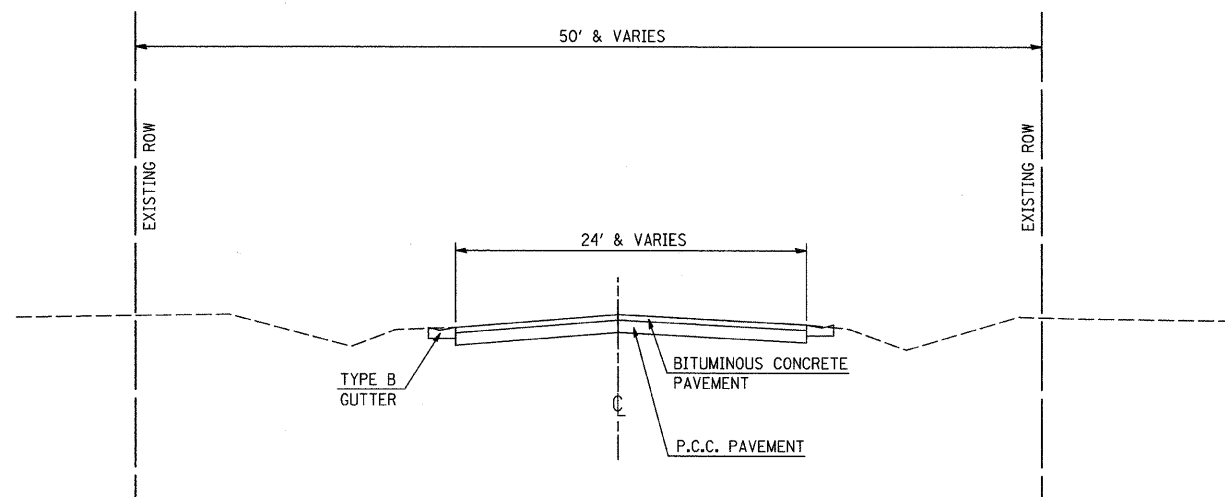

**EXISTING TYPICAL SECTION 2**

C.H. 18  
 STA. 20+90.00 TO STA. 21+61.03  
 STA. 21+87.06 TO STA. 22+50.27

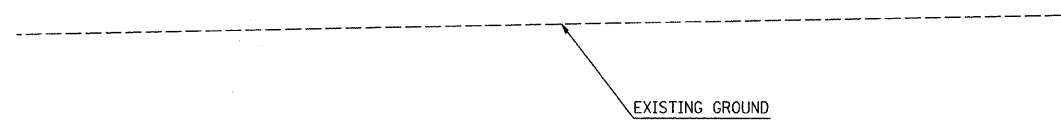

**EXISTING TYPICAL SECTION 4**

FRONTAGE ROAD  
 STA. 10+13 TO STA. 11+95.11

REVISIONS	
NAME	DATE

ILLINOIS DEPARTMENT OF TRANSPORTATION  
**EXISTING TYPICAL SECTIONS**

SCALE: VERT. HORIZ.  
 DATE 02/29/2008  
 DRAWN BY SJF  
 CHECKED BY MED

TUG PROJ. #303027  
 ...\\P1101\TOPPING\SHEET.dgn