

F.A.S. RTE.	SECTION	COUNTY	TOTAL SHEETS	SHEET NO.
642 00-00127-00-WR	COLES	91	41	
STA. 533+24.36 TO STA. 539+30.00				
FED. ROAD DIST. NO. ILLINOIS FED. AID PROJECT				

PLAN	SURVEYED	DATE
	BY	
	NOTED	
	CHECKED	
	DATE	

PROFILE	SURVEYED	DATE
	BY	
	NOTED	
	CHECKED	
	DATE	

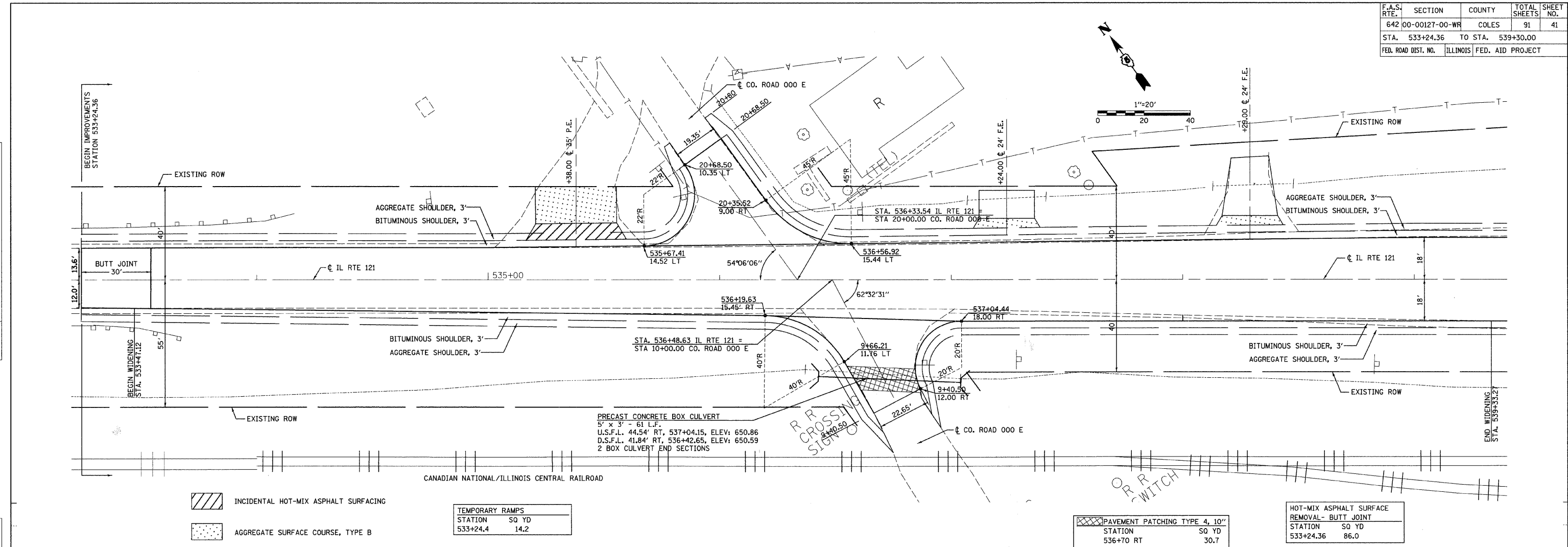

- INCIDENTAL HOT-MIX ASPHALT SURFACING
- AGGREGATE SURFACE COURSE, TYPE B

TEMPORARY RAMPS	
STATION	SQ YD
533+24.4	14.2

PAVEMENT PATCHING TYPE 4, 10"	
STATION	SQ YD
536+70 RT	30.7

HOT-MIX ASPHALT SURFACE REMOVAL- BUTT JOINT	
STATION	SQ YD
533+24.36	86.0

