

F.A.S. RTE.	SECTION	COUNTY	TOTAL SHEETS	SHEET NO.
642	00-00127-00-WR	COLES	91	59
STA. 539+30		TO STA. 545+40		
FED. ROAD DIST. NO.		ILLINOIS	FED. AID PROJECT	

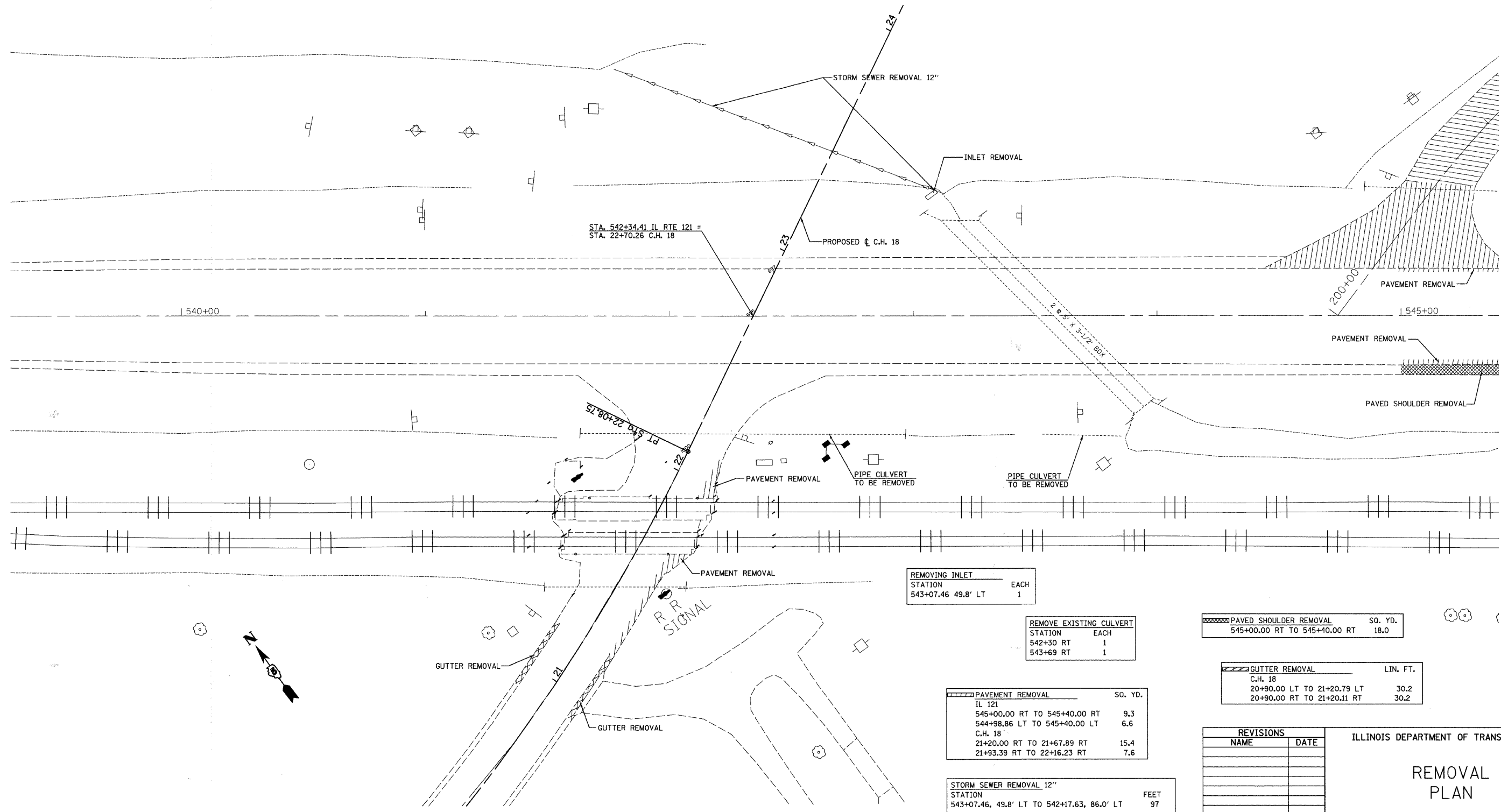

REMOVING INLET		
STATION		EACH
543+07.46	49.8' LT	1

REMOVE EXISTING CULVERT		
STATION		EACH
542+30	RT	1
543+69	RT	1

PAVEMENT REMOVAL		
		SQ. YD.
IL 121		
545+00.00	RT TO 545+40.00	9.3
544+98.86	LT TO 545+40.00	6.6
C.H. 18		
21+20.00	RT TO 21+67.89	15.4
21+93.39	RT TO 22+16.23	7.6

PAVED SHOULDER REMOVAL		
STATION		SQ. YD.
545+00.00	RT TO 545+40.00	18.0

GUTTER REMOVAL		
		LIN. FT.
C.H. 18		
20+90.00	LT TO 21+20.79	30.2
20+90.00	RT TO 21+20.11	30.2

REVISIONS	
NAME	DATE

ILLINOIS DEPARTMENT OF TRANSPORTATION

REMOVAL PLAN

SCALE: VERT. _____
 HORIZ. 1"=20'
 DATE 02/28/2008

DRAWN BY RLH
 CHECKED BY MED

TUC PROJ. #3103027
 ..\white\topping\sheet\removal.dgn