

|                     |                  |                  |              |           |
|---------------------|------------------|------------------|--------------|-----------|
| F.A.S. RTE.         | SECTION          | COUNTY           | TOTAL SHEETS | SHEET NO. |
| 642                 | 00-00127-00-WR   | COLES            | 91           | 62        |
| STA. 31+50          | TO STA. 42+83.31 |                  |              |           |
| FED. ROAD DIST. NO. | ILLINOIS         | FED. AID PROJECT |              |           |

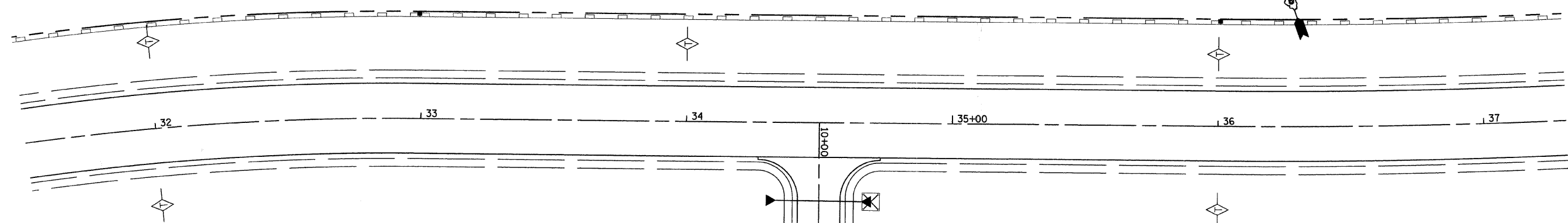

**INTENDED SEQUENCE**

- 1) PLACE PERIMETER EROSION CONTROL BARRIER PRIOR TO COMMENCEMENT OF ANY WORK. SEE STD. 280001
- 2) CONSTRUCT EARTHWORK, INCLUDING DITCHES. (MAXIMUM 10 ACRES DISTURBED AT ONE TIME PRIOR TO SEEDING. SEE ART. 280)
- 3) PLACE AND MAINTAIN TEMPORARY AND PERMANENT EROSION CONTROLS AS WORK PROGRESSES, SEED EVERY 7 DAYS. SEE ART. 280
- 4) FINAL SHAPE, GRADE, AND PAVE ROADWAY
- 5) PLACE REMAINING PERMANENT EROSION CONTROLS.

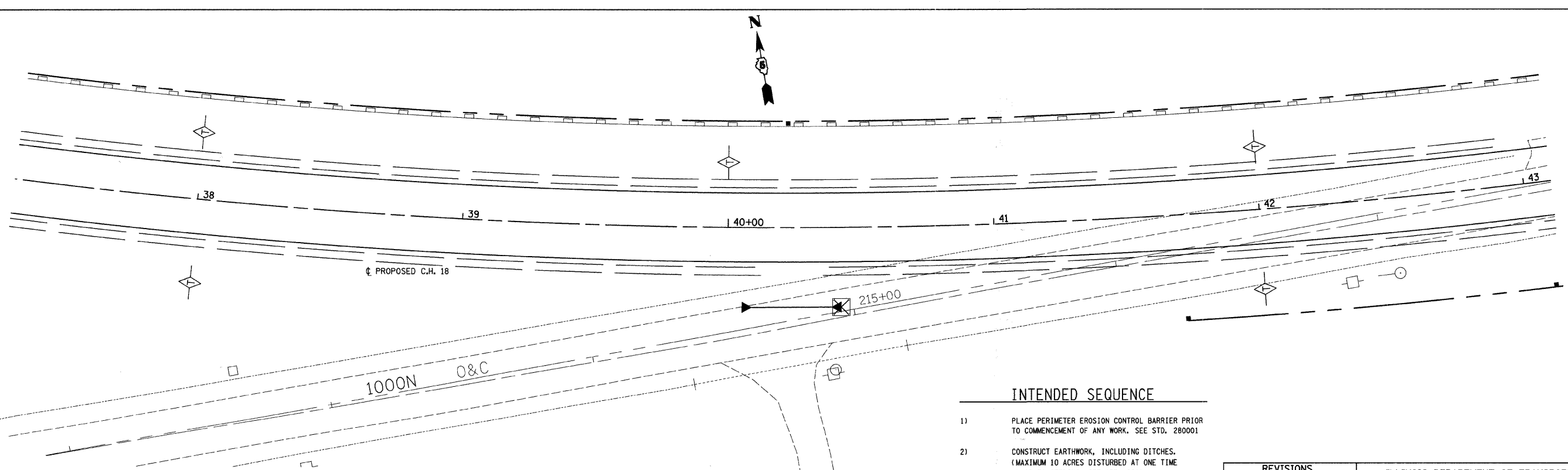
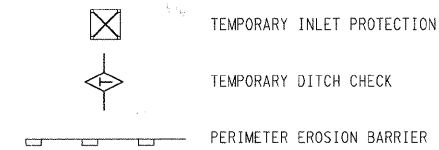

**INTENDED SEQUENCE**

- 1) PLACE PERIMETER EROSION CONTROL BARRIER PRIOR TO COMMENCEMENT OF ANY WORK. SEE STD. 280001
- 2) CONSTRUCT EARTHWORK, INCLUDING DITCHES. (MAXIMUM 10 ACRES DISTURBED AT ONE TIME PRIOR TO SEEDING. SEE ART. 280)
- 3) PLACE AND MAINTAIN TEMPORARY AND PERMANENT EROSION CONTROLS AS WORK PROGRESSES, SEED EVERY 7 DAYS. SEE ART. 280
- 4) FINAL SHAPE, GRADE, AND PAVE ROADWAY
- 5) PLACE REMAINING PERMANENT EROSION CONTROLS.

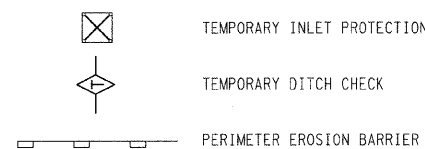

| REVISIONS |      |
|-----------|------|
| NAME      | DATE |
|           |      |
|           |      |
|           |      |
|           |      |
|           |      |
|           |      |
|           |      |
|           |      |
|           |      |
|           |      |

ILLINOIS DEPARTMENT OF TRANSPORTATION

**EROSION CONTROL PLAN**

SCALE: VERT. 1"=20'  
HORIZ. 1"=20'  
DATE 02/28/2008

DRAWN BY RLH  
CHECKED BY MED

TUG PROJ. #303027  
...whitefopping...sheeterosion.dgn