

F.A. RTE.	SECTION	COUNTY	TOTAL SHEETS	SHEET NO.
**	**	MACON	106	21

STA.	TO STA.
FED. ROAD DIST. NO.	ILLINOIS FED. AID PROJECT

** 05-00525-00SW

SEE GEOMETRICS SHEET FOR INTERSECTION SIDEWALK LAYOUT

MILLIKIN UNIVERSITY
 STA 987+62.26 WEST MAIN ST
 = STA 24+52.60 FAIRVIEW AVE

MILLIKIN UNIVERSITY

SAWCUT PARKING LOT AND
 INSTALL BARRIER CURB.
 CURB TRANSITIONS FROM 0'
 AT SIDEWALK TO MATCH
 EXISTING.

DATE	BY	REVISION

PLAN	NO.	DATE	BY	REVISION

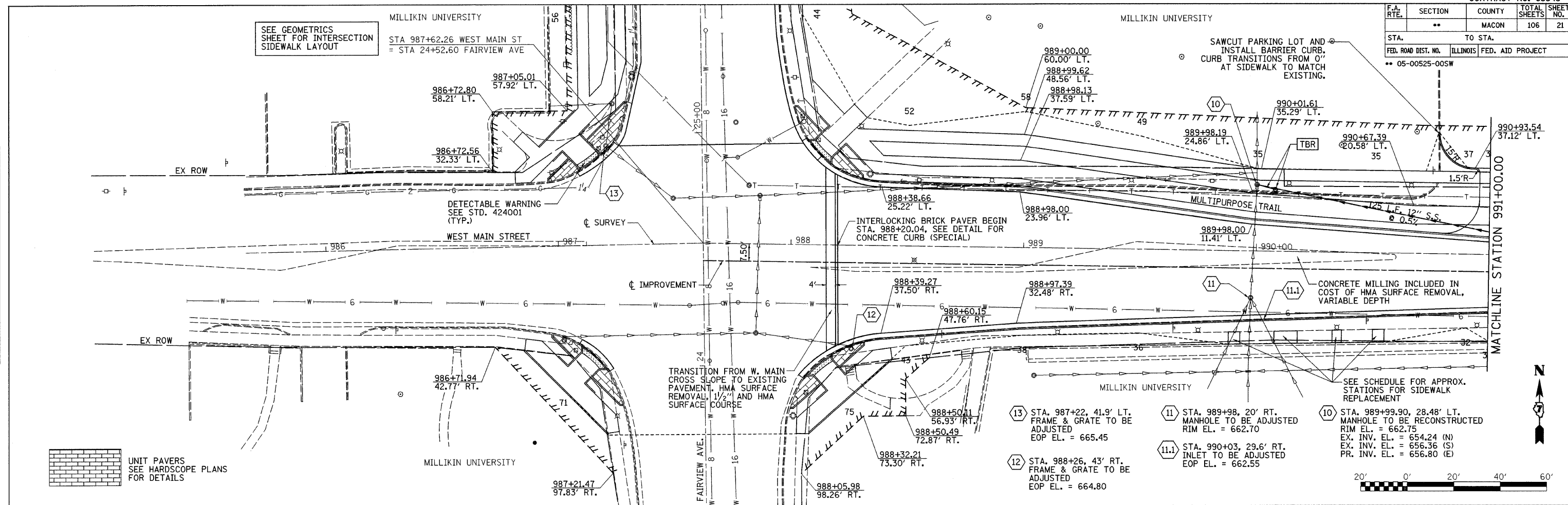

UNIT PAVERS
 SEE HARDSCOPE PLANS
 FOR DETAILS

TRANSITION FROM W. MAIN
 CROSS SLOPE TO EXISTING
 PAVEMENT, HMA SURFACE
 REMOVAL, 1 1/2" AND HMA
 SURFACE COURSE

INTERLOCKING BRICK PAVEMENT
 STA. 988+20.04, SEE DETAIL FOR
 CONCRETE CURB (SPECIAL)

CONCRETE MILLING INCLUDED IN
 COST OF HMA SURFACE REMOVAL,
 VARIABLE DEPTH

SEE SCHEDULE FOR APPROX.
 STATIONS FOR SIDEWALK
 REPLACEMENT

13 STA. 987+22, 41.9' LT.
 FRAME & GRATE TO BE
 ADJUSTED
 EOP EL. = 665.45

11 STA. 989+98, 20' RT.
 MANHOLE TO BE ADJUSTED
 RIM EL. = 662.70

10 STA. 989+99.90, 28.48' LT.
 MANHOLE TO BE RECONSTRUCTED
 RIM EL. = 662.75
 EX. INV. EL. = 654.24 (N)
 EX. INV. EL. = 656.36 (S)
 PR. INV. EL. = 656.80 (E)

12 STA. 988+26, 43' RT.
 FRAME & GRATE TO BE
 ADJUSTED
 EOP EL. = 664.80

11.1 STA. 990+03, 29.6' RT.
 INLET TO BE ADJUSTED
 EOP EL. = 662.55

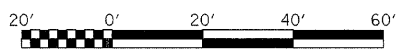

DATE	BY	REVISION

PROFILE	NO.	DATE	BY	REVISION

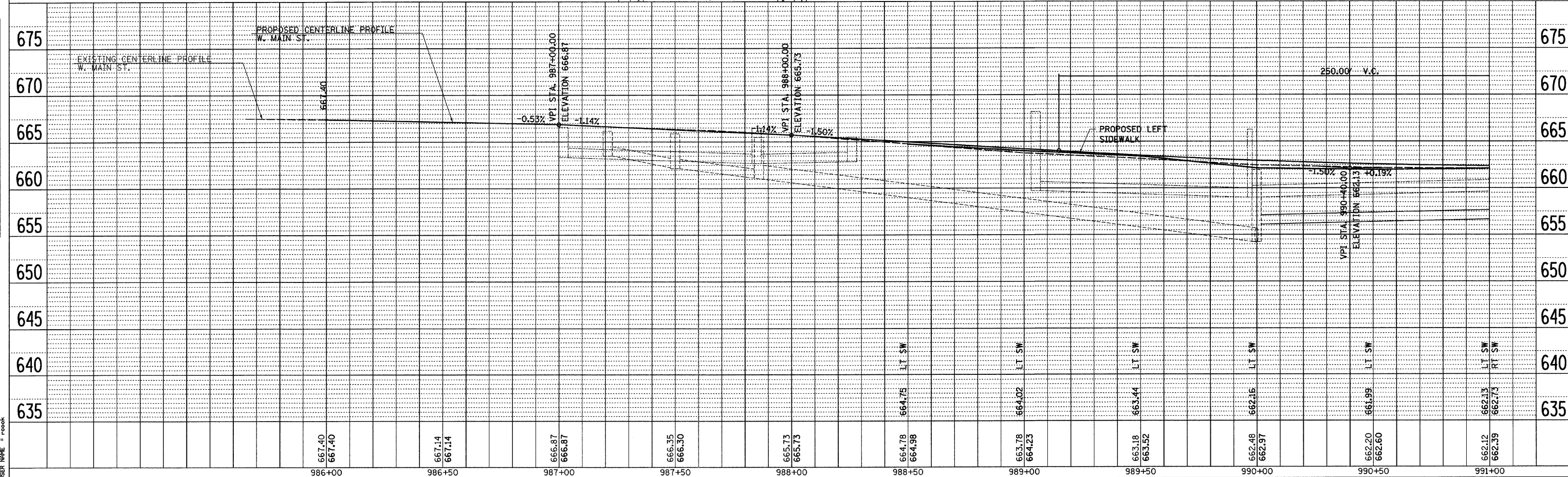

PLOT DATE = 2/26/2008
 FILE NAME = P:\05090505\Drawings\plan\profile\main.dgn
 USER NAME = jtk
 USER NAME = jtk