

F.A. RTE.	SECTION	COUNTY	TOTAL SHEETS	SHEET NO.
**	**	MACON	106	40
STA.		TO STA.		
FED. ROAD DIST. NO.		ILLINOIS	FED. AID PROJECT	
** 05-00525-00SW				

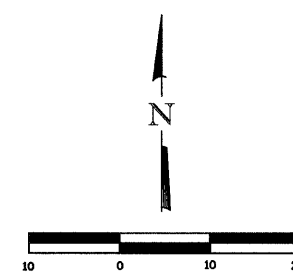

LEGEND
 INDICATES PROPOSED GRADE ELEVATION. INTERVAL ALONG CURVE IS 10' UNLESS NOTED.

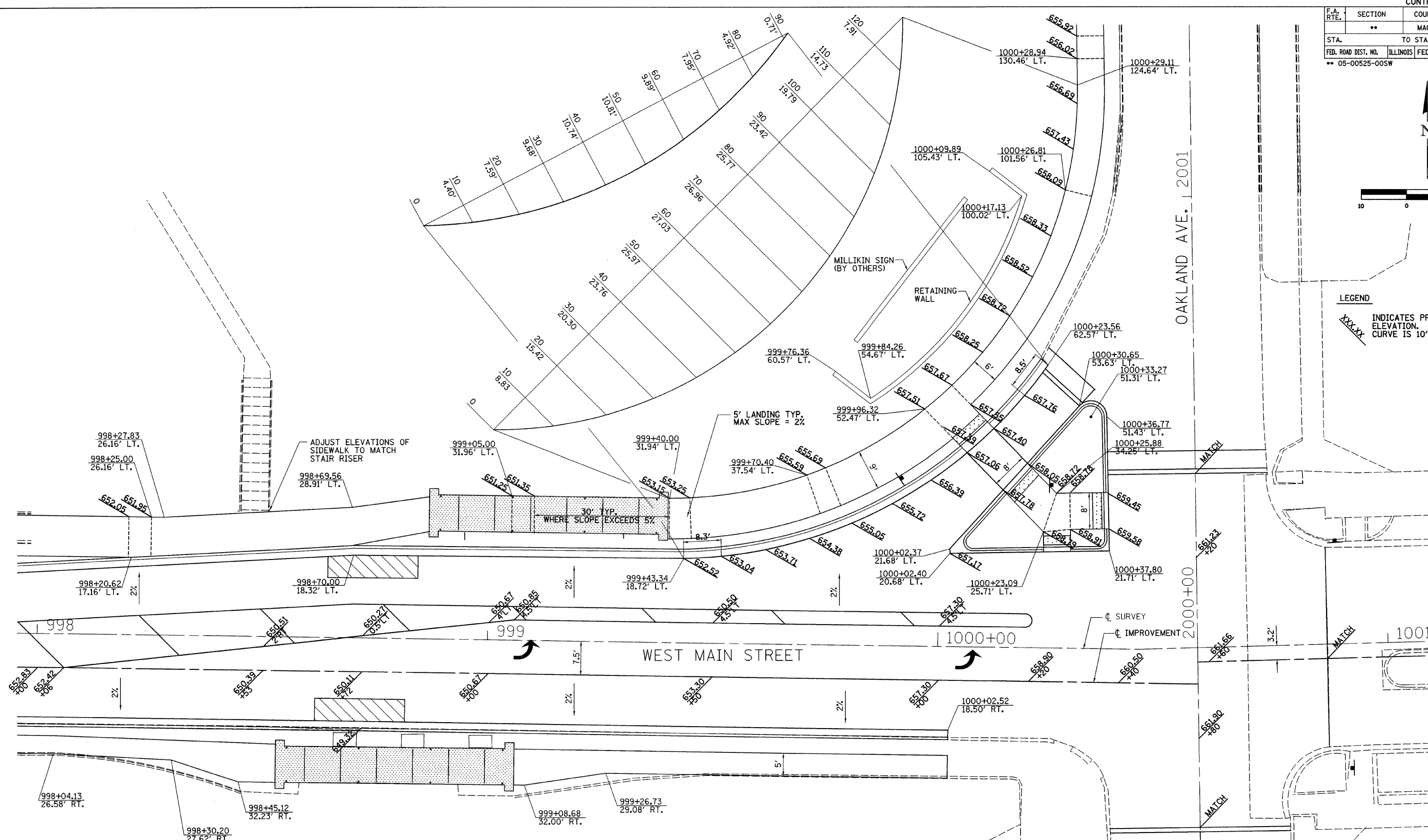

- SHEET NOTES**
1. STATION AND OFFSET CALLOUTS ARE FROM ϕ OF SURVEY.
 2. LOCATION AND ELEVATION OF INLETS AND CATCH BASINS ARE NOT SHOWN ON GEOMETRIC PLANS. SEE PLAN & PROFILE SHEETS.

REVISIONS	
NAME	DATE

ILLINOIS DEPARTMENT OF TRANSPORTATION

INTERSECTION GEOMETRICS

SCALE: VERT. HORIZ.
 DATE 1/08

DRAWN BY RJC
 CHECKED BY CWG

PLOT DATE = 2/25/2008
 FILE NAME = F:\95545\Drawings\Intersections\geomtr.rsdgn
 USER NAME = jrb
 USER = jrb