

F.A. RTE.	SECTION	COUNTY	TOTAL SHEETS	SHEET NO.
**	**	MACON	106	54
STA.		TO STA.		
FED. ROAD DIST. NO.		ILLINOIS	FED. AID PROJECT	
** 05-00525-00SW 6'-0" CLEAR				

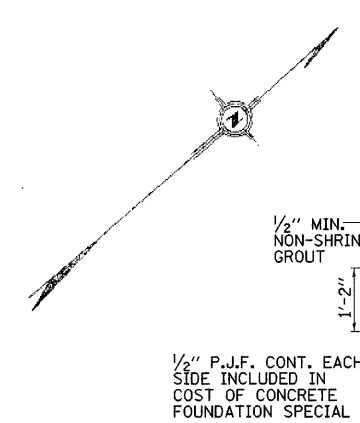
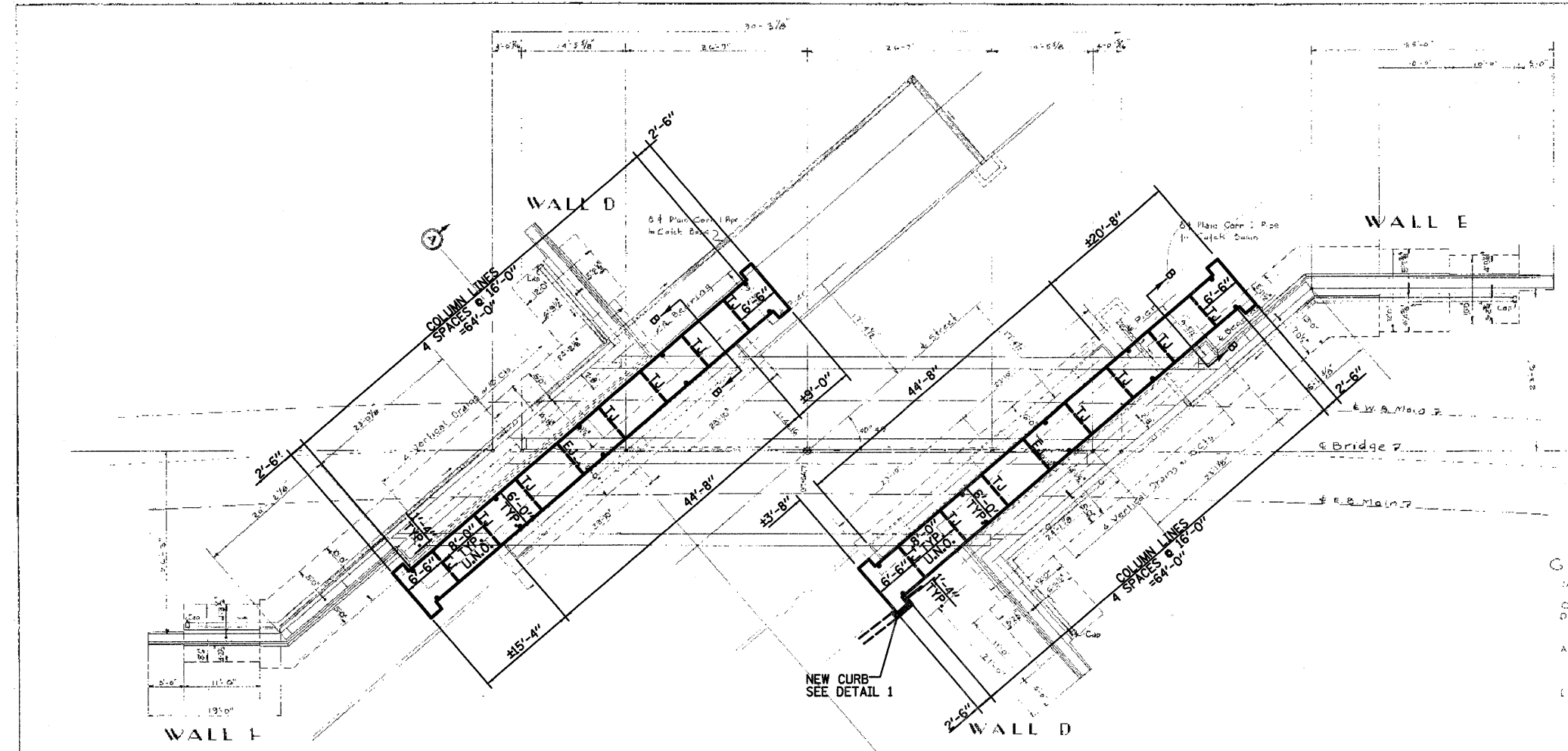

FACE OF EXIST. PIER      FACE OF EXIST. ABUT.

THE DESIGN OF THE CANOPY BASE PLATES, ANCHOR BOLTS AND ADDITIONAL REINFORCEMENT FOR ANCHORAGE TO BE PROVIDED BY THE CANOPY MANUFACTURER AND SUBMITTED TO THE OWNERS REPRESENTATIVE FOR APPROVAL PRIOR TO FABRICATION. DRAWINGS AND CALCULATIONS TO BE SEALED BY A LICENSED S.E. IN THE STATE OF ILLINOIS.

1-2"      1/2" MIN. NON-SHRINK GROUT

#4 @ 48" O.C. EACH SIDE

2" CL. TOP & BTM.

THE COST OF ANCHOR BOLTS AND ADDITIONAL REINFORCEMENT OR CONCRETE FOR CANOPY ANCHORAGE IS INCLUDED IN THE COST OF CANOPIES SPECIAL

#5 @ 12" O.C. E.W. COST OF REINF. INCLUDED IN CONCRETE FOUNDATION SPECIAL

SECTION B-B

- NOTES:
1. MIN. LAP LENGTH FOR #5 BARS = 2'-2".
  2. CONCRETE WORK SHALL BE IN ACCORDANCE WITH SECTION 503 OF THE STANDARD SPECIFICATIONS.
  3. THE FINISH ON THE TOP OF THE FOUNDATION SHALL BE IN ACCORDANCE WITH SECTION 424.06 OF THE STANDARD SPECIFICATIONS.
  4. JOINTS INDICATED BY "TJ" OR "EJ" TOOLED OR EXPANSION ON PLANS SHALL BE PLACED IN ACCORDANCE WITH SECTION 424.06 OF THE STANDARD SPECIFICATIONS. TOOLED JOINTS SHALL HAVE A GROOVE DEPTH OF 1".

GENERAL BRIDGE NOTES

SPECIFICATIONS: State of Illinois Standard Specifications for CONCRETE. All concrete to be CLASS 'X' DILING. All piping to be treated. Timber Test Pile to be drilled to determine length of pier. Design load: 80,000# ABUTMENT WALL WATERPROOFING: 15 mil fabric fastened at top (except where joints of deck slabs) by flashing. See S5.4.6 for detail. EXPANSION JOINTS: Expansion joints will only be allowed between Abutment Section and Walls. ERF for detail see S5.4.5. No other vertical construction joints allowed. HORIZONTAL CONSTRUCTION JOINTS: No horizontal joints will be allowed except at top of footing and at bridge seat elevation. Joint at bridge seat elevation to have a 9" x 9" Copper Water Stop soldered to vertical copper in E.W. joints.

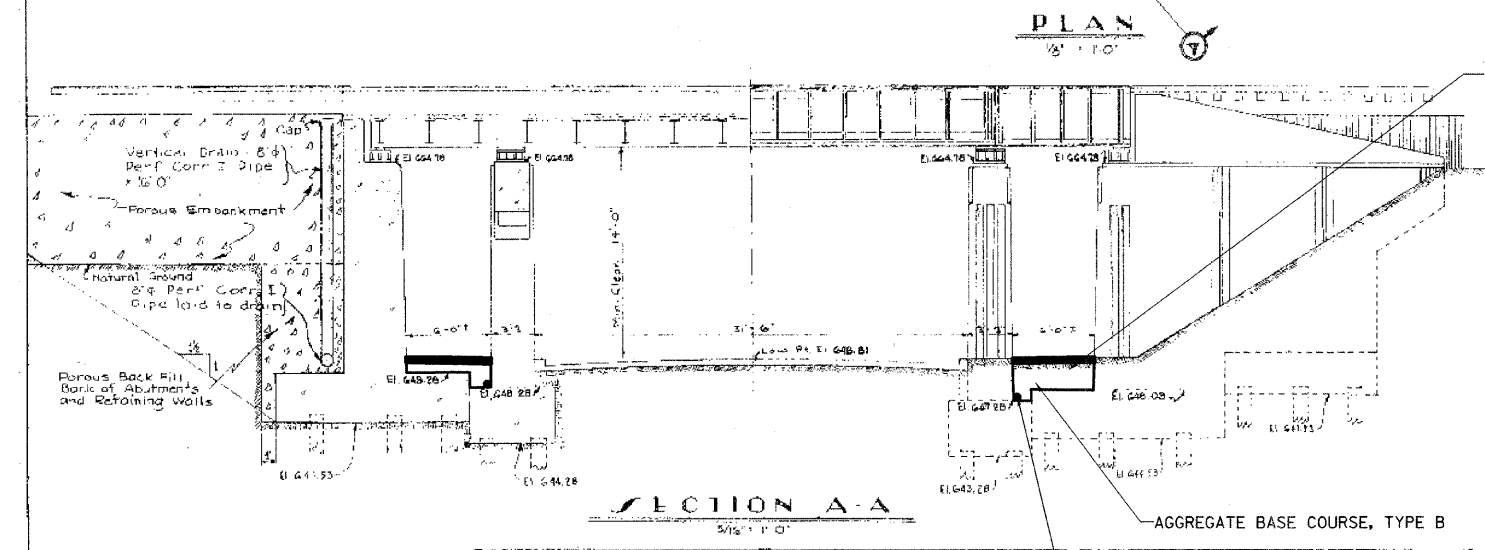
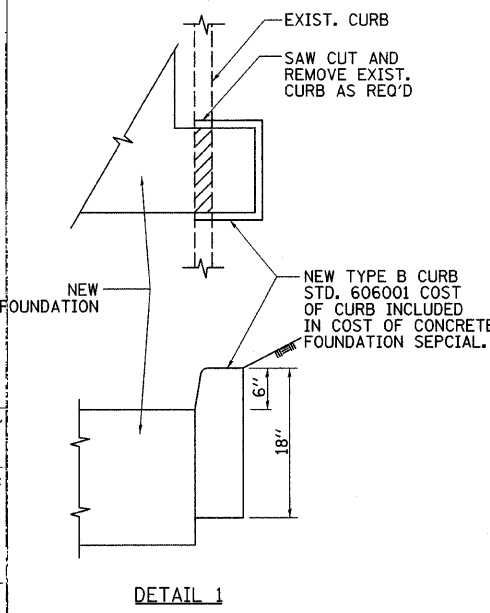

WABASH RAILWAY COMPANY  
OFFICE OF CHIEF ENGINEER  
W. MAIN ST. - OAKLAND AVE. GRADE SEPARATION  
DECATUR, ILLINOIS  
OAKLAND AVE. BRIDGE  
GENERAL BRIDGE PLAN

DATE: Oct 1 1935	DRAWN BY: BJC	SHEET
SCALE: 1/8" = 1'-0"	CHECKED BY: HCK	
DESIGNED BY: DW	QUANTITIES E.W.K.	11 of 23
DESIGN CHECKED: WG	CHECKED: HCK	

Approved: *William R. Jones*  
Registered Structural Engineer

CONCRETE FOUNDATIONS (SPECIAL)  
36.7 CU YD

SUB-BASE GRANULAR MATERIAL, TYPE B  
51.0 TON

OAKLAND AVENUE

GENERAL BRIDGE PLAN WAS PROVIDED BY NORFOLK SOUTHERN CORPORATION AND SCANNED INTO DRAWING.

REV. NO.	DESCRIPTION	BY	DATE	APPROVED
CANOPY FOUNDATIONS				
DESIGN BWC	WEST MAIN STREET PHASE II CITY OF DECATUR			SCALE
DATE 4/06				N.T.S.
DRAWN RJC				BWC PROJECT NO.
DATE 4/06				009-0605
CHECKED			DATE	
DATE			1/08	
APPROVED				SHEET
DATE				2 OF 2
CLIENT APPR. DATE	<b>BWC</b> BLANK, WESSELINK, COOK & ASSOCIATES, INC.			
	ARCHITECTS      ENGINEERS			
	2623 EAST PERSHING ROAD, DECATUR, IL 62524 (217) 428-0973 FAX (217) 428-8934			