

F.A.P. RTE.	SECTION	COUNTY	TOTAL SHEETS	SHEET NO.
*	**	ALEXANDER	65	25
STA.		TO STA.		
FED. ROAD DIST. NO.		ILLINOIS FED. AID PROJECT		

- FAP 14 (US51/60/62)
- 138(IN,TS-2,RS-2)

NOTES:

THE FLAGMEN ON THIS DETAIL ARE SHOWN AT SUGGESTED LOCATIONS. THE ACTUAL NUMBER AND LOCATION SHALL BE AS DIRECTED BY THE ENGINEER.

ADDITIONAL TRAFFIC CONTROL DEVICES MAY BE NECESSARY AS DIRECTED BY THE ENGINEER.

TRAFFIC CONTROL FOR THIS WORK SHALL BE PAID FOR AS TRAFFIC CONTROL AND PROTECTION, SPECIAL

STAGE 2:

1. TYPE III TEMPORARY TAPE (BLACK) SHALL BE USED TO COVER THE CONFLICTING CENTERLINE PAVEMENT MARKINGS ALONG US 51/60/62 AND SHALL BE REMOVED AFTER STAGE 2 CONSTRUCTION IS COMPLETE.
2. REMOVE EXISTING PAVEMENT, V-GUTTER, COMB. CURB AND GUTTER, MEDIAN SURFACE, AND INLETS. CONSTRUCT PCC PAVEMENT, COMBINATION CONCRETE C & G, BITUMINOUS SHOULDERS, INLETS, MANHOLE, AND SOLID MEDIAN NOSE.
3. NINE CONSECUTIVE INTERSECTION RENTAL DAYS WILL BE PROVIDED FOR THIS STAGE. NO LANE RENTAL DAYS WILL BE CHARGED.
4. DETAILS FOR THE PROPOSED DETOUR ARE SHOWN ON THE DETOUR SHEETS.
5. SOUTHBOUND US 51 AND US 60/62 SHALL BE CLOSED ACCORDING TO STANDARD BLR 22 AND AS DIRECTED BY THE ENGINEER.

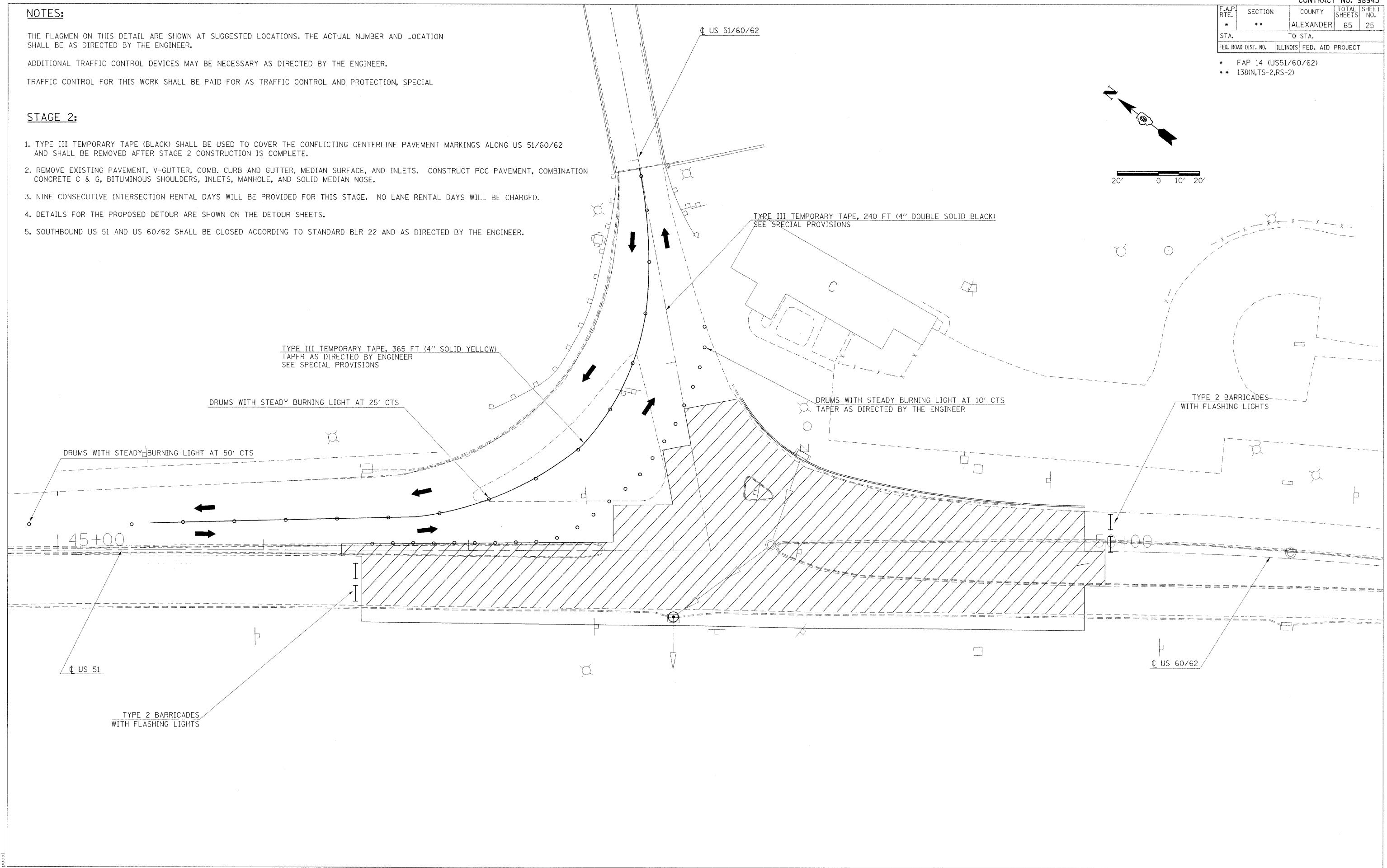
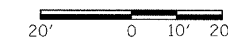
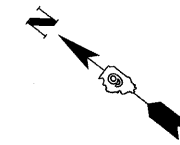

1/29/2007
c:\p\c\j\st\10000205\0500205.dgn
20.0000 11
p001