

| F.A.P. RTE.                                  | SECTION | COUNTY                    | TOTAL SHEETS | SHEET NO. |
|--|---------|---------------------------|--------------|-----------|
| *  | **      | ALEXANDER                 | 65           | 49        |
| STA. 49+70.00                                |         | TO STA. 49+90.00          |              |           |
| FED. ROAD DIST. NO.                          |         | ILLINOIS FED. AID PROJECT |              |           |
| * FAP 14 (US51/60/62)<br>** 138(N,TS-2,RS-2) |         |                           |              |           |

SURVEY PLOTTED  
 NOTE BOOK NO. \_\_\_\_\_  
 AREAS CHECKED \_\_\_\_\_  
 NO. \_\_\_\_\_

SURVEY PLOTTED  
 NOTE BOOK NO. \_\_\_\_\_  
 AREAS CHECKED \_\_\_\_\_  
 NO. \_\_\_\_\_

11/30/2007  
 c:\projects\110206\110206.mxd  
 5:00:00 PM  
 pces1

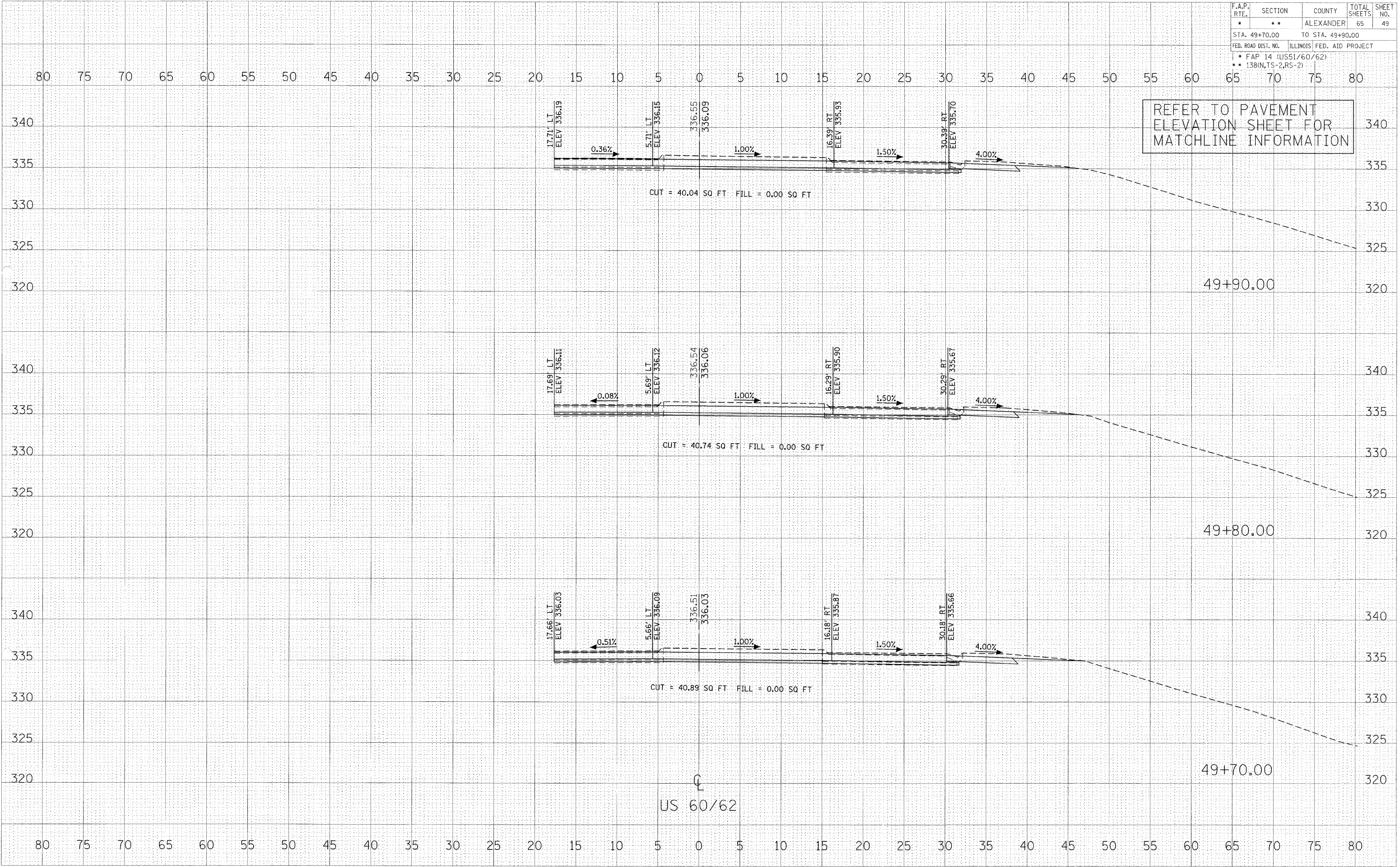

REFER TO PAVEMENT ELEVATION SHEET FOR MATCHLINE INFORMATION