

ROUTE NO.	SECTION	COUNTY	TOTAL SHEETS	SHEET NO.
CH 13	07-00113-00-SP	WILLIAMSON	8	01
ILLINOIS		SOUTH MARKET STREET		

CONTRACT NO. 99312

**STATE OF ILLINOIS  
DEPARTMENT OF TRANSPORTATION**

# PLANS FOR PROPOSED FEDERAL-AID PROJECT

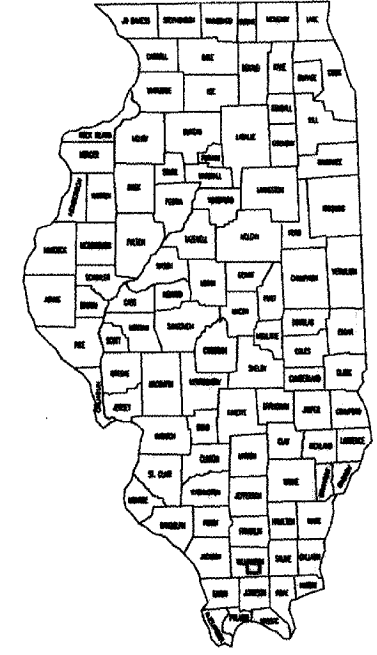

**SAFETY FUNDS**  
**CH 13 (S. MARKET ST.)**  
**07-00113-00-SP**  
**WILLIAMSON COUNTY**  
**PROJECT NO. HRR-0199(027)**  
**JOB NO. C-99-548-07**

**STRUCTURAL DESIGN INFORMATION**

MODIFIED AASHTO DESIGN FOR FLEXIBLE PAVEMENT  
2006 ADT = 2050  
DESIGN PERIOD = 20 YEARS  
2017 PROJECTED ADT = 2,265  
(1% ANNUAL INCREASE)

<b>TYPE</b>	<b>NO.</b>
P.V.	1,994
S.U.	182
<u>M.U.</u>	<u>91</u>
<b>TOTAL</b>	<b>2,265</b>

**STREET CLASSIFICATION: CLASS 2**  
(2 LANE WITH 2,000 ADT OR GREATER)

TRAFFIC FACTOR: 0.766  
ILLINOIS BEARING RATIO: 4  
STRUCTURAL NUMBER: 3.75

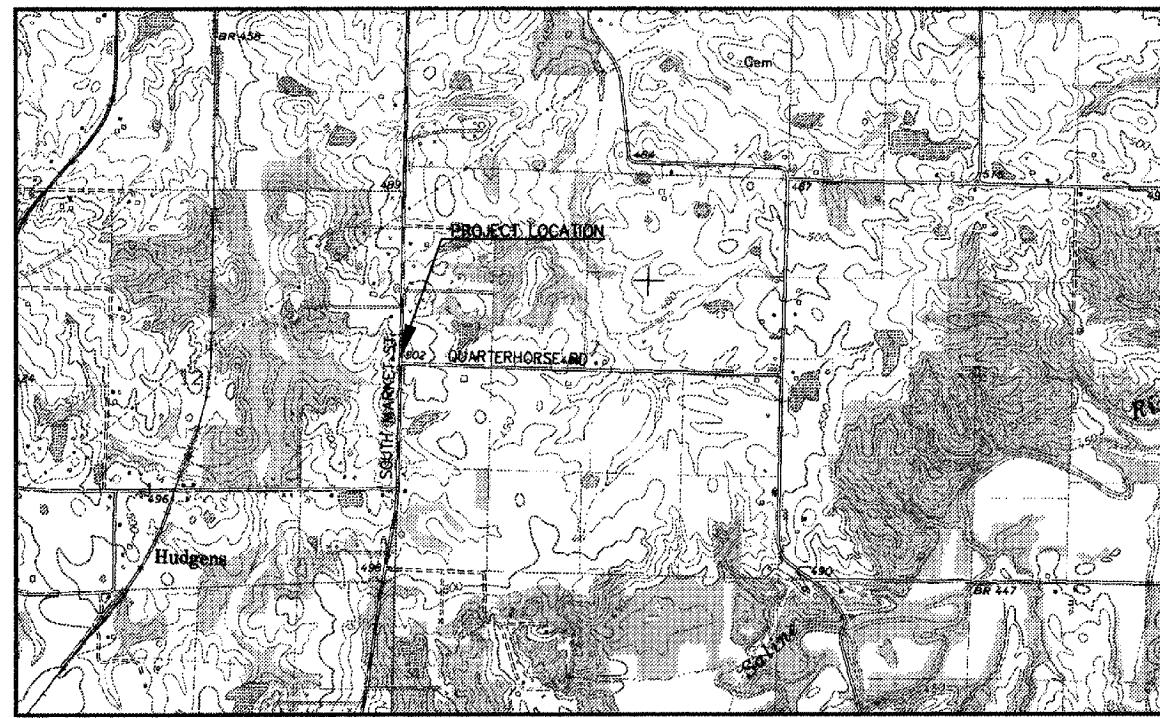

LOCATION MAP (NOT TO SCALE)

NET LENGTH OF PROJECT = 634.12 L.F. = 0.120 MI.

CONTRACTOR SHALL CONTACT J.U.L.I.E. OPERATOR AT 1-800-892-0123 FOR MARKING OF EXISTING UNDERGROUND UTILITIES. J.U.L.I.E. SHOULD BE CONTACTED A MINIMUM OF 96 HOURS IN ADVANCE OF CONSTRUCTION. CONTRACTOR SHALL MEET ALL REQUIREMENTS FOR CROSSING OF ANY EXISTING UTILITIES.

STATE OF ILLINOIS DEPARTMENT OF TRANSPORTATION	
APPROVE	2/27/07 .20 08
COUNTY ENGINEER WILLIAMSON COUNTY	
PASSE	FEB. 13 20 08
DISTRICT 9 ENGINEER OF LOCAL ROADS & STREETS	
RELEASING FOR BID BASED ON LIMITED REVIEW	FEB 13 20 08
DEPUTY DIRECTOR OF HIGHWAYS, REGION 5 ENGINEER	

PREPARED BY:  
CLARIDA & ZIEGLER ENGINEERING  
MARION, ILLINOIS

*Harold G. Clarida*  
HAROLD G. CLARIDA, P.E.

DATE: 2-07-08

EXPIRES : NOVEMBER 30, 2009

**CONTRACT NO. 99312**

ROUTE NO.	SECTION	COUNTY	TOTAL SHEETS	SHEET NO.
CH 13	07-00113-00-SP	WILLIAMSON	8	2
ILLINOIS		SOUTH MARKET STREET		

CONTRACT NO. 99312

## SUMMARY OF QUANTITIES

PAY CODE	PAY ITEM	UNITS	TOTAL QUANTITY
20200100	EARTH EXCAVATION	CU YD	3696
20800150	TRENCH BACKFILL	CU YD	6
25000200	SEEDING, CLASS 2	ACRES	0.55
25000400	NITROGEN FERTILIZER NUTRIENT	POUNDS	50
25000500	PHOSPHORUS FERTILIZER NUTRIENT	POUNDS	50
25000600	POTASSIUM FERTILIZER NUTRIENT	POUNDS	50
25100120	MULCH, METHOD 2, PROCEDURE 2	TON	1
31100100	SUB-BASE GRAN MATL TY A	TON	694
40600100	BITUMINOUS MATERIALS PRIME COAT	GALLON	1012
40603085	HMA BC IL-19.0 N70	TON	265
40603315	HMA SC "C" N70	TON	117
50105220	PIPE CULVERT REMOVAL	FOOT	60
54200427	PIPE CULVERTS, TYPE 1, RCCP 12"	FOOT	90
54213657	PRECAST REINFORCED CONCRETE FLARED END SECTIONS 12"	EACH	2
67100100	MOBILIZATION	L SUM	1
70101700	TRAFFIC CONTROL AND PROTECTION	L SUM	1
* 78001110	PAINT PAVEMENT MARKING, LINE 4"	FOOT	2179

\*

\* Specialty Pay Item

### HMA MIXTURE REQUIREMENTS

LOCATIONS:	HOT MIX ASPHALT SURFACE COURSE
MIXTURE USES:	HOT MIX ASPHALT SURFACE COURSE, MIX C, N70
AC/PG:	PG64-22
RAP% (MAX)	10
DESIGN AIR VOIDS:	4.0%, 70 GYRATION
MIXTURE COMPOSITION: (GRADATION MIXTURE)	IL 9.5 mm or IL 12.5 mm
FRICITION AGGREGATE:	C SURFACE

LOCATIONS:	HOT MIX ASPHALT BINDER COURSE
MIXTURE USES:	HOT MIX ASPHALT BINDER COURSE, N70, IL-19.0
AC/PG:	PG64-22
RAP% (MAX)	15
DESIGN AIR VOIDS:	4.0%, 70 GYRATION
MIXTURE COMPOSITION: (GRADATION MIXTURE)	IL-19.0 mm
FRICITION AGGREGATE:	NONE

INDEX OF SHEETS	
SH. NO.	DESCRIPTION
1	COVER SHEET
2	SUMMARY OF QUANTITIES
3	TYPICAL SECTION
4	DETOUR ROUTES
5	PLAN AND PROFILE
6	INTERSECTION DETAILS
7-8	CROSS-SECTIONS
STANDARDS	
420001-07	PAVEMENT JOINTS
542301-01	PRECAST REINFORCED CONCRETE FLARED END SECTIONS
701001	TRAFFIC CONTROL DEVICES
720001	SIGN PANEL MOUNTING DETAILS
720005-01	SIGN PANEL ERECTION DETAILS
720011	METAL POSTS FOR SIGNS, MARKERS AND DELINEATORS
729001	APPLICATIONS OF TYPES A AND B METAL POSTS (FOR SIGNS & MARKERS)
780001-01	TYPICAL PAVEMENT MARKINGS
BLR 21-7	TYPICAL APP. OF TRAFFIC CONTROL DEVICES
BLR 22-5	TY. APP. OF TRAFFIC CONTROL DEVICES
BLR 24-1	MAILBOX TURNOUTS
BLR 25	TYPE 1A BARRICADE

NOTE: USE LATEST STANDARDS LOCATED IN SPECIAL PROVISIONS.

### GENERAL NOTES

WHERE SECTION OR SUBSECTION MONUMENTS ARE ENCOUNTERED, THE ENGINEER SHALL BE NOTIFIED BEFORE SUCH MONUMENTS ARE REMOVED. THE CONTRACTOR SHALL PROTECT AND CAREFULLY PRESERVE ALL PROPERTY MARKERS AND MONUMENTS UNTIL THE OWNER, AN AUTHORIZED SURVEYOR, OR AGENT HAS WITNESSED OR OTHERWISE REFERENCE THEIR LOCATION. THE CONTRACTOR WILL BE RESPONSIBLE FOR HAVING AN AUTHORIZED SURVEYOR REESTABLISH ANY SECTION OR SUBSECTION MONUMENTS DESTROYED BY HIS OPERATIONS.

FACTORS USED FOR QUANTITY CALCULATIONS ARE AS FOLLOWS:  
 ALL BITUMINOUS CONCRETE 115 LB/SQ YD/INCH  
 ALL AGGREGATE 2.0 TON/CU YD  
 BITUMINOUS MATERIAL 0.5 GALLON/SQ YD

TRAFFIC CONTROL SHALL BE IN ACCORDANCE WITH THE APPLICABLE STANDARDS AS INCLUDED WITH THE CONTRACT DOCUMENTS, EXCEPT AS MODIFIED IN THE PLANS AND AS DIRECTED BY THE ENGINEER.

THE FOLLOWING UTILITY COMPANIES HAVE FACILITIES WITHIN THE LIMITS OF CONSTRUCTION. ADJUSTMENTS IN UTILITY LOCATIONS WILL BE MADE BY THE OWNER, UNLESS OTHERWISE NOTED ON THE PLANS.

**ELECTRIC & GAS**  
 AMEREN/CIPS  
 1800 W. MAIN ST.  
 MARION, ILLINOIS 62959  
 618-993-3311

**SOUTHEASTERN ILLINOIS ELECTRIC CO-OP**  
 11543 LAKE OF EGYPT ROAD  
 MARION, IL 62959  
 618-273-2811

**TELEPHONE**  
 VERIZON  
 1109 NORTH CARBON ST.  
 MARION, ILLINOIS 62959  
 618-997-0663

**WATER & SEWER**  
 LAKE OF EGYPT WATER DISTRICT  
 11484 LAKE OF EGYPT ROAD  
 MARION, ILLINOIS 62959  
 618-984-1380  
 SEWER DEPT. 618-993-5663

THE DISTRICT BUREAU OF OPERATIONS SHALL BE NOTIFIED AT LEAST 10 DAYS PRIOR TO PLACEMENT OF THE FINAL PAVEMENT MARKINGS. UTILITIES ARE SHOWN IN ACCORDANCE WITH THE BEST AVAILABLE INFORMATION AND THEIR TRUE LOCATIONS ARE NOT GUARANTEED TO BE AS SHOWN IN THE PLANS.

THE "STANDARD SPECIFICATIONS FOR ROAD AND BRIDGE CONSTRUCTION", ADOPTED JANUARY 1, 2007 BY THE ILLINOIS DEPARTMENT OF TRANSPORTATION, SHALL GOVERN THIS WORK.

STATE OF ILLINOIS PROFESSIONAL DESIGN FIRM LICENSE NO. 184-004515											
© 2007 ALL RIGHTS RESERVED											
<b>CLARIDA &amp; ZIEGLER ENGINEERING CO.</b>											
308 South Court St, P.O. Box 937 Marion, Illinois 62959 Phone - (618)993-5411, Fax - (618)993-6750											
<b>SOUTH MARKET STREET SAFETY PROJECT</b> SOUTH MARKET STREET MARION, IL											
<table border="1" style="width: 100%;"> <tr> <th colspan="2">REVISIONS</th> </tr> <tr> <th>DATE</th> <th>NO.</th> </tr> <tr> <td>2/13/08</td> <td>3</td> </tr> <tr> <td> </td> <td> </td> </tr> <tr> <td> </td> <td> </td> </tr> </table>		REVISIONS		DATE	NO.	2/13/08	3				
REVISIONS											
DATE	NO.										
2/13/08	3										
Date: 7/31/07	DR. By: ACR										
Scale: NONE	Job No. 07067										
Sheet No. 2	of 8										

ADDED MOBILIZATION PAY ITEM

ROUTE NO.	SECTION	COUNTY	TOTAL SHEETS	SHEET NO.
CH 13	07-00113-00-SP	WILLIAMSON	8	3
ILLINOIS		SOUTH MARKET STREET		

CONTRACT NO. 88312

PROP. ROW  
STA 163+84 TO STA 167+83.14

GRADING EASEMENT  
STA 163+34 TO STA 166+85

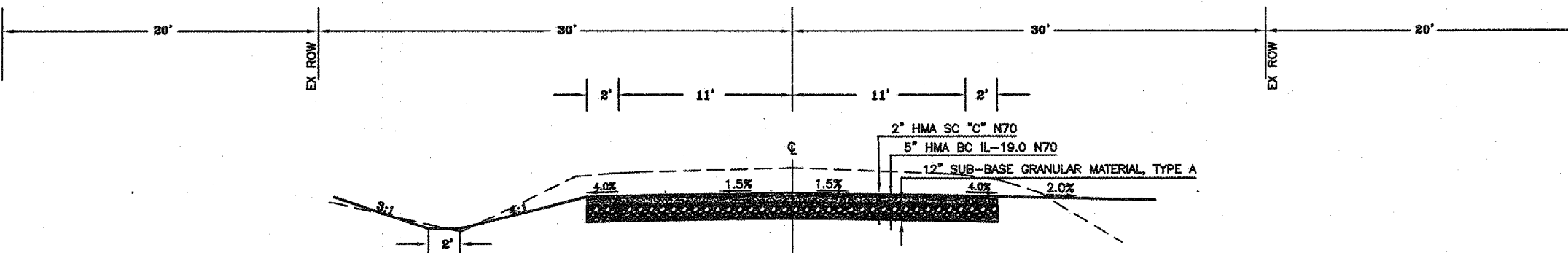

## SOUTH MARKET STREET

STA 161+98.09 TO 168+32.21

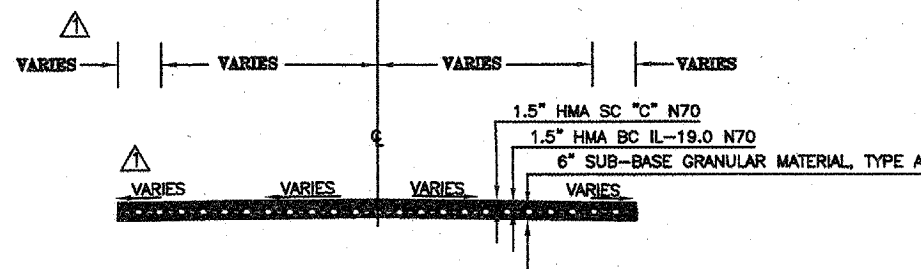

## QUARTERHORSE ROAD

STA 0+10.98 TO 0+72.58

STATE OF ILLINOIS PROFESSIONAL DESIGN FIRM LICENSE NO. 184-004515	
© 2007 ALL RIGHTS RESERVED	
<b>CLARIDA &amp; ZIEGLER</b> ENGINEERING CO.	
308 South Court St., P.O. Box 837 Marion, Illinois 62959 Phone - (618)993-6411, Fax - (618)993-6750	
SOUTH MARKET STREET SAFETY PROJECT SOUTH MARKET STREET MARION, ILLINOIS	
Date: 7/18/07	DR. By: ACR CKD By: HGC
Scale: 1"=4'	Job No. 07067 Sheet No. 3 of 8

TYPICAL SECTIONS.DWG

ROUTE NO.	SECTION	COUNTY	TOTAL SHEETS	SHEET NO.
CH 13	07-00113-00-SP	WILLIAMSON	8	4
ILLINOIS			SOUTH MARKET STREET	
CONTRACT NO. 99312				

- (A)
  - (B)
  - (C)
  - (D)
  - (E)
  - (F)
  - (G)
  - (H)
  - (I)
- TY III BARRICADE

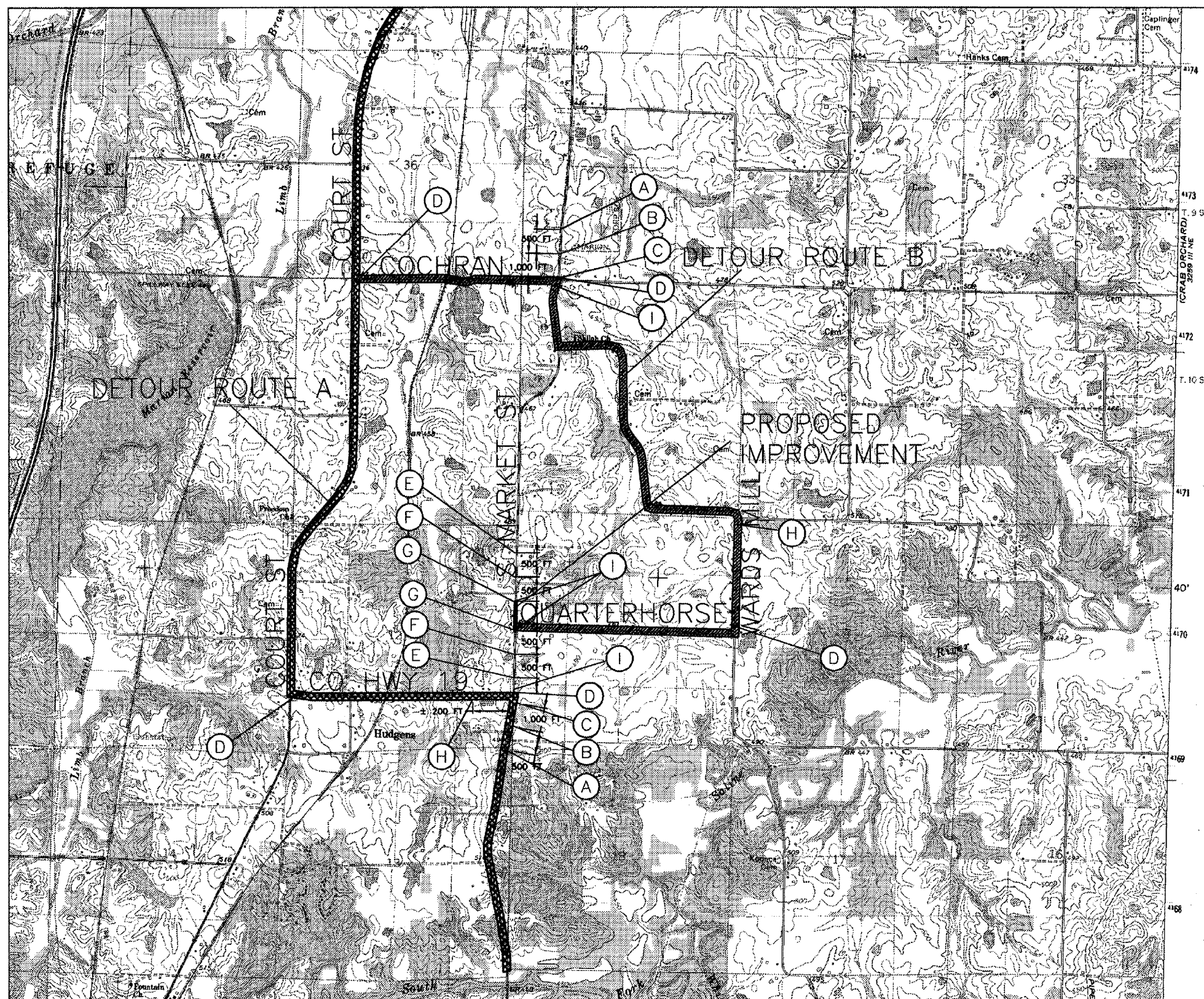

**MOTORISTS TRAVELING NORTH**

MOTORISTS TRAVELING NORTH MAY USE DETOUR ROUTE A TAKING COUNTY HIGHWAY 19 WEST AND TURN NORTH ONTO COURT ST (RTE 37) AND CONTINUE NORTH INTO MARION.

**MOTORISTS TRAVELING SOUTH**

MOTORISTS TRAVELING SOUTH MAY USE DETOUR ROUTE A TAKING COURT STREET (RTE 37) SOUTH AND TURN EAST ON COUNTY HIGHWAY 19 AND THEN SOUTH ON MARKET STREET

**MOTORISTS ALONG QUARTERHORSE**

MOTORISTS TRAVELING NORTH FROM QUARTERHORSE MAY USE DETOUR ROUTE B AND WILL TRAVEL EAST ALONG QUARTERHORSE UNTIL THEY REACH WARDS MILL ROAD. TURN NORTH AT WARDS MILL AND FOLLOW UNTIL COCHRAN ROAD IS REACHED. TURN WEST AT COCHRAN AND THEN NORTH ALONG COURT STREET (RTE 37) AND FOLLOW INTO MARION.

MOTORISTS TRAVELING SOUTH FROM QUARTERHORSE MAY USE DETOUR ROUTE B AND WILL TRAVEL EAST ALONG QUARTERHORSE UNTIL THEY REACH WARDS MILL ROAD. TURN NORTH AT WARDS MILL AND FOLLOW UNTIL COCHRAN ROAD IS REACHED. TURN WEST AT COCHRAN AND THEN SOUTH ALONG COURT STREET (RTE 37) AND CONTINUE SOUTH OUT OF TOWN.

**NOTES**

ALL TRAFFIC CONTROL DEVICES SHALL CONFORM TO THE MANUAL ON UNIFORM TRAFFIC CONTROL AND IDOT'S STANDARD SPECIFICATIONS FOR ROAD AND BRIDGE CONSTRUCTION ADOPTED JANUARY 1, 2007.

# DETOUR ROUTES

NOT TO SCALE

STATE OF ILLINOIS PROFESSIONAL DESIGN FIRM LICENSE NO. 184-004515	
© 2007 ALL RIGHTS RESERVED	
<b>CLARIDA &amp; ZIEGLER ENGINEERING CO.</b> 308 South Court St, P.O. Box 937 Marion, Illinois 62959 Phone - (618)993-6411, Fax - (618)993-6750	
<b>SOUTH MARKET STREET SAFETY PROJECT</b> SOUTH MARKET STREET MARION, IL	
Date	7/27/07
DR. By	ACR
Ck'D By	HGC
Scale	NONE
Job No.	07067
Sheet No.	4 of 8

# LEGEND

- PROP CENTERLINE
- EDGE OF SHOULDER
- - - - - ROW
- x-x-x- FENCE
- |--- 4" WATER LINE
- UGT- UNDERGROUND TELEPHONE
- ☐ POWER POLE
- ⊙ WATER METER
- ⊗ WATER VALVE
- └ GUY WIRE
- ☼ TREE
- ▣ TELEPHONE PED.
- MB MAILBOX

NOTE 1:  
GRADE DITCH TO DRAIN

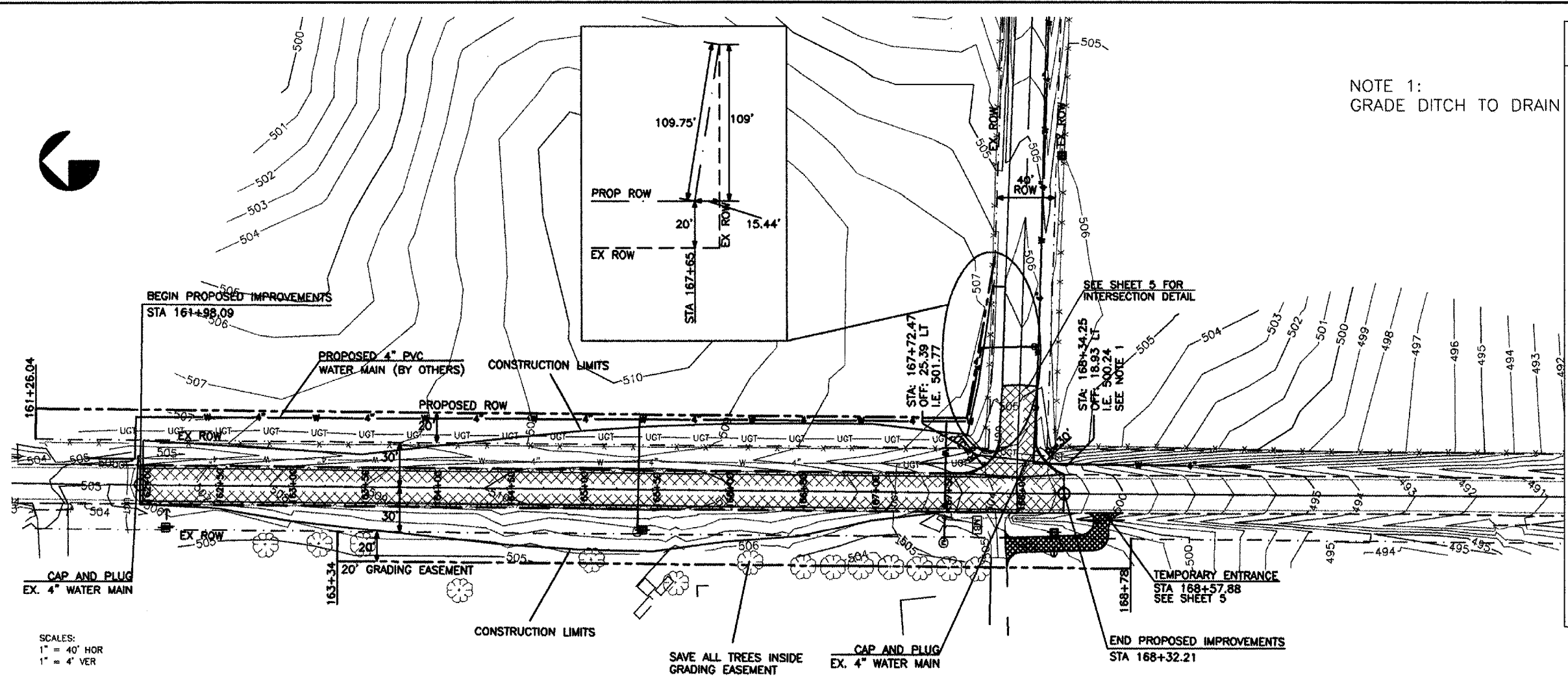

SCALES:  
1" = 40' HOR  
1" = 4' VER

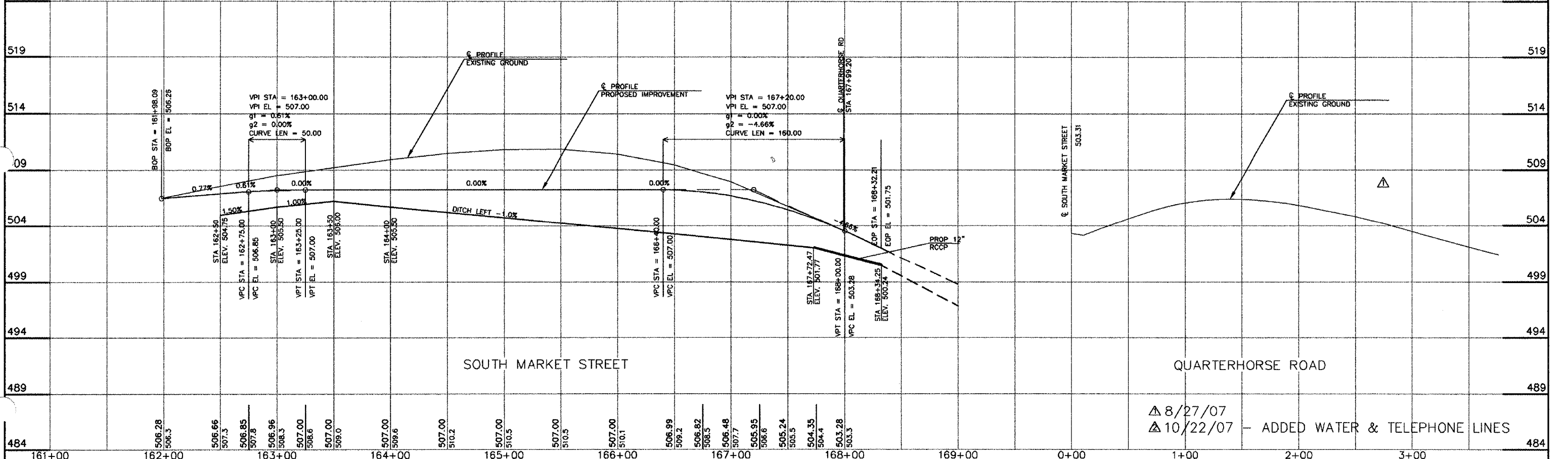

△ 8/27/07  
△ 10/22/07 - ADDED WATER & TELEPHONE LINES

ROUTE NO.	SECTION	COUNTY	TOTAL SHEETS	SHEET NO.
CH 13	07-00113-00-SP	WILLIAMSON	8	6
ILLINOIS		SOUTH MARKET STREET		

CONTRACT NO. 89312

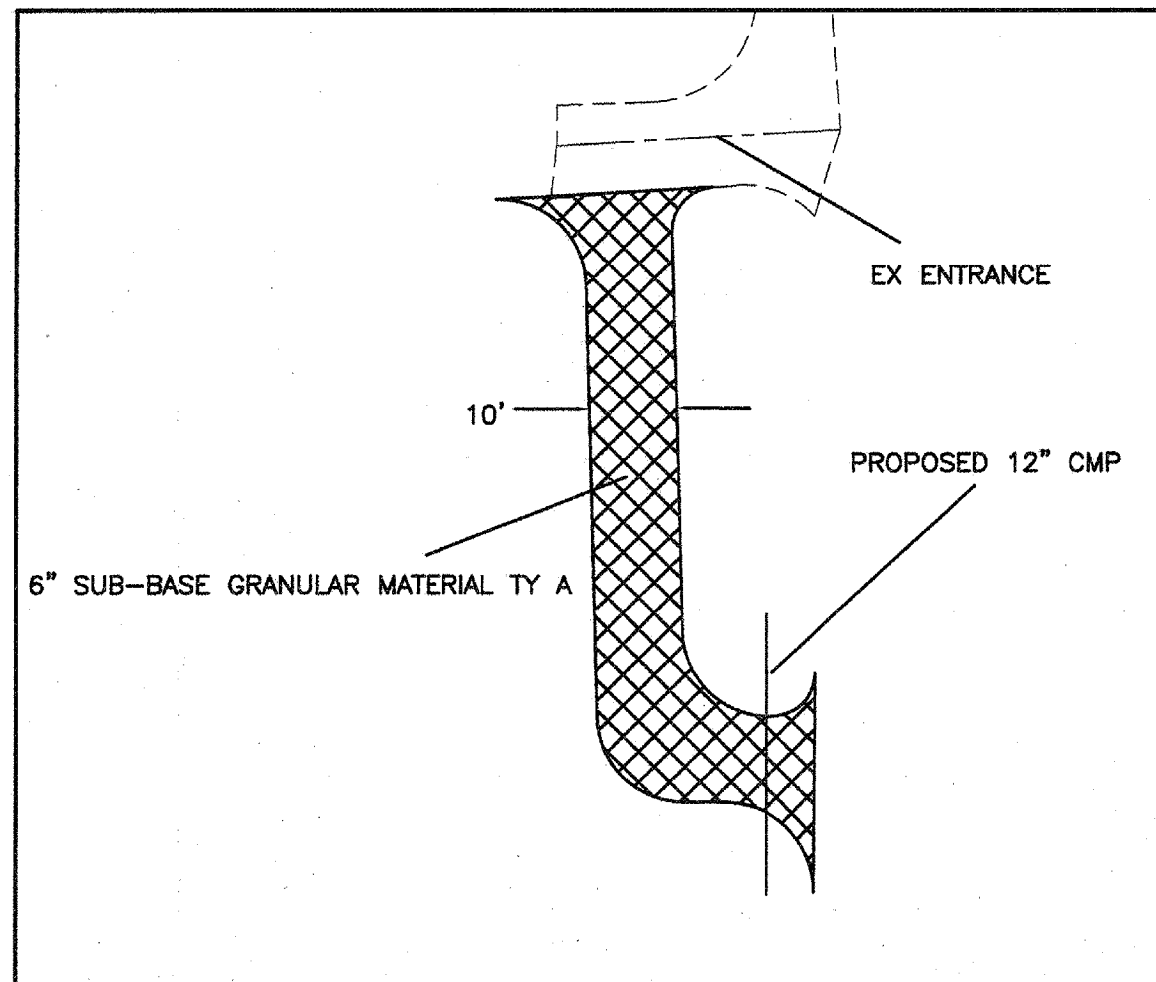

**TEMPORARY ENTRANCE**

STA 168+57.88  
SCALE: 1" = 10'

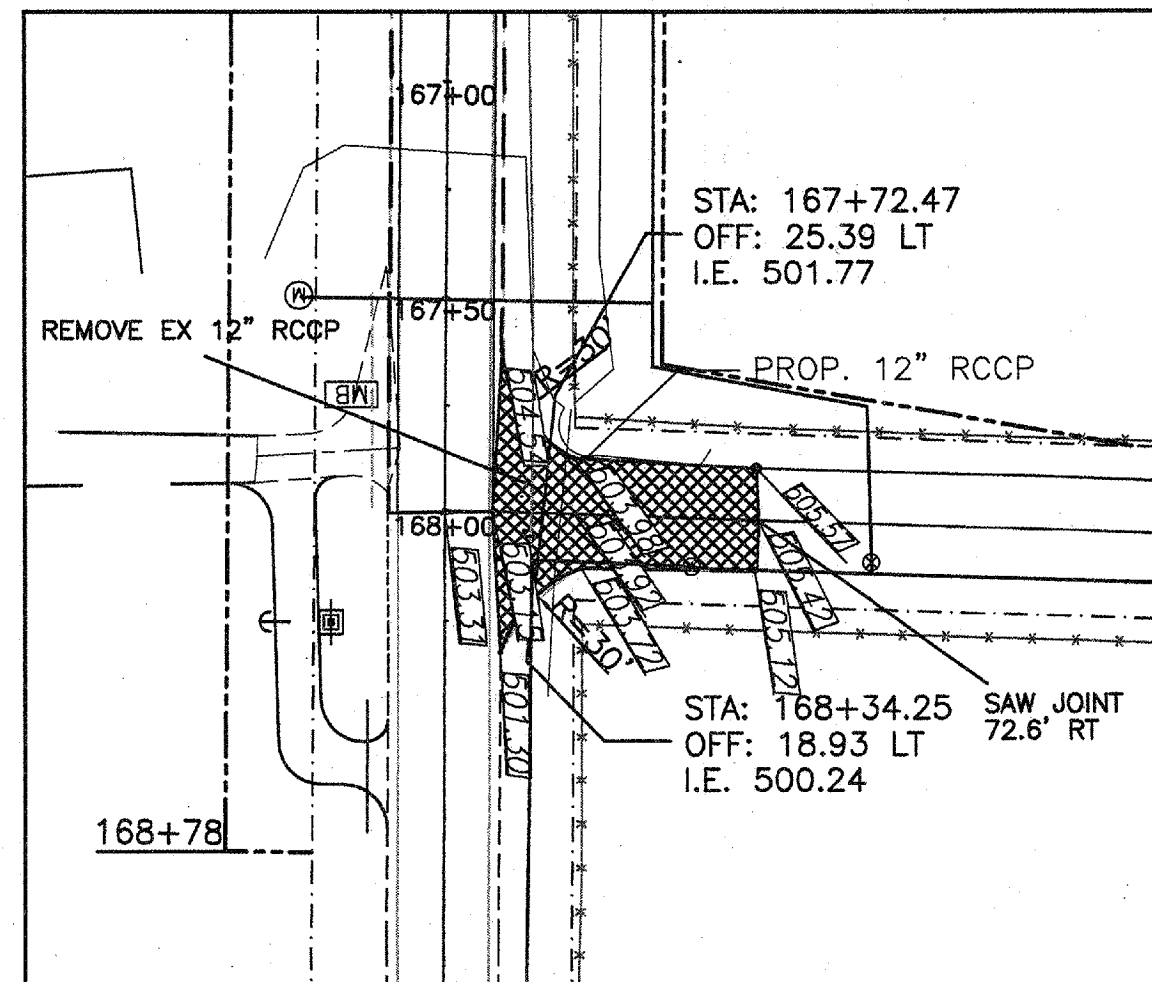

**QUARTERHORSE ROAD**

SCALE: 1" = 20'

**NOTES:**

- MATERIAL DEPTHS FOR THIS INTERSECTION SHALL BE AS FOLLOWS
  - HMA SC "C" N70 = 1.5"
  - HMA BC IL-19.0 N70 = 1.5"
  - SUB-BASE GRANULAR MATERIAL TYPE A = 6"

# INTERSECTION DETAILS

STATE OF ILLINOIS PROFESSIONAL DESIGN FIRM LICENSE NO. 184-004515		© 2007 ALL RIGHTS RESERVED	
REVISIONS		CLARIDA & ZIEGLER ENGINEERING CO.	
DATE	NO.	308 South Court St, P.O. Box 937 Marion, Illinois 62859 Phone - (618)993-6411, Fax - (618)993-6750	
		SOUTH MARKET STREET SAFETY PROJECT SOUTH MARKET STREET MARION, IL	
Date	7/26/07	DR. By	ACR
Scale	VARIES	CK'D By	HGC
Job No.	07067	Sheet No.	6 of 8

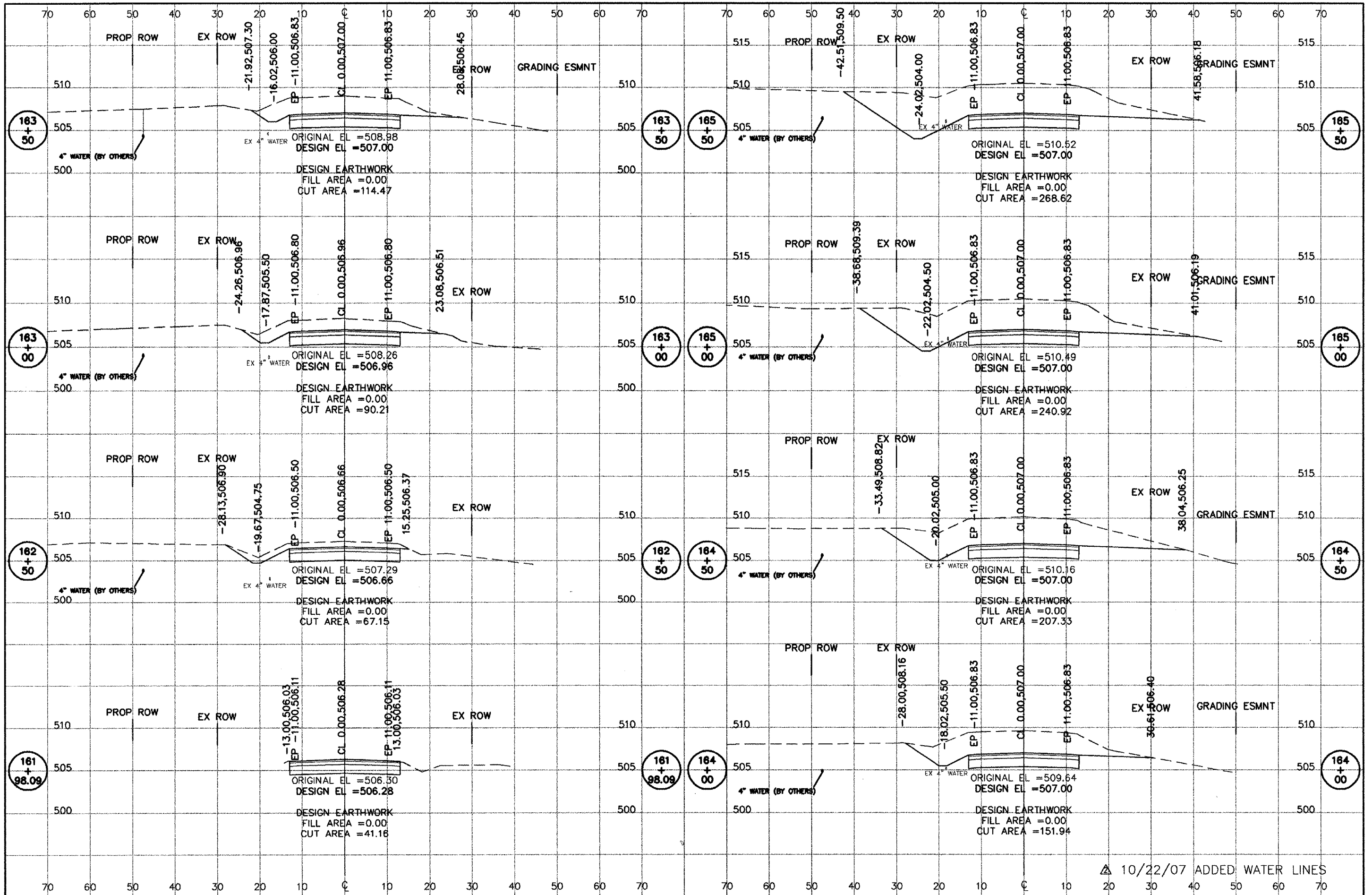

SOUTH MARKET STREET SAFETY PROJECT – SOUTH MARKET STREET – CROSS SECTIONS – STATION 161+98.09 TO 165+50

10/22/07 ADDED WATER LINES

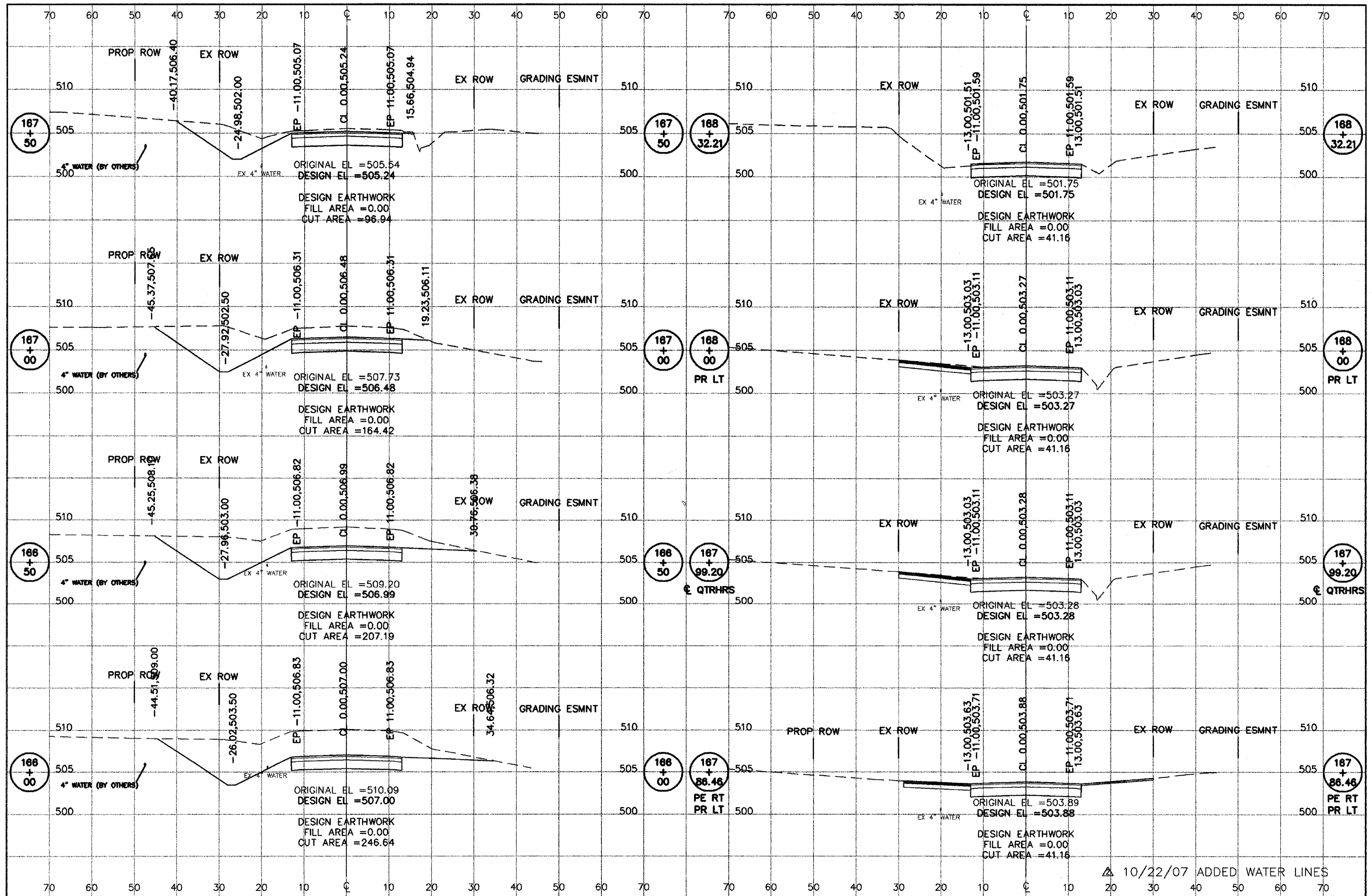

SOUTH MARKET STREET SAFETY PROJECT - SOUTH MARKET STREET - CROSS SECTIONS - STATION 166+00 TO 168+32.21

10/22/07 ADDED WATER LINES