

Hanson Professional Services Inc.  
 Suite 200, 815 Commerce Drive  
 Oak Brook, Illinois 60523  
 © Copyright Hanson Professional Services Inc. 2008

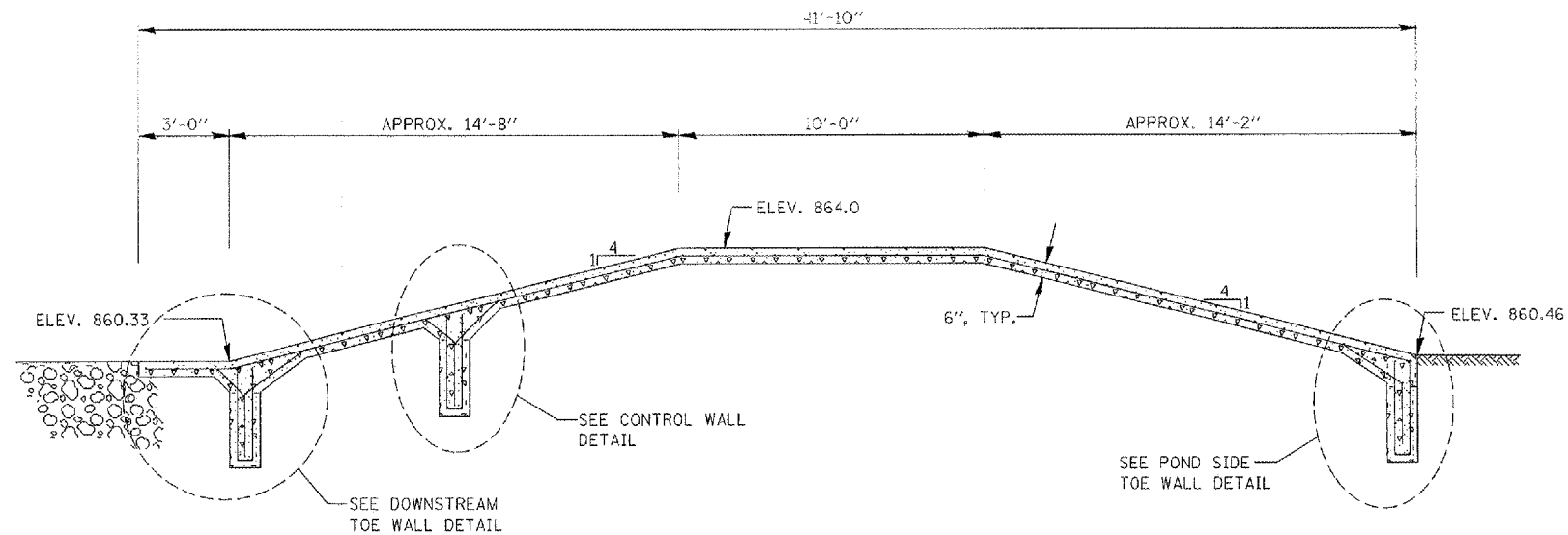

DOWNSTREAM SIDE  
SOUTH

**SPILLWAY TYPICAL CROSS SECTION**  
(SIDE WALLS OMITTED FOR CLARITY)

POND SIDE  
NORTH

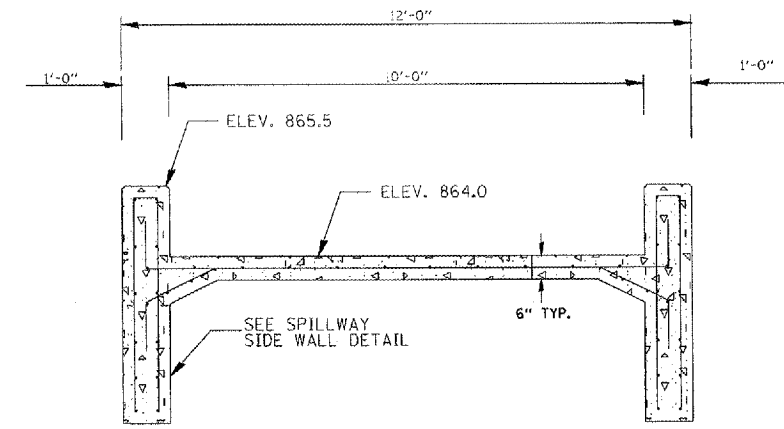

**SPILLWAY CROSS SECTION AT CREST**

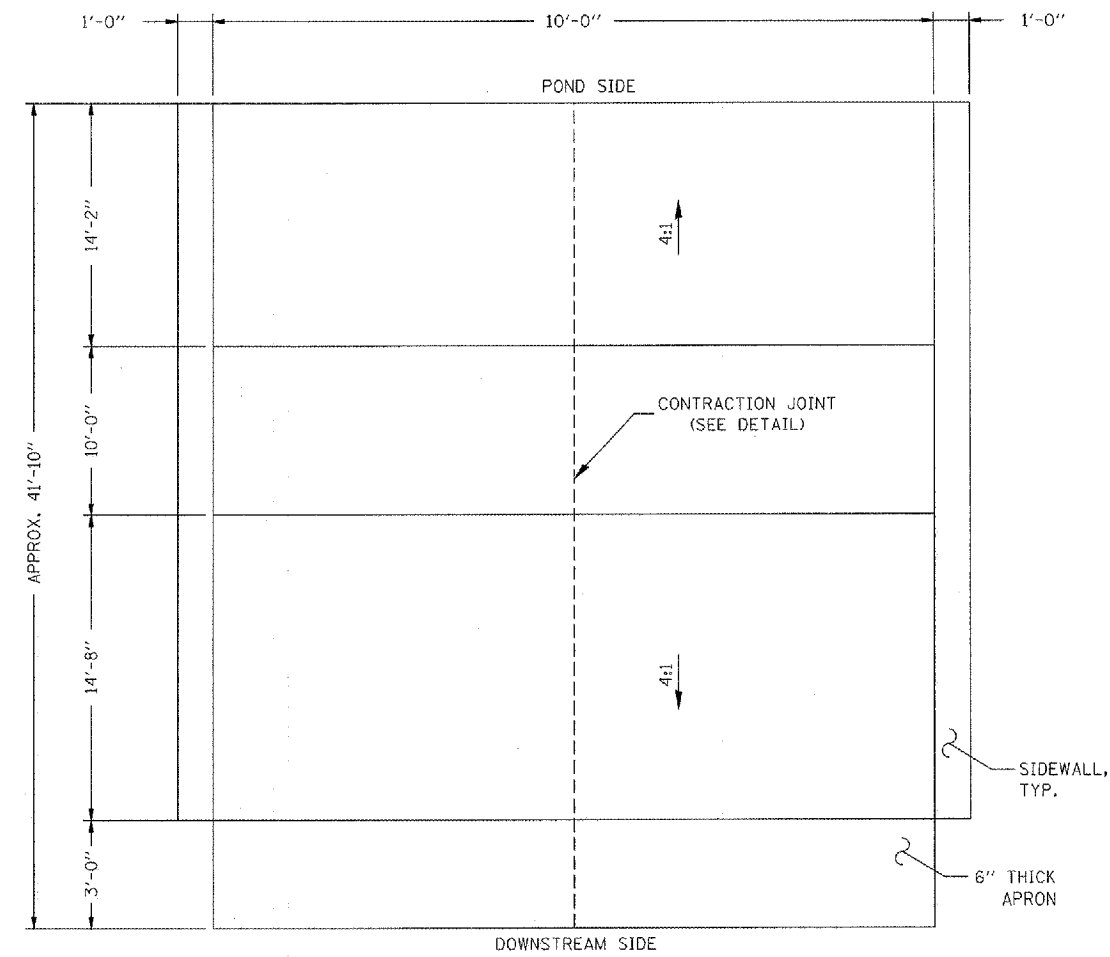

**SPILLWAY PLAN VIEW**

**CAST-IN-PLACE CONCRETE:** ALL CONCRETE SHALL BE AIR-ENTRAINED CONTAINING NOT LESS THAN 5 PERCENT AND NO MORE THAN 8 PERCENT AIR BY VOLUME.

CONCRETE SHALL BE ITEM 610 (CLASS S1) WITH AN ULTIMATE COMPRESSIVE STRENGTH OF NOT LESS THAN 3500 PSI IN 14 DAYS. MAXIMUM SIZE OF COURSE AGGREGATE SHALL BE ONE INCH. THE MINIMUM CONCRETE COVER ON REINFORCEMENT SHALL BE TWO INCHES UNLESS INDICATED OTHERWISE. EXPOSED CONCRETE EDGES SHALL BE BEVELLED 3/4".

KEYED CONSTRUCTION JOINTS SHALL BE ABRASIVE BLAST CLEANED TO EXPOSE AGGREGATE. THESE SURFACES SHALL BE DAMPENED BEFORE ADDITIONAL CONCRETE IS PLACED. NO ADDITIONAL CONSTRUCTION JOINTS SHALL BE INSTALLED WITHOUT PRIOR APPROVAL OF THE ENGINEER.

PRIOR TO PLACING CONCRETE, THE SUBGRADE SHALL BE COMPACTED TO 95 PERCENT OF STANDARD PROCTOR.

**REINFORCEMENT:** UNLESS NOTED OTHERWISE, STEEL BARS FOR REINFORCEMENT SHALL BE DEFORMED BILLET-STEEL BARS CONFORMING TO THE REQUIREMENTS OF THE CURRENT ASTM DESIGNATION: A615, GRADE 60 OR A706.

FABRICATION OF REINFORCEMENT SHALL BE IN ACCORDANCE WITH CHAPTER 7 OF THE CURRENT C.R.S.I. MANUAL OF STANDARD PRACTICE. THE REINFORCEMENT SHALL BE CONTINUOUS THROUGH ALL JOINTS.

REINFORCEMENT WIRE BAR SUPPORTS THAT ARE IN CONTACT WITH FORMS SHALL BE CLASS 1, PLASTIC PROTECTED, IN ACCORDANCE WITH CHAPTER 3 OF THE CURRENT C.R.S.I. MANUAL OF STANDARD PRACTICE.

**PAYMENT:** ALL WORK FOR THIS ITEM WILL BE PAID UNDER ITEM AR803010.

**ATTENTION - UTILITY NOTE**

THE IMPLIED PRESENCE OR ABSENCE OF UTILITIES IS NOT TO BE CONSTRUED BY OWNER, ENGINEER, CONTRACTOR, OR SUBCONTRACTORS TO BE AN ACCURATE AND COMPLETE REPRESENTATION OF UTILITIES THAT MAY OR MAY NOT EXIST ON THE CONSTRUCTION SITE. BURIED AND ABOVE GROUND UTILITY LOCATION, IDENTIFICATION, AND MARKING ARE THE SOLE RESPONSIBILITY OF THE CONTRACTOR. REROUTING, DISCONNECTION, PROTECTION, ETC. OF ANY UTILITIES MUST BE COORDINATED AMONG THE CONTRACTOR, UTILITY COMPANY, AND OWNER. SITE SAFETY, INCLUDING THE AVOIDANCE OF HAZARDS, ASSOCIATED WITH BURIED AND ABOVEGROUND UTILITIES REMAINS THE SOLE RESPONSIBILITY OF THE CONTRACTOR.

FILE NAME =	USER NAME = MoLeu01058	DESIGNED - SJM	REVISED -	<b>VILLAGE OF LAKE IN THE HILLS, ILLINOIS</b>	<b>PYOTT ROAD OVERFLOW SPILLWAY DETAILS</b>	COUNTY	TOTAL SHEETS	SHEET NO.
I:\05Jobs\08041\0508021\Civil Part A\Sheets\C-DRMS Spillway Details.sht	DRAWN - SJM	REVISED -	MCHENRY			120	32	
PLOT SCALE = 2.0000' / IN.	CHECKED - BLB	REVISED -						
PLOT DATE = 02/27/2008, 08:44 AM	DATE - 02/29/08	REVISED -	FEDERAL AIP NO. 5-17-0112-98			ILLINOIS	IDA NO. 3CK-3671	