

MATCH LINE STA. 132+50

MATCH LINE STA. 138+00

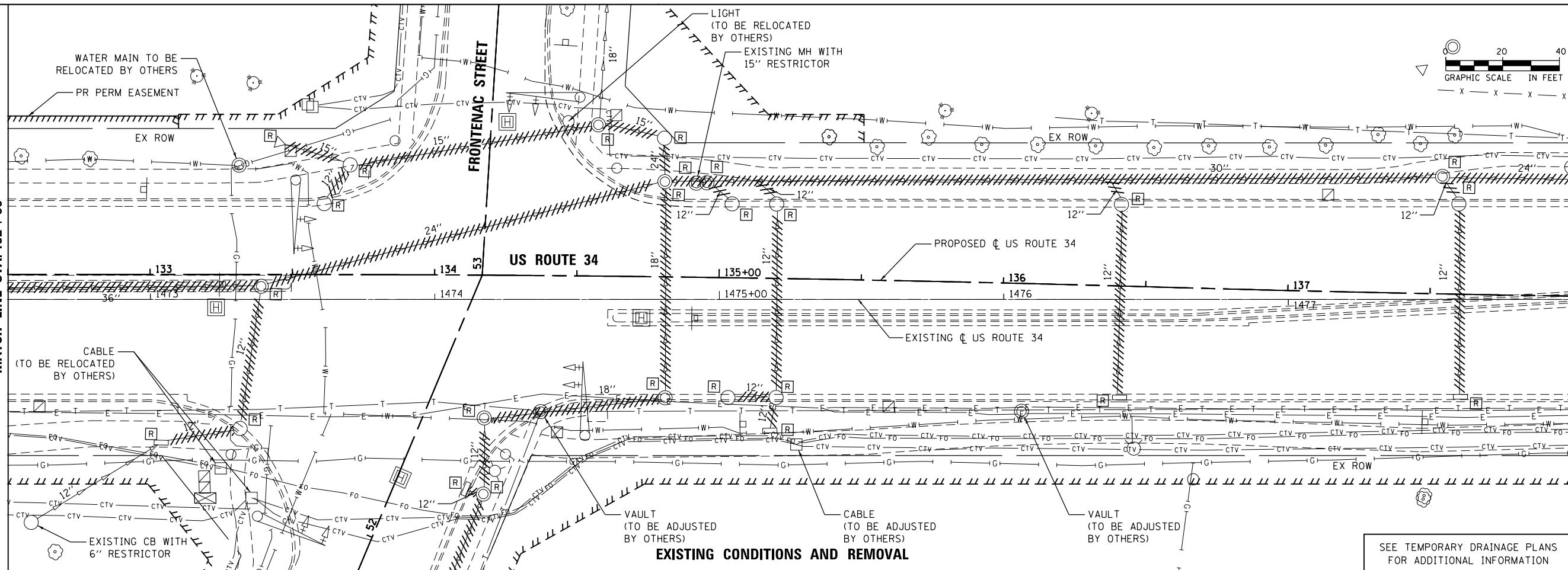

EXISTING CONDITIONS AND REMOVAL

SEE TEMPORARY DRAINAGE PLANS FOR ADDITIONAL INFORMATION

MATCH LINE STA. 132+50

MATCH LINE STA. 138+00

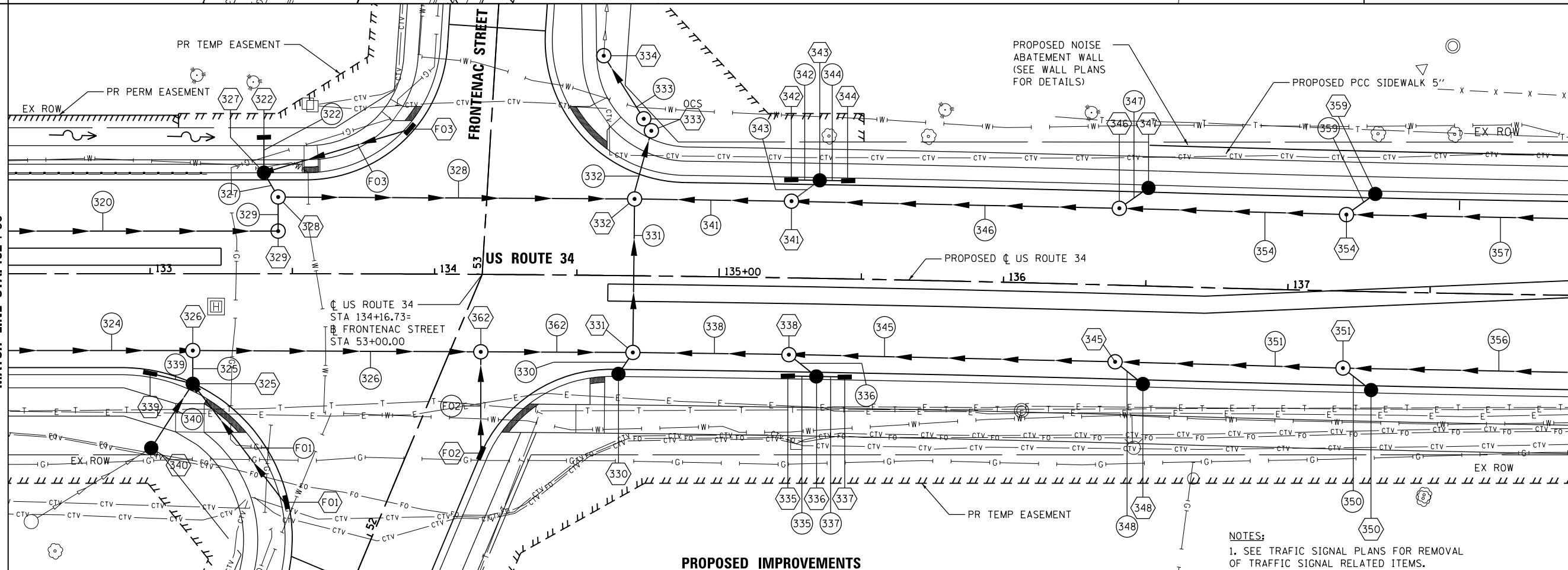

PROPOSED IMPROVEMENTS

NOTES:
1. SEE TRAFFIC SIGNAL PLANS FOR REMOVAL OF TRAFFIC SIGNAL RELATED ITEMS.



USER NAME = URS	DESIGNED - MB	REVISED -
DRAWN - KJB	REVISOR -	REVISOR -
CHECKED - SPF	REVISOR -	REVISOR -
DATE - 02/28/2014	REVISOR -	REVISOR -

**STATE OF ILLINOIS
DEPARTMENT OF TRANSPORTATION**

**DRAINAGE AND UTILITY PLAN
US ROUTE 34**

SCALE: 20 SHEET NO. 7 OF 8 SHEETS STA. 132+50 TO STA. 138+00

F.A.P. RTE. 311	SECTION 652-A	COUNTY DUPAGE	TOTAL SHEETS 383	SHEET NO. 98
CONTRACT NO. 60R06				
FED. ROAD DIST. NO. 1 ILLINOIS FED. AID PROJECT				

FILE NAME = Q:\DOT_25368367_US_34.ctb; P:\Drawings\Roadway\Drainage\Utility\1161606.ctb; sht-Dr-am_007.dgn