

Notes:  
 See sheet S-20 of S-53 for Sections C-C & D-D and View E-E.  
 $a_{11}(E)$  thru  $a_{14}(E)$  bar spacings measured along  $\text{C} \perp$  Rdwy.  
 The joint opening shall be determined per Article 520.04. The minimum dimension shall be 1 1/2" for installation purposes.

\*\*\* Cost included with Concrete Superstructure.

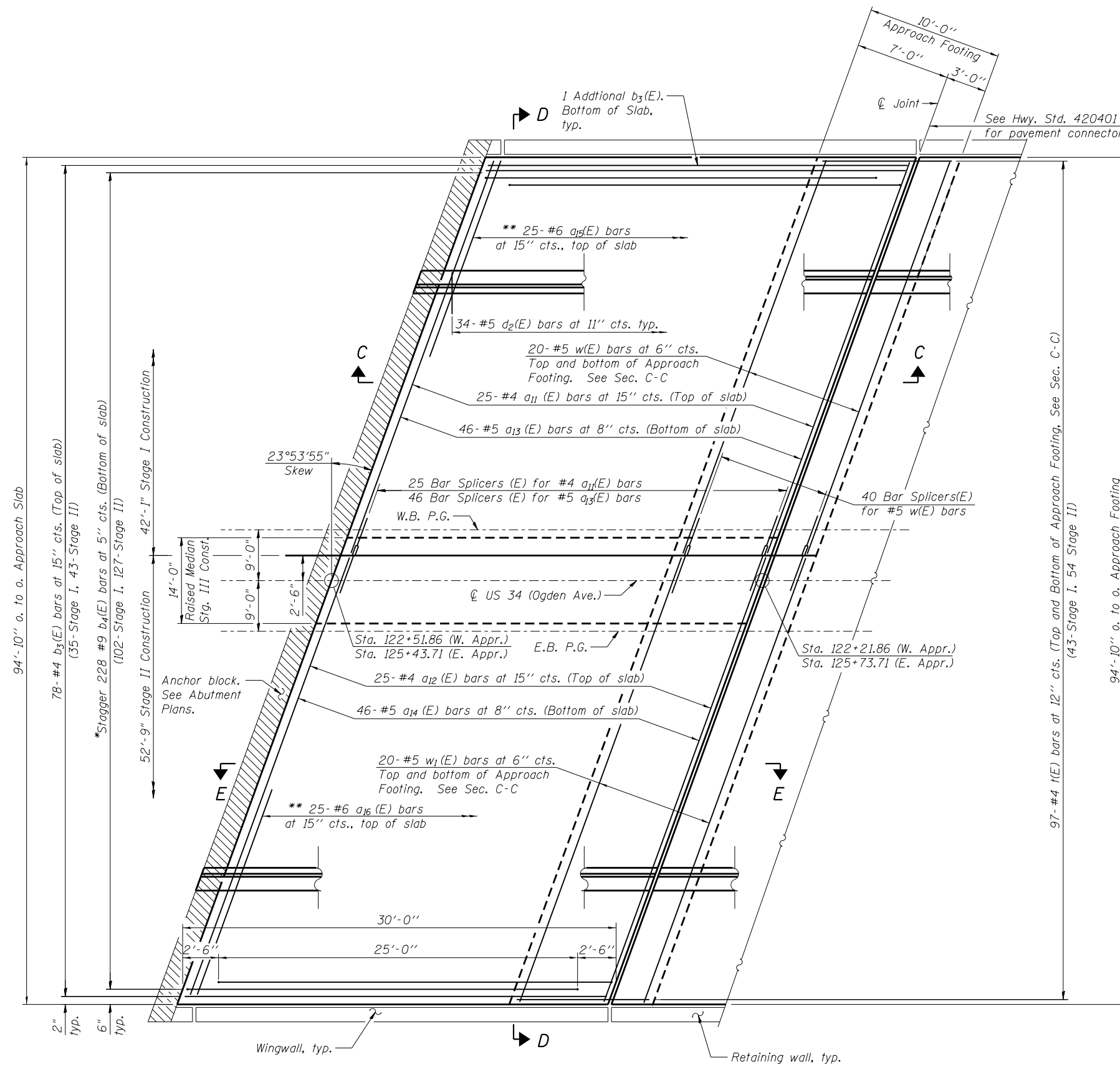

\* Tilt #9  $b_4(E)$  bars as required to maintain clearance.  
 \*\* Space between  $a_{11}(E)$  or  $a_{12}(E)$  bars, typ. each parapet.

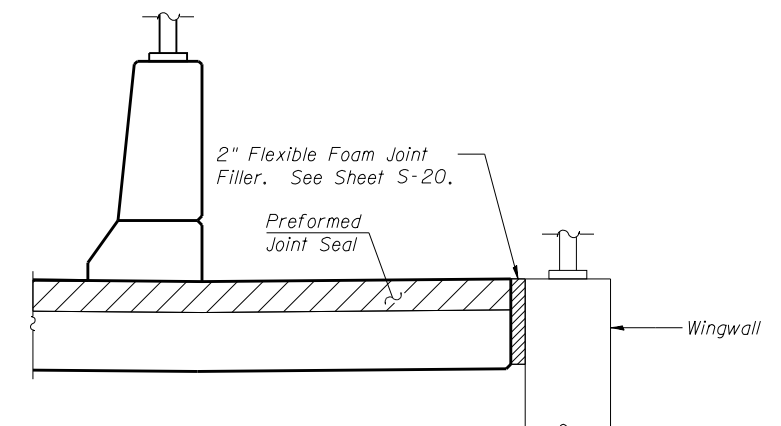
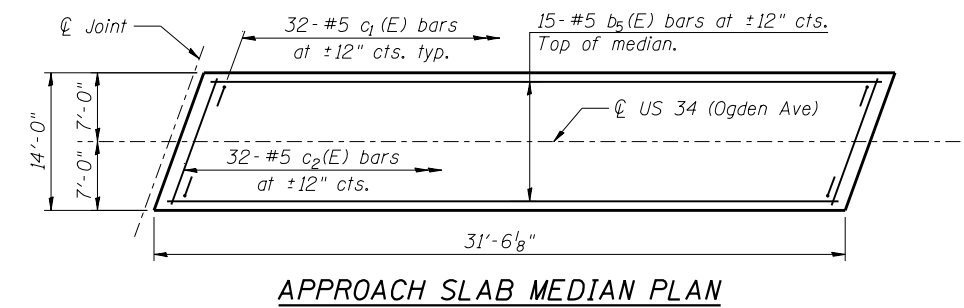
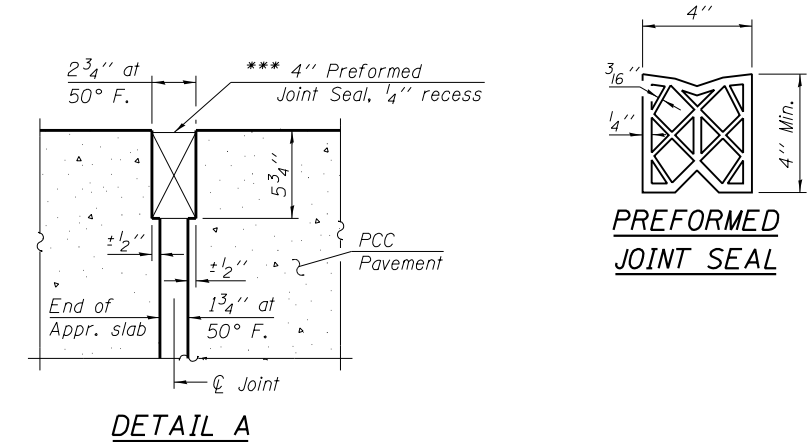

USER NAME =	DESIGNED - BAR	REVISED
	CHECKED - AMK	REVISED
PLOT SCALE =	DRAWN - BAR	REVISED
PLOT DATE = 02/28/2014	CHECKED - AMK	REVISED

STATE OF ILLINOIS  
 DEPARTMENT OF TRANSPORTATION

BRIDGE APPROACH SLAB DETAILS 1  
 STRUCTURE NO. 022-0512

SHEET NO. S-19 OF S-53 SHEETS

F.A.P. RTE.	SECTION	COUNTY	TOTAL SHEETS	SHEET NO.
311	652-A	DuPAGE	383	182
CONTRACT NO. 60R06			ILLINOIS FED. AID PROJECT	