

Benchmark: CP#3 - P.K. Rod in ground at driveway next to Nicor Gas pressure regulation station, Sta. 113+67.17, 50.22' Rt. Elev. 706.54.

Existing Structure: None. One lane of traffic in both directions to be maintained during construction utilizing stage construction and Temporary MSE Walls.

Salvage: None.

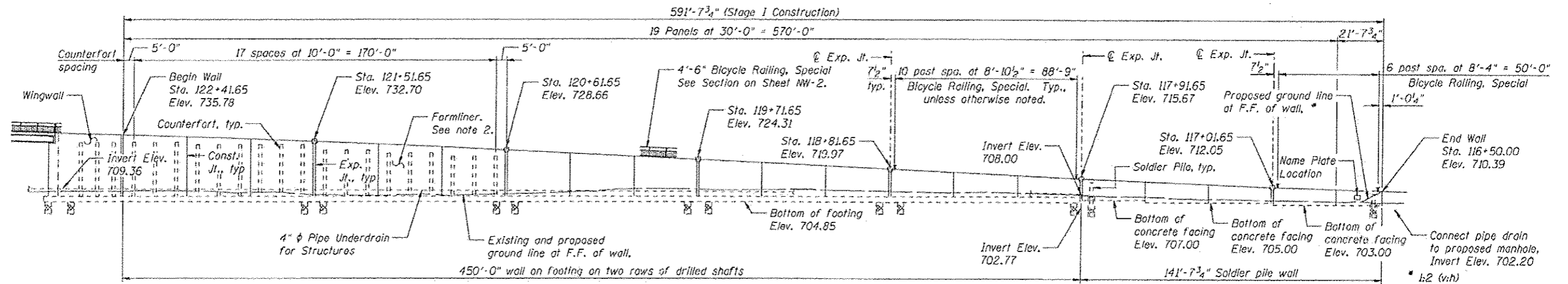

ELEVATION
(Looking South)

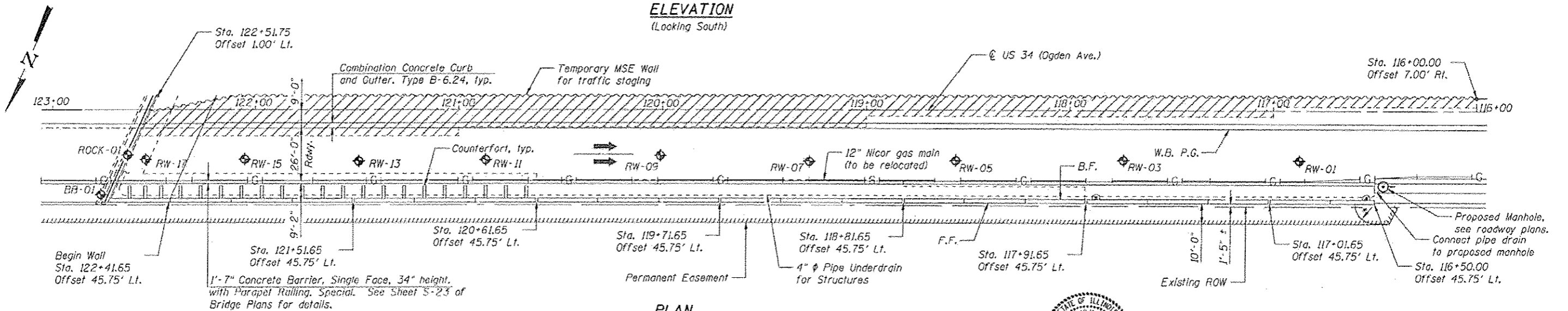

PLAN

APPROVED
For Structural Adequacy Only

Arif Carl Panyas
Engineer of Bridges & Structures

STATION 116+50.00 TO 122+41.65
BUILT 20__ BY
STATE OF ILLINOIS
F.A.P. RTE. 311 SEC. 652-A
LOADING HL-93
STR. NO. 022-W068

NAME PLATE
See Std. 515001



ARSALAN M. KHAN, S.E.
LICENSE NO.: 081-006258
EXPIRES: NOVEMBER 30, 2014
DATE: 02-26-2014

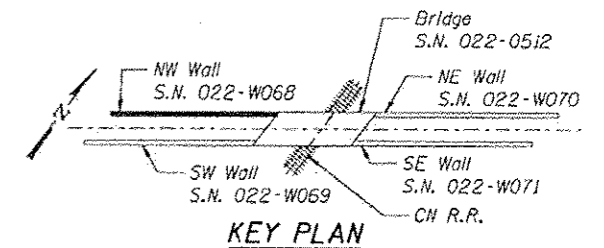

KEY PLAN

LEGEND

- ◆ Soil Boring Location
- F.F. Front Face
- B.F. Back Face
- E.B. Eastbound
- W.B. Westbound
- ▨ Limits of reinforced soil mass

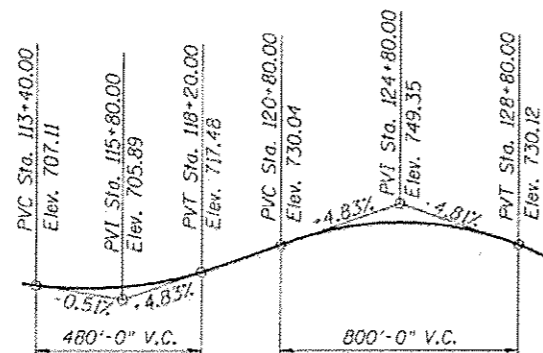

PROFILE GRADE - US 34
Along E.B. and W.B. P.G.'s

NOTES

1. All Offsets are taken from the @ US 34 to the front face of the retaining wall.
2. Form liner textured surface shall be applied to the retaining walls. The finish shall consist of a rolled Ashlar Stone finish and shall have a minimum 0.75 in Impression.

DESIGN SPECIFICATIONS
2012 AASHTO LRFD Bridge Design Specifications,
6th Edition

DESIGN STRESSES
FIELD UNITS

$f'_c = 3,500 \text{ psi}$
 $f_y = 60,000 \text{ psi (Reinforcement)}$

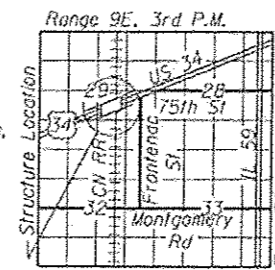

LOCATION SKETCH

GENERAL PLAN & ELEVATION
NW RETAINING WALL - US 34 (OGDEN AVE.)
F.A.P. RTE. 311 - SECTION 652-A
DUPAGE COUNTY
STA. 116+50.00 TO STA. 122+41.65
STRUCTURE NO. 022-W068



USER NAME *	DESIGNED - KMP/PMV	REVISIONS
PROJECT NO. *	CHECKED - ANK	REVISIONS
DATE *	DRAWN - PMV	REVISIONS
PLT DATE *	CHECKED - NPP	REVISIONS

STATE OF ILLINOIS
DEPARTMENT OF TRANSPORTATION

SHEET NO. NW-1 OF NW-16 SHEETS

F.A.P. RTE.	SECTION	COUNTY	TOTAL SHEETS	SHEET NO.
311	652-A	DUPAGE	393	217
			CONTRACT NO. 60R06	

ILLINOIS FED. AID PROJECT