

Benchmark: CP#3 - P.K. Rod in ground at driveway next to Nicor Gas pressure regulation station, Sta. 113+67.17, 50.22' Rt, Elev. 706.54.

Existing Structure: None. One lane of traffic in both directions to be maintained during construction utilizing stage construction and Temporary MSE Walls.

Salvage: None.

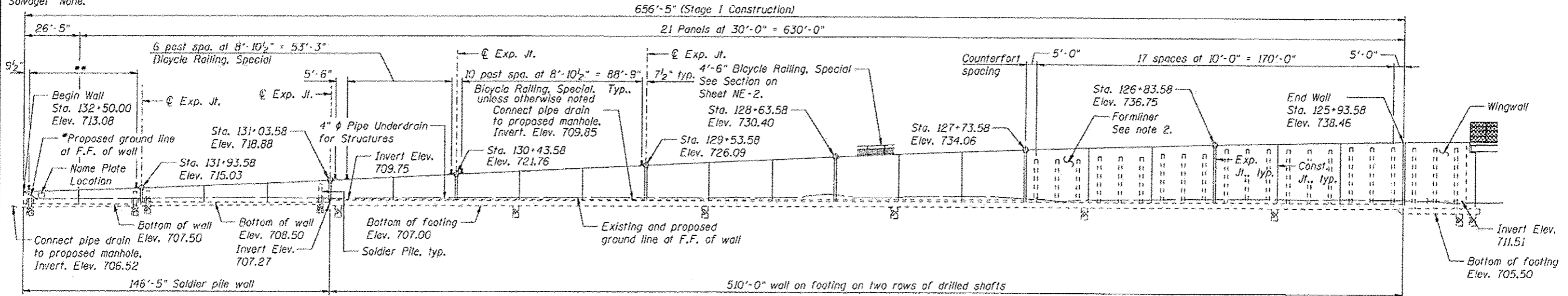

ELEVATION
(Looking South)

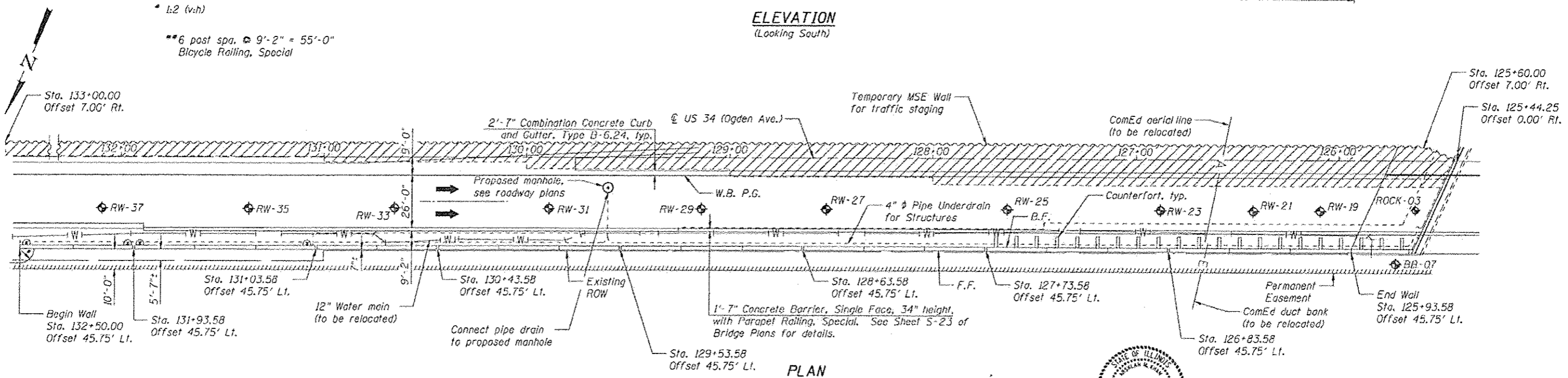

PLAN

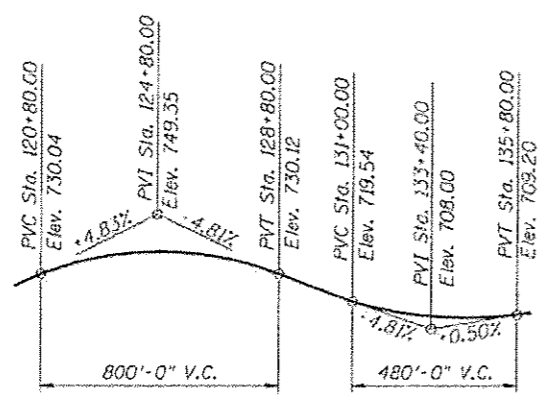

PROFILE GRADE - US 34
Along E.B. and W.B. P.G.'s

LEGEND

- ⊕ Soil Boring Location
- F.F. Front Face
- B.F. Back Face
- E.B. Eastbound
- W.B. Westbound
- ▨ Limits of reinforced soil mass

APPROVED
For Structural Adequacy Only
Dr. Carl Krueger
Engineer of Bridges & Structures

STATION 125+93.58 TO 132+50.00
BUILT 20__ BY
STATE OF ILLINOIS
F.A.P. RTE. 311 SEC. 652-A
LOADING HL-93
STR. NO. 022-W070

NAME PLATE
See Std. 515001

- NOTES**
- All Offsets are taken from the @ US 34 to the front face of the retaining wall.
 - Form liner textured surface shall be applied to the retaining walls. The finish shall consist of a rolled Ashlar Stone finish and shall have a minimum 0.75 in impression.

DESIGN SPECIFICATIONS
2012 AASHTO LRFD Bridge Design Specifications, 6th Edition

DESIGN STRESSES
FIELD UNITS
f'c = 3,500 psi
fy = 60,000 psi (Reinforcement)



Arsalan Khan
ARSALAN M. KHAN, S.E.
LICENSE NO. 081-006258
EXPIRES: NOVEMBER 30, 2014
DATE: 02-26-2014

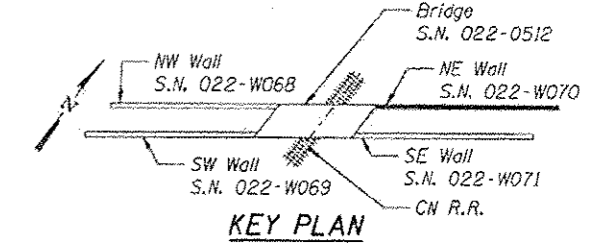
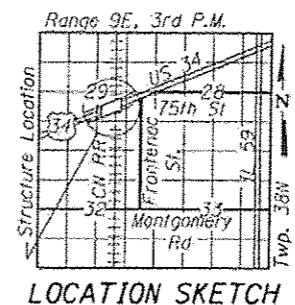

GENERAL PLAN & ELEVATION
NE RETAINING WALL - US 34 (OGDEN AVE.)
F.A.P. RTE. 311 - SECTION 652-A
DUPAGE COUNTY
STA. 125+93.58 TO STA. 132+50.00
STRUCTURE NO. 022-W070



USER NAME :	DESIGNED - KMP/PMV	REVISED
PLOT SCALE :	CHECKED - AMK	REVISED
PLOT DATE - 03/19/2014	DRAWN - PMV	REVISED
	CHECKED - AMK	REVISED

STATE OF ILLINOIS
DEPARTMENT OF TRANSPORTATION

SHEET NO. NE-1 OF NE-18 SHEETS

F.A.P. RTE. 311	SECTION 652-A	COUNTY DuPAGE	TOTAL SHEETS 383	SHEET NO. 248
			CONTRACT NO. 60R06	

ILLINOIS FED. AID PROJECT