

LEGEND

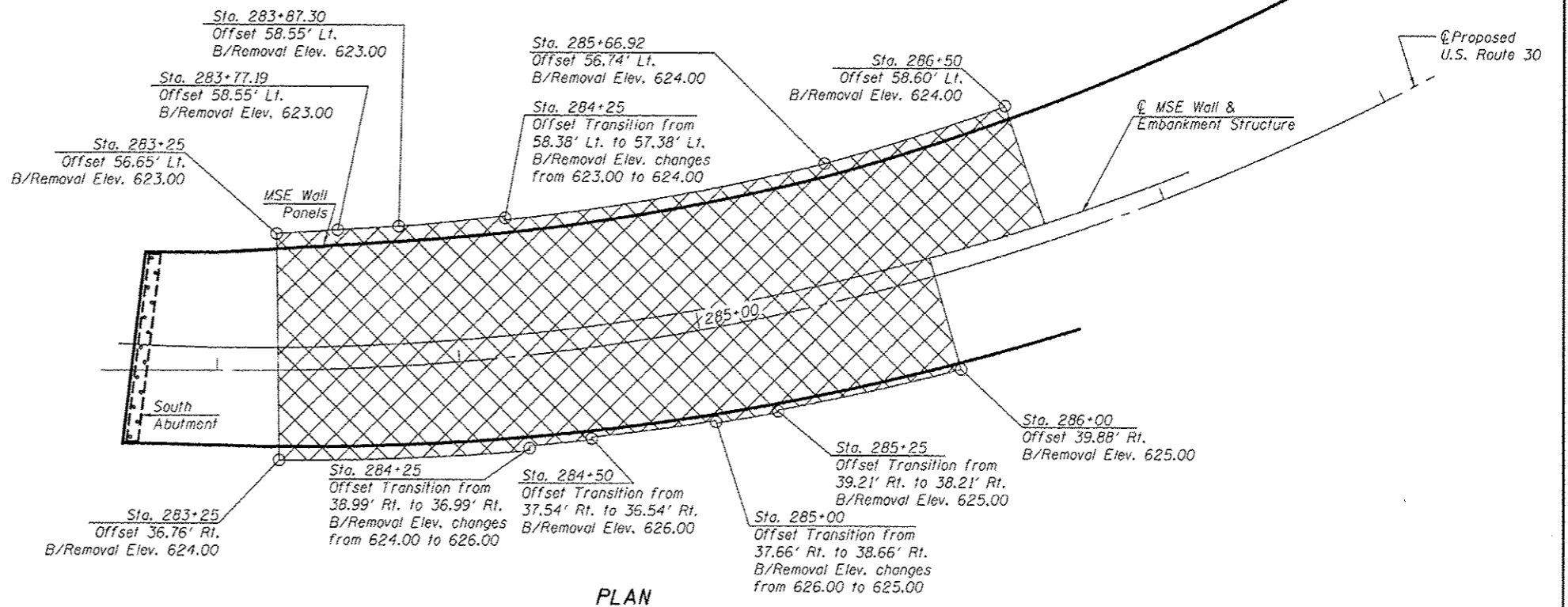

Limits of Structure Excavation and Non-Special Waste Disposal, Backfill with Aggregate Subgrade Improvement.



Notes:

The limits and quantities of Structure Excavation and Non-Special Waste Disposal shown are based on the boring data and PSI and may be modified by the Engineer for variable subsurface conditions encountered in the field.
See Sheet 8 of 25 for cross section limits of Structure Excavation and Non-Special Waste Disposal and placement of Aggregate Subgrade Improvement.

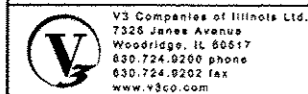

USER NAME *	DESIGNED - EVS	REVISED Δ 4/09/2014 W.J.V.
PLD ¹ SCALE *	CHECKED - WJV	REVISED
PLD ² DATE *	DRAWN - EVS	REVISED
	CHECKED - WJV	REVISED

STATE OF ILLINOIS
DEPARTMENT OF TRANSPORTATION

UNSUITABLE MATERIAL REMOVAL AND BACKFILL LAYOUT
STRUCTURE NO. 016-1280

SHEET NO. 4 OF 25 SHEETS

F.A.P. RTE.	SECTION	COUNTY	TOTAL SHEETS	SHEET NO.
353	11-Y-A	COOK	354	259
CONTRACT NO. 60R19			ILLINOIS FED. AID PROJECT	