

ITEM NO.	ITEM	UNIT	TOTAL QUANTITY	78.5% CN / 21.5% STATE						80% STATE	80% STATE
				ROADWAY	CN RR BRIDGE	3-SIDED CULVERT	TRAFFIC SIGNALS	RETAINING WALLS	BIKEPATH	SIDEWALK	
				0003	0008	0008	0021	0040	0028	0021	
	<i>URBAN</i>										
<u>20039141</u>	THREE-SIDED PRECAST CONCRETE STRUCTURES 36' X 10'	FOOT	75			75					
X5510124	STORM SEWER REMOVAL, 24" (SPECIAL)	FOOT	161	161							
X5510127	STORM SEWER REMOVAL, 27" (SPECIAL)	FOOT	169	169							
X5510130	STORM SEWER REMOVAL, 30" (SPECIAL)	FOOT	576	576							
X5510136	STORM SEWER REMOVAL, 36" (SPECIAL)	FOOT	646	646							
X5510142	STORM SEWER REMOVAL, 42" (SPECIAL)	FOOT	787	787							
X6020293	MANHOLES, TYPE A, 8" -DIAMETER, WITH 2 TYPE 1 FRAMES, CLOSED LIDS, RESTRICTOR PLATE	EACH	1	1							
A2006716	TREE, QUERCUS MACROCARPA (BUR OAK), 2" CALIPER, BALLED AND BURLAPPED	EACH	11	11							
B2006123	TREE, SYRINGA PEKINENSIS ZHANG ZHIMING (BEIJING GOLD PEKING LILAC), 2" CALIPER, TREE FORM, BALLED AND BURLAPPED	EACH	27	27							
20076600	TRAINEES	HR	3000	3000							
20076604	TRAINEES - TRAINING PROGRAM GRADUATE	HR	3000	3000							
* A2005616	TREE, OSTRYA VIRGINIANA (AMERICAN HOPHORNBEAM), 2" CALIPER, BALLED AND BURLAPPED	EACH	5	5							
* B2000766	TREE, AMELANCHIER X GRANDIFLORA AUTUMN BRILLIANCE (AUTUMN BRILLIANCE SERVICE BERRY) 6' HEIGHT, SHRUB FORM, BALLED AND BURLAPPED	EACH	15	15							
* B2006366	TREE, SYRINGA RETICULATA IVORY SILK (IVORY SILK JAPANESE TREE LILAC), 6' HEIGHT, CLUMP FORM, BALLED AND BURLAPPED	EACH	10	10							

* SPECIALTY ITEM ϕ 0042

Rev. 4-16-14

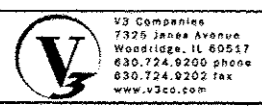

USER NAME : hahah	DESIGNED - DSS	REVISED -
PLOT SCALE : 1/8" = 1' in.	DRAWN - DRP	REVISED -
PLOT DATE : 8/21/2013	CHECKED - VJD	REVISED -
	DATE - 08/14/2013	REVISED -

STATE OF ILLINOIS
DEPARTMENT OF TRANSPORTATION

SUMMARY OF QUANTITIES

SCALE: N/A SHEET NO. 15 OF 15 SHEETS

F.A.P. RTE. 353	SECTION 11-Y-A	COUNTY COOK	TOTAL SHEETS 354	SHEET NO. 18
CONTRACT NO. 60R19				
ILLINOIS FED. AID PROJECT				

Rev.

MAINTENANCE OF TRAFFIC GENERAL NOTES

1. TYPE I OR II BARRICADES AND VERTICAL PANELS SHALL BE EQUIPPED WITH MONO-DIRECTIONAL STEADY BURN AMBER LIGHTS FOR MULTILANE SECTIONS, BI-DIRECTIONAL STEADY BURN AMBER LIGHTS FOR TWO LANE AND TWO-WAY SECTIONS AND SHALL BE PLACED AT 50 FOOT INTERVALS ALONG THE PROPOSED WORK ZONE, 25 FOOT INTERVALS IN TAPER SECTIONS, AND 10 FOOT INTERVALS AROUND RADII AS SHOWN ON THE PLANS OR AS DIRECTED BY THE ENGINEER. BARRICADES WITH LEG EXTENSIONS SHALL BE USED WHERE NEEDED TO PROVIDE A MINIMUM DISTANCE OF 36" BETWEEN THE PAVEMENT AND TOP OF BARRICADE, ONLY DIRECTION INDICATOR BARRICADES SHALL BE USED IN LANE CLOSURE TAPERS, AND THEY SHALL NOT USED ELSEWHERE.
2. THE CONTRACTOR SHALL MAINTAIN ACCESS TO ALL PROPERTIES AND SIDE ROADS DURING CONSTRUCTION OPERATIONS. A QUANTITY OF "TEMPORARY ACCESS (PRIVATE ENTRANCE)", "TEMPORARY ACCESS (COMMERCIAL ENTRANCE)", AND "TEMPORARY ACCESS (ROAD)" HAS BEEN INCLUDED IN THE CONTRACT FOR THIS PURPOSE.
3. ADVANCE WARNING SIGNS SHALL BE MAINTAINED THROUGH ALL STAGES OF CONSTRUCTION.
4. THE CONTRACTOR SHALL INFORM THE ENGINEER OF ANY CHANGE IN STAGING AT LEAST TWO (2) WORKING DAYS IN ADVANCE. NO STAGING CHANGES CAN BE MADE AT THE GRADE CROSSING WITHOUT REVIEW AND APPROVAL FROM ILLINOIS COMMERCE COMMISSION, IDOT, AND RAILROAD.
5. THE TEMPORARY TRAFFIC SIGNAL AT THE INTERSECTION OF U.S. ROUTE 30 AND SAUK TRAIL SHALL BE OPERATIONAL PRIOR TO STAGE 1 CONSTRUCTION COMMENCING.
6. THE CONTRACTOR SHALL NOTIFY ALL MUNICIPALITIES, EMERGENCY SERVICES, AND SCHOOL DISTRICTS THAT WILL BE AFFECTED BY ANY ROAD CLOSURES OR DETOURS 72 HOURS PRIOR TO THEIR IMPLEMENTATION.
7. THE CONTRACTOR SHALL BE REQUIRED TO REMOVE ALL EXISTING PAVEMENT MARKINGS WHICH CONFLICT WITH THE DESIGNATED TRAFFIC CONTROL PLAN. THIS WORK SHALL BE PAID FOR AS "PAVEMENT MARKING REMOVAL" PER SQUARE FOOT.
8. REMOVAL OF TEMPORARY PAVEMENT MARKINGS WHERE REQUIRED SHALL BE PAID FOR AS "WORK ZONE PAVEMENT MARKING REMOVAL".
9. ARROW BOARDS WILL BE REQUIRED WHEN IMPLEMENTING ALL LANE CLOSURES, AND SHALL BE CONSIDERED AS PART OF THE PAY ITEM "TRAFFIC CONTROL AND PROTECTION, (SPECIAL)".
10. FOR DAILY LANE CLOSURES OF ONE THRU TRAFFIC LANE ON US ROUTE 30 FOR ANY REASON SHALL BE RESTRICTED TO THE WEEKDAY HOURS OF 7:00 AM TO 3:00 PM UNLESS OTHERWISE ALLOWED BY THE ENGINEER.
11. THE CONTRACTOR SHALL MAINTAIN DRAINAGE OF THE ROADWAY DURING ALL STAGES OF CONSTRUCTION. THE MOT PLANS PROVIDE ADDITIONAL DIRECTION TO RETROFIT OR INSTALL ADDITIONAL STORM SEWER EQUIPMENT TO DRAIN THE TEMPORARY PAVEMENT AND WORK AREA.
12. TYPE III BARRICADES ARE TO BE PLACED IN ACCORDANCE WITH STANDARD 701901-02 UNLESS AUTHORIZED BY THE ENGINEER TO USE AN ALTERNATE ARRANGEMENT. BARRICADES ARE TO BE INCIDENTAL TO "TRAFFIC CONTROL PROTECTION (SPECIAL)". ALL TYPE III BARRICADES SHALL HAVE TWO (2) FLASHING AMBER LIGHTS.
13. THE FIRST TWO WARNING SIGNS IN EACH DIRECTION OF TRAVEL SHALL BE EQUIPPED WITH MONO-DIRECTIONAL HIGH-INTENSITY AMBER FLASHING LIGHTS DURING HOURS OF DARKNESS. FLAGS ARE OPTIONAL.
14. W21-1a SYMBOLIC "WORKERS" SIGNS SHALL ONLY BE ERECTED WHEN WORKERS ARE PRESENT. SIGNS MUST BE COVERED OR REMOVED WHEN NO WORKERS ARE PRESENT.
15. TEMPORARY PAVEMENT MARKING TAPE SHALL BE USED ON ALL SURFACES OUTSIDE OF THE RESURFACING LIMITS AND ON FINISHED PAVEMENT. THIS WORK SHALL BE PAID FOR AS TEMPORARY PAVEMENT MARKING TAPE, TYPE III OF THE SIZE SPECIFIED.
16. A QUANTITY FOR "CHANGEABLE MESSAGE SIGN" HAS BEEN INCLUDED FOR USE WHEN DIRECTED BY THE ENGINEER.
17. ALL PERSONNEL WORKING OUTSIDE A VEHICLE WITHIN THE PUBLIC RIGHT-OF-WAY MUST BE WEARING A GARMENT THAT MEETS ANSI CLASS 2 REQUIREMENTS, OR CLASS 3 REQUIREMENTS FOR NIGHT OPERATIONS.
18. FLAGGERS MUST BE CERTIFIED AND CARRY THEIR CERTIFICATION CARD ON THEM WHEN WORKING, PROPER STOP/SLOW PADDLES MUST BE UTILIZED AND ALL REQUIRED SAFETY GARMENTS MUST BE WORN ON THE JOB SITE. "FLAGGER" WARNING SIGNS MUST BE IN PLACE WHENEVER FLAGGERS ARE PRESENT. THESE SIGNS MUST BE COVERED OR REMOVED WHEN NOT APPLICABLE.
19. "CAUTION" TAPE OR RIBBON IS NOT TO BE USED BETWEEN BARRICADES.
20. HOT-MIX ASPHALT PAVEMENT NECESSARY DURING MAINTENANCE OF TRAFFIC CONSTRUCTION OPERATIONS IS TO BE MIX "D", N70 AND IS TO BE PAID FOR AS TEMPORARY PAVEMENT. PAVEMENT IS TO BE USED AT THE DISCRETION OF THE RESIDENT ENGINEER FOR PURPOSES SUCH AS CROSSOVERS CREATED IN THE EXISTING PAVEMENT AS A RESULT OF CONSTRUCTION VEHICLE TRAFFIC.
21. THE DEPARTMENT'S DROP OFF POLICY (SAFETY 4-08, UPDATED 8/27/10) MUST BE FOLLOWED FOR ALL STAGES OF THE MOT PLAN. IT IS LOCATED AT: http://www.dot.il.gov/illinoisSHSP/pdf/20100827WZ_SupPolicySupport_k.pdf ADD TEMPORARY BARRIER WALL TO ALL LOCATIONS WHERE THE POLICY WILL BE VIOLATED. THE END OF THE BARRIER WALL MUST BE TAPERED 12:1 AWAY FROM TRAFFIC. IMPACT ATTENUATORS TEST LEVEL 3 ARE ALSO REQUIRED AT THE END OF THE BARRIER WALL THAT IS INSTALLED IN THE DIRECTION OF ONCOMING TRAFFIC.

WORK RESTRICTIONS

22. THE CONTRACTOR SHALL BE SUBJECT TO THE FOLLOWING WORK RESTRICTIONS: 2015 WINTER SHUTDOWN. THE CONTRACTOR SHALL COMPLETE CONTRACT ITEMS THROUGH STAGE 4B SUCH THAT 4 LANES OF TRAFFIC ARE OPEN ON REALIGNED US ROUTE 30 AND THE FRONTAGE ROADS ARE OPEN TO TWO-WAY TRAFFIC ON OR BEFORE NOVEMBER 14, 2015. THIS STAGING SETUP WILL REMAIN IN PLACE UNTIL SPRING 2016 STARTUP.

23. ANY PROPOSED ACTIVITY IN THE VICINITY OF A HIGHWAY-RAIL GRADE CROSSING MUST ADHERE TO THE GUIDELINES SET FORTH IN THE MANUAL ON UNIFORM TRAFFIC CONTROL DEVICES (MUTCD) UNDER SECTION 6G.18: WORK IN THE VICINITY A GRADE CROSSING WHICH STATES: WHEN GRADE CROSSINGS EXIST EITHER WITHIN OR IN THE VICINITY OF A TTC ZONE, LANE RESTRICTIONS, FLAGGING, OR OTHER OPERATIONS SHALL NOT CREATE CONDITIONS WHERE VEHICLES CAN BE QUEUED ACROSS THE TRACKS. IF THE QUEUING OF VEHICLES ACROSS THE TRACKS CANNOT BE AVOIDED, A UNIFORMED LAW ENFORCEMENT OFFICER OR FLAGGER SHALL BE PROVIDED AT THE CROSSING TO PREVENT VEHICLES FROM STOPPING ON THE TRACKS, EVEN IF AUTOMATIC WARNING DEVICES ARE IN PLACE.

REVISED 04-15-14

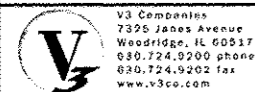

V3 Companies
7395 James Avenue
Woodridge, IL 60017
630.724.9200 phone
630.724.9202 fax
www.v3co.com

USER NAME = dsherman
DESIGNED - DSS
DRAWN - DRP
CHECKED - VJD
DATE - 04/15/2014

REVISED -
REVISED -
REVISED -
REVISED -

STATE OF ILLINOIS
DEPARTMENT OF TRANSPORTATION

MAINTENANCE OF TRAFFIC
GENERAL NOTES

SCALE: N/A SHEET NO. 1 OF 1 SHEETS

F.A.P. RTE.	SECTION	COUNTY	TOTAL SHEETS	SHEET NO.
353	11-Y-A	COOK	354	39
			CONTRACT NO. 60R19	
ILLINOIS/FEH. AID PROJECT				

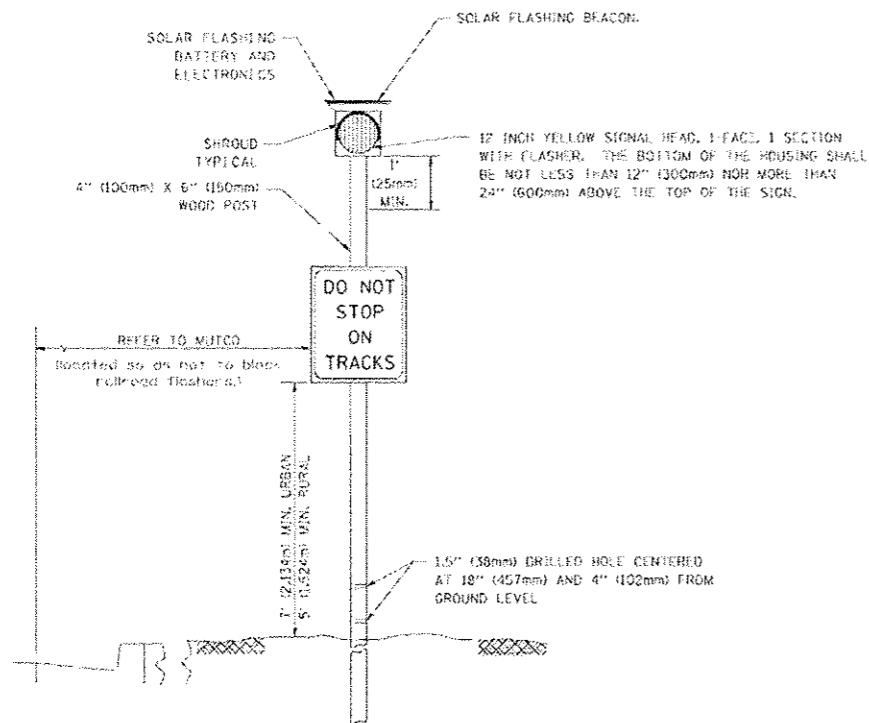

POST MOUNTED SOLAR FLASHER

N. T. S

NOTE: 4"x6"x12' Wood Posts (Breakaway) with R8-8 (24"x30") signs shall be installed in advance of the solar flashers final assembly and activation. At locations where flashing beacons are not installed, metal posts which are approved by the Road Authority may be utilized to mount the signs.

FLASHER SIGNAL LEGEND

	PROPOSED	EXISTING
SERVICE INSTALLATION	■	□
12" SIGNAL HEAD (LED)	▶	◀
WOOD POST, 4" x 6"	⊠	⊠ "E"
CONDUIT IN GROUND OR UNIT DUCT IN TRENCH	---	====
HANDHOLE	▣	▣
HEAVY DUTY HANDHOLE	▢	▢ "E"
ELECTRICAL POLE	●	⊕
GROUND ROD	⦿	⦿
SIGNAL FACE WITH BACKPLATE	Ⓡ	Ⓡ
JUNCTION BOX - STAINLESS STEEL	Ⓢ	Ⓢ
TRANSFORMER	Ⓣ	Ⓣ "E"

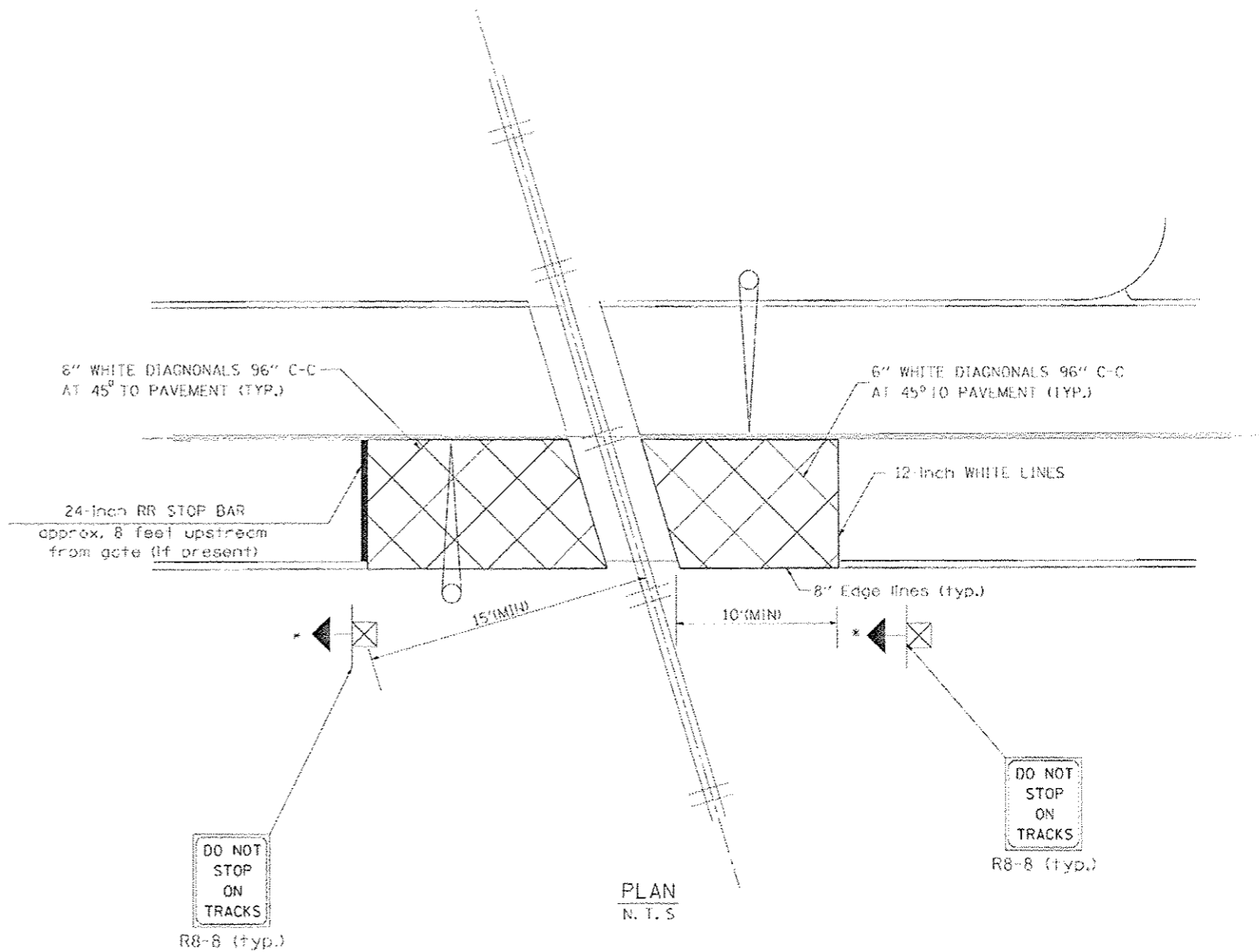

PLAN

N. T. S

* Distance to post is measured perpendicular from the center of rail (typ.)

NOTES:

1. Pavement markings will be coordinated for same day installation with flashers.
2. The traffic control devices, the type of devices and pavement marking shown on this sheet are for information only. The exact application shall be as directed by ICC or Road Authority.

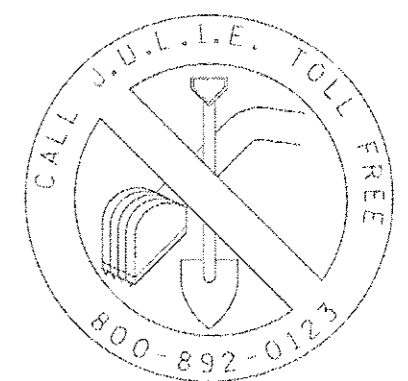

ENTIRE SHEET REVISED 04-15-14

FILE NAME: 0411126	DESIGNED: [Signature]	REVISOR: [Signature]	STATE OF ILLINOIS DEPARTMENT OF TRANSPORTATION	TYPICAL SUPPLEMENTAL SIGNINGS, PAVEMENT MARKING AND FLASHING BEACON INSTALLATION AT RAILROAD CROSSING. (SUBJECT TO ROAD AUTHORITY APPROVAL)	SHEET NO. 2 OF 2 SHEETS	SECTION: 11-Y-A	COUNTY: COOK	TOTAL SHEETS: 354	SHEET NO.: 304	CONTRACT NO. 60R19
--------------------	-----------------------	----------------------	---	--	-------------------------	-----------------	--------------	-------------------	----------------	--------------------