

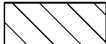



LEGEND

-  WORK AREA
-  PAVEMENT CONSTRUCTED IN STAGE
-  PAVEMENT CONSTRUCTED IN PREVIOUS STAGE
-  TEMPORARY PAVEMENT
-  DRUM OR TYPE II BARRICADE WITH STEADY BURN MONO-DIRECTIONAL LIGHTS

NOTE:
FRONTAGE ROAD TO BE BUILT IN SECTIONS TO ALLOW ACCESS TO BUSINESSES. THE FRONTAGE ROAD SHOULD BE COMPLETED IN THIS STAGE.

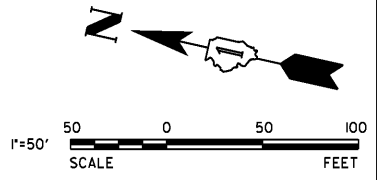

WORK ZONE
SPEED LIMIT
35
PHOTO ENFORCED
#375 FINE MINIMUM
STA. 275+00
W21-1115(O)-3618
R2-1-3648
R10-19oP-3618
R2-1106-3618

ROAD CLOSED AHEAD
W20-3

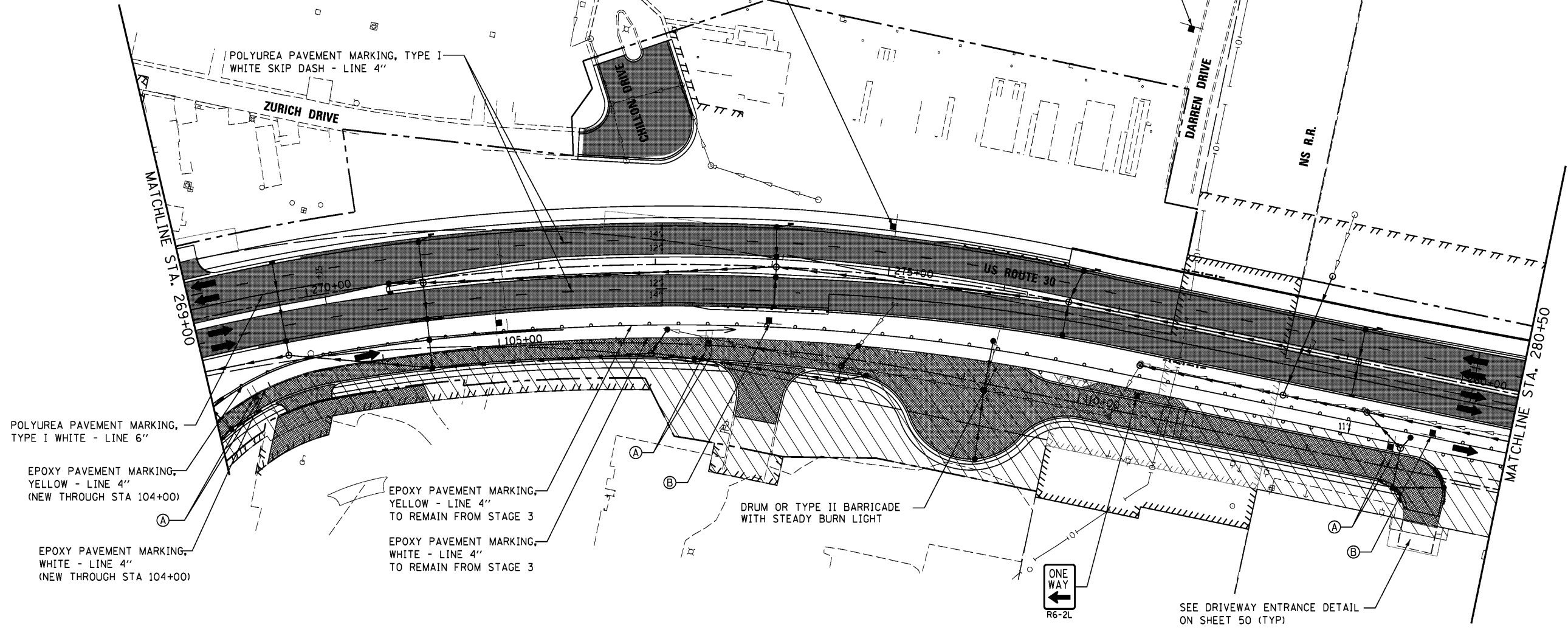

POLYUREA PAVEMENT MARKING, TYPE I WHITE - LINE 6"

EPOXY PAVEMENT MARKING, YELLOW - LINE 4" (NEW THROUGH STA 104+00)

EPOXY PAVEMENT MARKING, WHITE - LINE 4" (NEW THROUGH STA 104+00)

EPOXY PAVEMENT MARKING, YELLOW - LINE 4" TO REMAIN FROM STAGE 3

EPOXY PAVEMENT MARKING, WHITE - LINE 4" TO REMAIN FROM STAGE 3

DRUM OR TYPE II BARRICADE WITH STEADY BURN LIGHT

ONE WAY
R6-2L

SEE DRIVEWAY ENTRANCE DETAIL ON SHEET 50 (TYP)

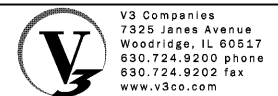
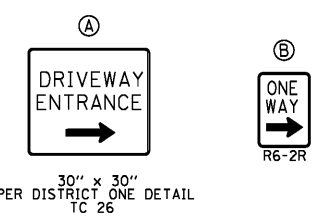

USER NAME = dsherman	DESIGNED - DTE	REVISED -
PLOT SCALE = 50'	DRAWN - DRP	REVISED -
PLOT DATE = 2/21/2014	CHECKED - VJD	REVISED -
	DATE - 02/21/2014	REVISED -

**STATE OF ILLINOIS
DEPARTMENT OF TRANSPORTATION**

**MAINTENANCE OF TRAFFIC - STAGE 4a
STATION 269+00 TO STATION 280+50**

SCALE: 1" = 50' SHEET NO. 2 OF 5 SHEETS STA. 269+00 TO STA. 280+50

F.A.P. RTE.	SECTION	COUNTY	TOTAL SHEETS	SHEET NO.
353	11-Y-A	COOK	354	64
CONTRACT NO. 60R19				
ILLINOIS FED. AID PROJECT				