





**LEGEND**

-  WORK AREA
-  PAVEMENT CONSTRUCTED IN STAGE
-  PAVEMENT CONSTRUCTED IN PREVIOUS STAGE
-  TEMPORARY PAVEMENT
-  DRUM OR TYPE II BARRICADE WITH STEADY BURN MONO-DIRECTIONAL LIGHTS

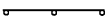
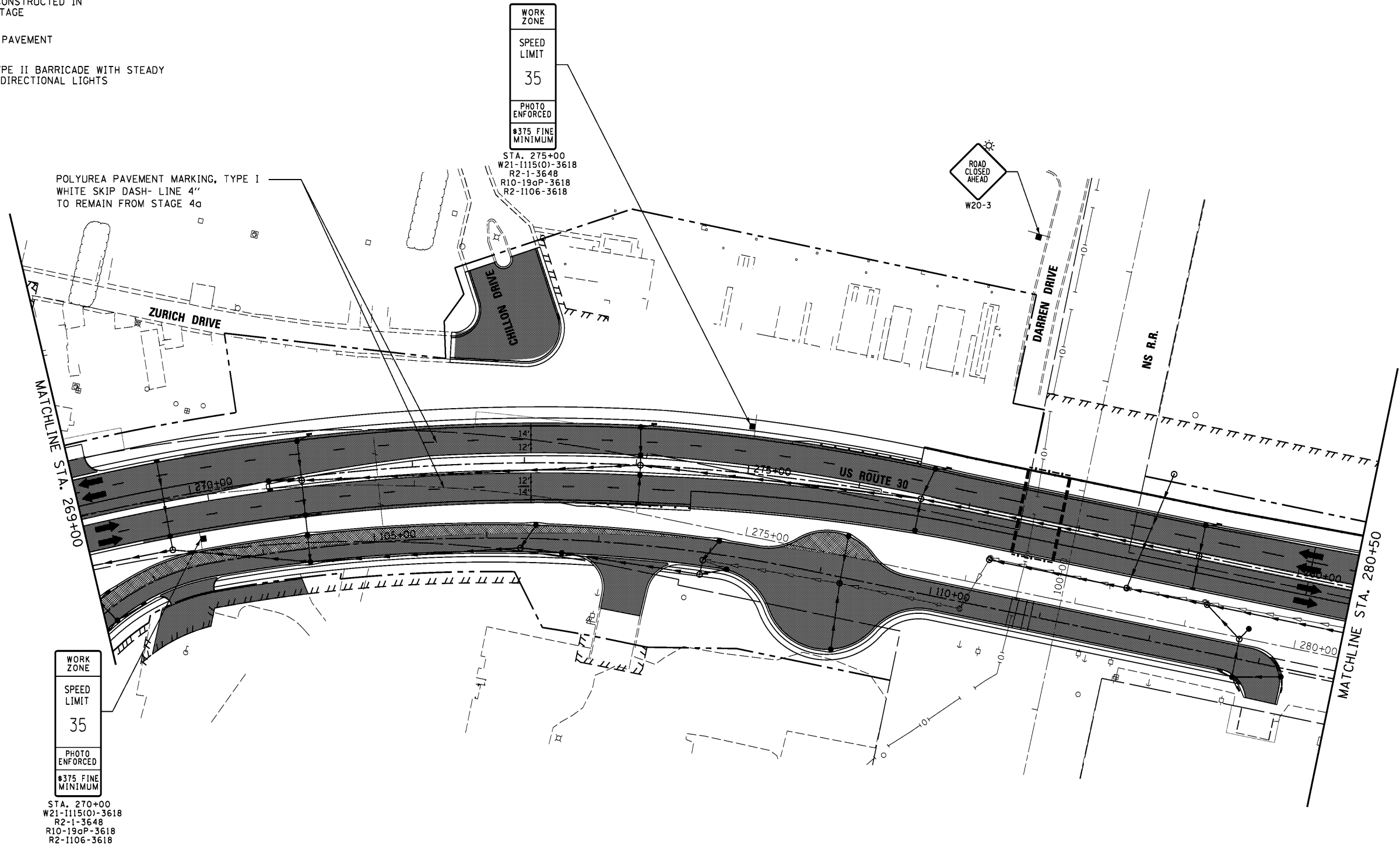
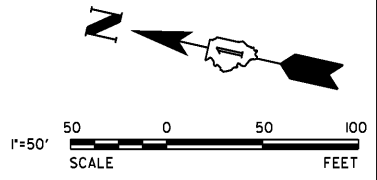

WORK ZONE  
 SPEED LIMIT  
 35  
 PHOTO ENFORCED  
 #375 FINE MINIMUM  
 STA. 270+00  
 W21-1115(0)-3618  
 R2-1-3648  
 R10-19aP-3618  
 R2-1106-3618

WORK ZONE  
 SPEED LIMIT  
 35  
 PHOTO ENFORCED  
 #375 FINE MINIMUM  
 STA. 275+00  
 W21-1115(0)-3618  
 R2-1-3648  
 R10-19aP-3618  
 R2-1106-3618

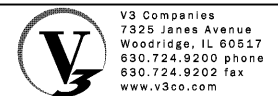

USER NAME = dsherman	DESIGNED - DTE	REVISED -
PLOT SCALE = 5/8"	DRAWN - DRP	REVISED -
PLOT DATE = 2/21/2014	CHECKED - VJD	REVISED -
	DATE - 02/21/2014	REVISED -

**STATE OF ILLINOIS  
DEPARTMENT OF TRANSPORTATION**

**MAINTENANCE OF TRAFFIC - STAGE 4b**  
**STATION 269+00 TO STATION 280+50**  
 SCALE: 1" = 50'    SHEET NO. 2 OF 5 SHEETS    STA. 269+00 TO STA. 280+50

F.A.P. RTE.	SECTION	COUNTY	TOTAL SHEETS	SHEET NO.
353	11-Y-A	COOK	354	69
CONTRACT NO. 60R19				
ILLINOIS FED. AID PROJECT				