

*Elevation at back of hatched area.

MINIMUM BAR LAP

- #5 = 3'-3"
- #6 = 3'-10"
- #7 = 5'-10"

PILE DATA

Type: Metal Shell-14 in. dia. x .25 in. walls
 Nominal Required Bearing: 415 kips
 Factored Resistance Available: 228 kips
 Est. Length: 85'
 No. Production Piles: 12
 No. Test Piles: 1

In order to alleviate dowdrag on pile, the Contractor shall:

Construct the MSE walls first, wait **6 months, and then drive piles through sleeves that were placed before MSE wall construction. Place sleeves after removal of unsuitable material and before backfilling with Aggregate Subgrade Improvement where this is necessary. Cost included with Furnishing Metal Shell Piles, 14" ϕ x 0.25".

**Or until the settlement platforms for the MSE walls indicate that 1.6" of the estimated 2.0" of settlement has occurred at the abutment.

Notes:

Hatched area to be poured after superstructure forms have been removed. Quantity of concrete included with Concrete Superstructure.
 Space reinforcement in cap to miss anchor bolts.
 Bar indicated thus 4x2-#5 etc. indicates 4 lines of bars with 2 lengths per line.
 See Sheet 22 of 35 for Sec. Thru North Abut., Anchor Bolt Detail I, Bar Details, and Bill of Material.
 See Sheet 11 of 35 for median and parapet reinforcement details.
 See Sheet 24 of 35 for additional pile information.
 See sheet 25 of 35 for details of Bar Splicers.

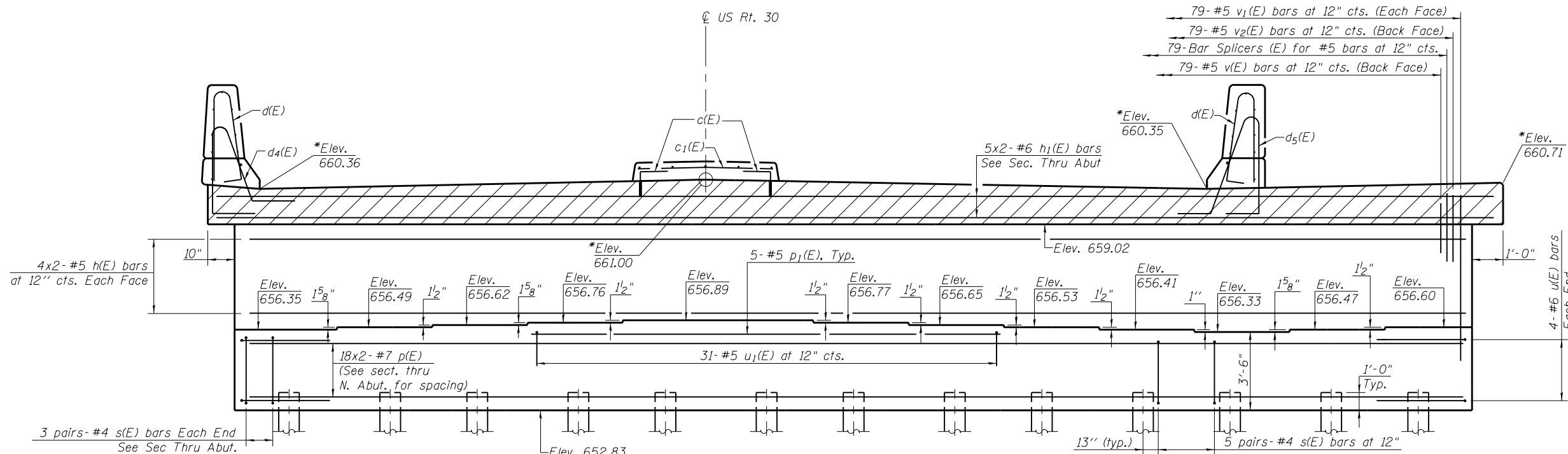

ELEVATION
(Looking North)

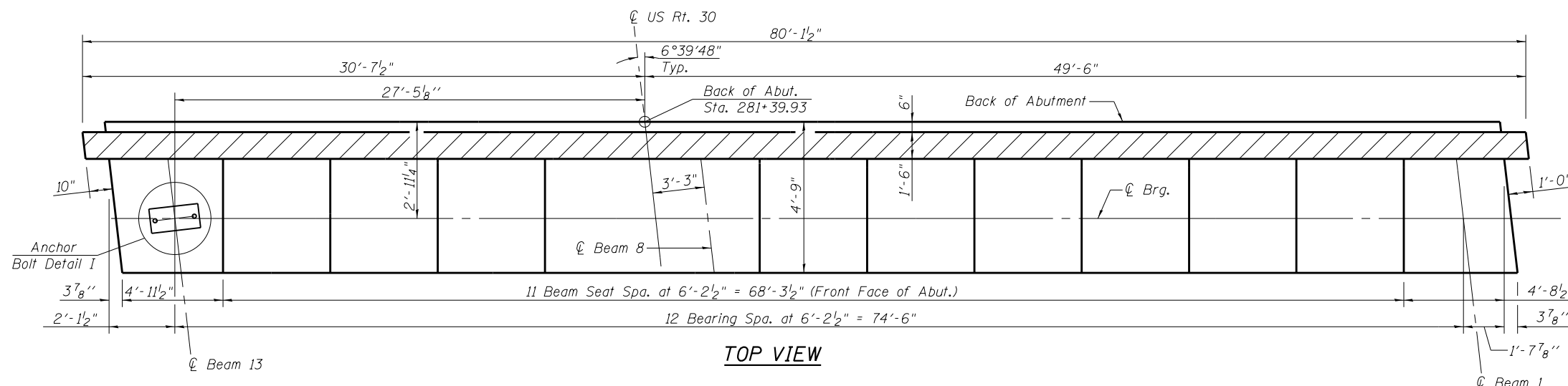

TOP VIEW

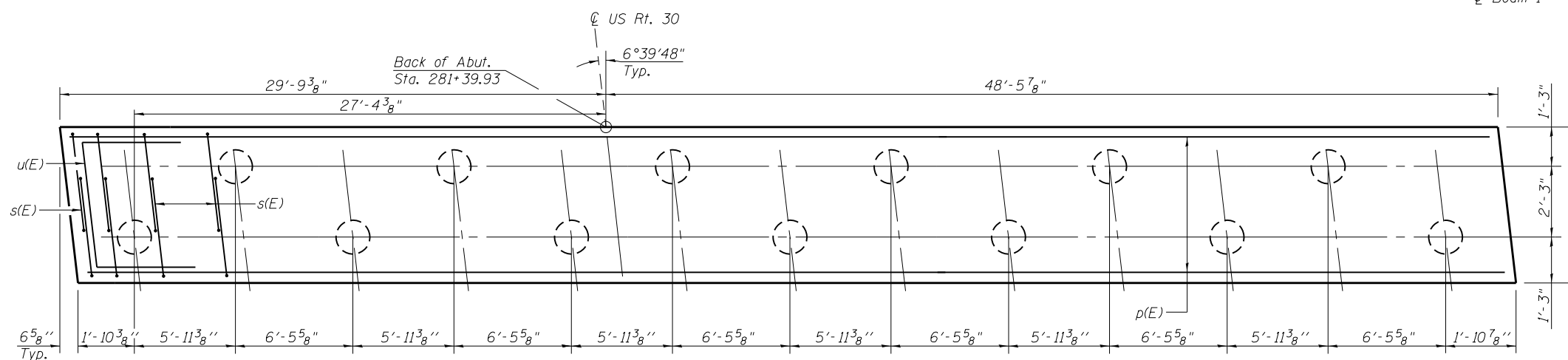

PILE CAP PLAN

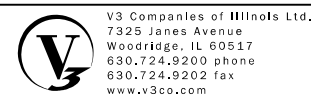

USER NAME =	DESIGNED - WJV	REVISED
PLOT SCALE =	CHECKED - CJB	REVISED
PLOT DATE =	DRAWN - WJV	REVISED
	CHECKED - CJB	REVISED

STATE OF ILLINOIS
DEPARTMENT OF TRANSPORTATION

NORTH ABUTMENT
STRUCTURE NO. 016-1350
 SHEET NO. 20 OF 35 SHEETS

F.A.P. RTE. 353	SECTION 11-Y-A	COUNTY COOK	TOTAL SHEETS 354	SHEET NO. 205
CONTRACT NO. 60R19				