

GENERAL NOTES

Reinforcement Bars designated (E) shall be epoxy coated.
 See Special Provisions for Mechanically Stabilized Earth Retaining Wall design and construction requirements.
 The gradations and capping of the Aggregate Subgrade Improvement used to replace the unsuitable material shall be approved by the Engineer.
 M.S.E. wall supplier to provide internal stability design for load transfer system to accommodate the posts for the traffic barrier terminals at the north end of the southeast wall. See Roadway Plans for exact location of traffic barrier terminals and IDOT Highway Standards 630301-06 and 631031-11 for details. Coordinate with Contractor installing the traffic barrier terminals. Cost included with Mechanically Stabilized Earth Retaining Wall.
 Slipforming of the parapets is not allowed.

TOTAL BILL OF MATERIAL

ITEM	UNIT	TOTAL
Mechanically Stabilized Earth Retaining Wall	Sq. Ft.	26,465
Structure Excavation	Cu. Yd.	8,039
Removal and Disposal of Unsuitable Material for Structures	Cu. Yd.	3,645
Aggregate Subgrade Improvement	Cu. Yd.	3,645
Concrete Structures	Cu. Yd.	492.7
Concrete Superstructure	Cu. Yd.	134.1
Protective Coat	Sq. Yd.	1,758
Reinforcement Bars, Epoxy Coated	Pound	100,620
Bicycle Railing	Foot	466
Parapet Railing	Foot	462
Name Plates	Each	1
Geotechnical Fabric for Ground Stabilization	Sq. Yd.	3,553
Porous Granular Embankment	Cu. Yd.	20,926

INDEX OF SHEETS

1	General Plan & Elevation
2	General Notes, Index of Sheets and Total Bill of Material
3	MSE Retaining Walls General Layout
4	Unsuitable Material Removal and Backfill Layout
5	MSE Wall Plan & Elevation
6	MSE Wall Elevations
7	MSE Wall Details at Abutment
8	MSE Wall Cross Section
9	MSE Wall Cross Section Tables
10	Drainage Structure Details
11	Northeast MSE Wall Coping Elevation
12	Northeast Anchorage Slab
13	Northeast Parapet Elevation
14	Northwest MSE Wall Anchorage Slab
15	Northwest Parapet Elevation
16	Anchorage Slab and Parapet Details
17	Bicycle Railing
18-35	Soil Boring Logs

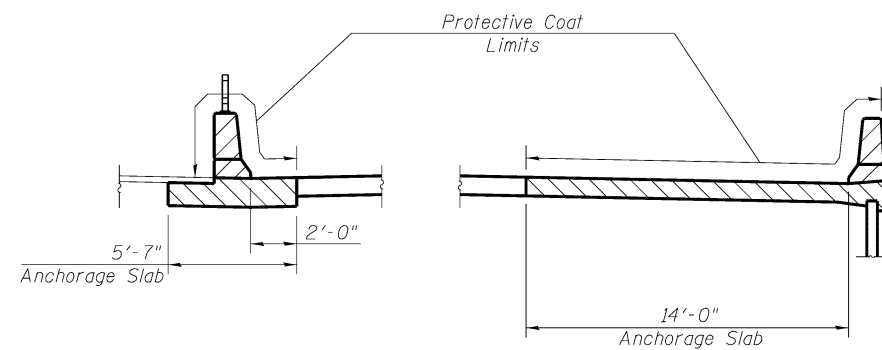

PROTECTIVE COAT LIMITS

ANCHORAGE SLAB PAY ITEM LEGEND

- Paid as Concrete Superstructure
- Paid as Concrete Structures

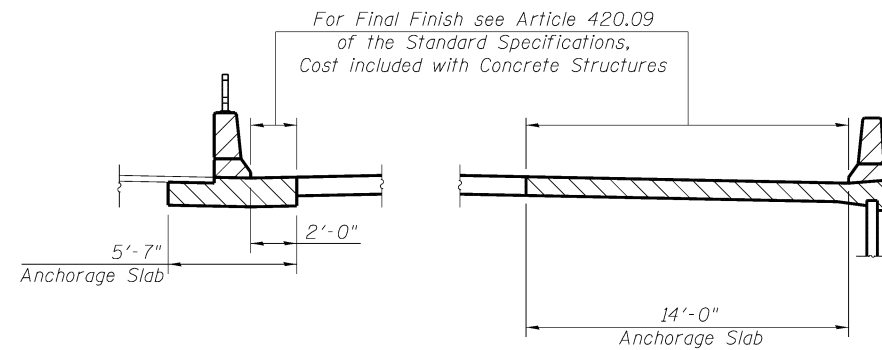

FINAL FINISH LIMITS

STATION 274+50.00
 - 281+52.27
 BUILT BY
 STATE OF ILLINOIS
 F.A.P. RT. 353 SEC. 11-Y-A
 LOADING HL-93
 STRUCTURE NO. 016-1279

NAME PLATE

See Std. 515001



USER NAME =	DESIGNED - EVS	REVISED
	CHECKED - WJV	REVISED
PLOT SCALE =	DRAWN - EVS	REVISED
PLOT DATE =	CHECKED - WJV	REVISED

**STATE OF ILLINOIS
 DEPARTMENT OF TRANSPORTATION**

**GENERAL NOTES, INDEX OF SHEETS AND TOTAL BILL OF MATERIAL
 STRUCTURE NO. 016-1279**

SHEET NO. 2 OF 35 SHEETS

F.A.P. RTE.	SECTION	COUNTY	TOTAL SHEETS	SHEET NO.
353	11-Y-A	COOK	354	222
CONTRACT NO. 60R19				

ILLINOIS FED. AID PROJECT