

TEMPORARY PHASE DESIGNATION DIAGRAM

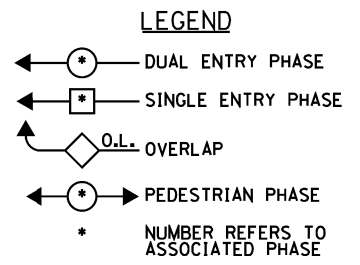

**TEMPORARY BRIDGE TRAFFIC SIGNAL  
CABLE PLAN - STAGE 1 & 2**

(SEE STAGING PLANS FOR HEAD LOCATIONS)

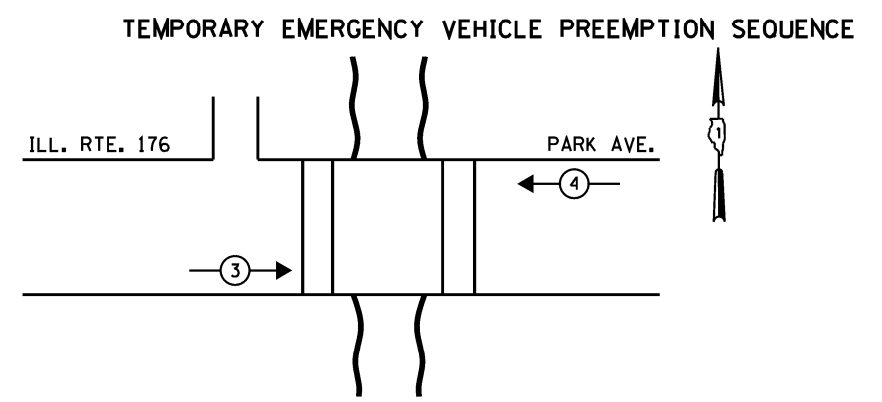

TEMPORARY EMERGENCY VEHICLE PREEMPTION SEQUENCE

**GENERAL NOTES:**

- CONTACT TO THE ELECTRIC UTILITY SHALL BE INITIATED BEFORE THE PRECONSTRUCTION MEETING, AND DOCUMENTATION OF CONTACT SHALL BE PRESENTED AT THAT MEETING. NO PLACEMENT OF POLES WILL BE ALLOWED WITHOUT EVIDENCE OF A SIGNED AGREEMENT WITH THE ELECTRIC UTILITY, FURNISHED TO THE ENGINEER.
- UNLESS OTHERWISE INDICATED, AND EXCEPT AS OTHERWISE NOTED, THIS STANDARDIZED LAYOUT SHALL APPLY FOR BRIDGES NOT EXCEEDING A 250-FOOT SPAN. FOR BRIDGE SPANS IN EXCESS OF 250 FEET, THE POLES IMMEDIATELY ADJACENT TO THE BRIDGE SHALL BE 100-FOOT POLES (90-FOOT MOUNTING HEIGHT), WITH 750-WATT TYPE III HIGH PRESSURE SODIUM HIGH-MAST LUMINAIRES AS APPROVED BY THE ENGINEER.
- THE LAYOUT OF THE TEMPORARY EQUIPMENT WILL VARY BASED ON FIELD CONDITIONS, STAGING, UTILITY IMPACTS, AND THE ELECTRIC SERVICE LOCATION AS COORDINATED WITH THE ELECTRIC UTILITY. THE CONTRACTOR SHALL SUBMIT A PLAN INDICATING THE SETTING OF POLES, TRAFFIC SIGNALS, AND COMBINED SERVICE. THIS PLAN MUST BE APPROVED BY THE ENGINEER BEFORE ANY POLES ARE PLACED.
- THE ELECTRIC SERVICE SHALL BE 240/120V. WHERE 240V SERVICE IS NOT AVAILABLE, THE CONTRACTOR MAY SUBMIT A PROPOSAL FOR 120V SERVICE. DROP CABLE, MAIN BREAKER, AND ALL OTHER SERVICE APPURTENANCES SHALL BE APPROPRIATELY RATED AND INCLUDED REGARDLESS OF THE SERVICE VOLTAGE APPLIED.
- THE TEMPORARY LIGHTING AND TRAFFIC SIGNAL INSTALLATION SHALL SHARE ANY COMMON ELEMENTS SUCH AS WOOD POLES, ELECTRICAL SERVICE, ELECTRIC SERVICE BOX, CABLE, ETC. THE CONTRACTOR SHALL COORDINATE TEMPORARY LIGHTING AND TRAFFIC SIGNAL INSTALLATIONS.
- THE LIGHT POLE SETBACK FROM THE EDGE OF TRAVEL PAVEMENT SHALL BE 18 FT. UNLESS THE LIGHT POLE IS BEHIND GUARDRAIL, THE LIGHT POLES INSTALLED BEHIND THE GUARDRAIL OR BARRIER WALL SHOULD HAVE AT LEAST 8 FT. SETBACK FROM THE BACK OF THE SHOULDER AND OR AS DIRECTED BY THE ENGINEER.
- EACH LIGHTING UNIT SHALL BE CONTROLLED BY A PHOTO CELL MOUNTED ON EACH LUMINAIRE WITH THE LIGHTING CIRCUIT FED FROM THE TEMPORARY SERVICE DISCONNECT BOX. OTHER MEANS OF LUMINAIRE CONTROL CAN BE CONSIDERED IF APPROVED BY THE ENGINEER.
- THE CONTRACTOR SHALL SPLICE AERIAL CABLE AT THE LIGHT POLE USING HEAT SHRINKABLE CAPS WITH THE FACTORY APPLIED WATERPROOF SEALANT OR AN APPROVED UL LISTED AERIAL TAP DEVICE.
- ALL AREAS DISTURBED UNDER THIS CONTRACT SHALL BE RESTORED TO THE ORIGINAL CONDITION OR BETTER, TO THE SATISFACTION OF THE ENGINEER.
- ANY TREE TRIMMING NECESSARY TO SET UP THE TEMPORARY TRAFFIC LIGHTING WILL BE COVERED UNDER THE SPECIAL PROVISION "PRUNING FOR SAFETY AND EQUIPMENT CLEARANCE."

I.D.O.T. TRAFFIC SIGNAL INSTALLATION ELECTRICAL SERVICE REQUIREMENTS					TOTAL WATTAGE
TYPE	NO LAMPS	WATTAGE		% OPERATION	
SIGNAL (RED)	8	135	17	0.50	68
(YELLOW)	8	135	25	0.25	50
(GREEN)	8	135	15	0.25	30
ARROW		135	12	0.10	
PED. SIGNAL		90	25	1.00	
CONTROLLER	2	100	100	1.00	200
ILLUM. SIGN				0.05	
VIDEO SYSTEM	2	150		1.00	300
FLASHER				0.50	
ENERGY COSTS TO:				TOTAL =	648
ILLINOIS DEPARTMENT OF TRANSPORTATION 201 WEST CENTER COURT SCHAMBURG, ILLINOIS 60196-1096					
ENERGY SUPPLY CONTACT: JOE HURLEY PHONE: (847) 816-5503 COMPANY: COMED					

TEMPORARY EMERGENCY VEHICLE PREEMPTORS		
EMERGENCY VEHICLE PREEMPTOR	3	4
MOVEMENT	→	←

CONTRACTOR SHALL COORDINATE WITH THE  
LIBERTYVILLE FIRE DEPARTMENT FOR EVP  
INSTALLATION

CONTRACTOR SHALL COORDINATE WITH ComEd.  
FOR ELECTRIC SERVICE INSTALLATION

FILE NAME: ct:\pwr\work\pwr\dot\pwrzenowskirb\d030844	USER NAME: pwrzenowskirb	DESIGNED: -	REVISED: -	STATE OF ILLINOIS DEPARTMENT OF TRANSPORTATION	TEMPORARY CABLE PLAN, TEMPORARY EMERGENCY VEHICLE PREEMPTION SEQUENCE, AND TEMPORARY PHASE DESIGNATION DIAGRAM ILL 176 (PARK AVE.) OVER DES PLAINES RIVER	F.A.U. RTE.: 1238	SECTION: P-2-1-1(12)	COUNTY: LAKE	TOTAL SHEETS: 25	SHEET NO.: 15	
Default	PLOT SCALE: 100.0000' / in.	CHECKED: -	REVISED: -			SCALE: SHEET OF SHEETS STA. TO STA.	CONTRACT NO. 60777				
	PLOT DATE: 2/11/2014	DATE: -	REVISED: -			ILLINOIS FED. AID PROJECT					