

### EROSION CONTROL GENERAL NOTES

1. SILT FENCE SHALL BE USED AS A PERIMETER EROSION BARRIER TO FILTER RUNOFF LEAVING THE PROJECT LIMITS. J-HOOKS SHALL BE INSTALLED AS SHOWN IN HIGHWAY STANDARD 280001 AT LOCATIONS APPROVED BY THE RESIDENT ENGINEER.
2. PROPOSED CULVERTS RECEIVING RUNOFF SHALL BE PROTECTED WITH INLET AND PIPE PROTECTION IMMEDIATELY AFTER CONSTRUCTION.
3. INLET FILTERS SHALL BE USED ONLY IN PAVED AREAS.
4. FOR INLET AND PIPE PROTECTION, USE A COMBINATION OF TEMPORARY SEED, EROSION CONTROL BLANKET, AND TEMPORARY DITCH CHECKS FOR PIPE PROTECTION. THE USE OF STRAW BALES FOR PIPE PROTECTION SHALL NOT BE ALLOWED.
5. EROSION CONTROL MEASURES SHALL BE INSPECTED WITHIN 24 HOURS OF ANY STORM EXCEEDING 1/2" OF PRECIPITATION.
6. STABILIZED CONSTRUCTION ENTRANCES WILL BE REQUIRED, ALL LOCATIONS SHALL BE APPROVED BY THE RESIDENT ENGINEER, AND PAYMENT SHALL BE CONSIDERED INCIDENTAL TO THE COST OF THE CONTRACT.
7. EROSION CONTROL ITEMS ARE CONSIDERED TO BE HIGH PRIORITY ITEMS ON THIS CONTRACT. THE ENGINEER WILL IMPLEMENT ALL PROVISIONS OF THE SPECIFICATION NECESSARY TO ASSURE THAT EROSION CONTROL ITEMS ARE CONSTRUCTED AND MAINTAINED IN A TIMELY WAY. ALL EROSION CONTROL MEASURES SHALL BE INSTALLED PRIOR TO BEGINNING ANY CONSTRUCTION ACTIVITIES WHICH WILL POTENTIALLY CREATE ERODABLE CONDITIONS.
8. THE EROSION CONTROL MEASURES SHOWN ARE A GRAPHICAL REPRESENTATION OF SUGGESTED MEASURES. DEVIATIONS FROM THIS PLAN ARE TO BE EXPECTED PENDING A JOBSITE INSPECTION BETWEEN THE CONTRACTOR AND ENGINEER.
9. EROSION CONTROL BLANKET SHALL BE PLACED IN ACCORDANCE WITH THE REQUIREMENTS OF THE STANDARD SPECIFICATIONS AFTER TEMPORARY SEEDING HAS BEEN COMPLETED ON AREAS WITH SLOPES 1:3 OR STEEPER THAT ARE TEMPORARILY SEEDED ON OR AFTER SEPTEMBER 16, OR AS DETERMINED BY THE ENGINEER.

□ DENOTES WORK INCLUDED IN THE COST OF OTHER ITEMS

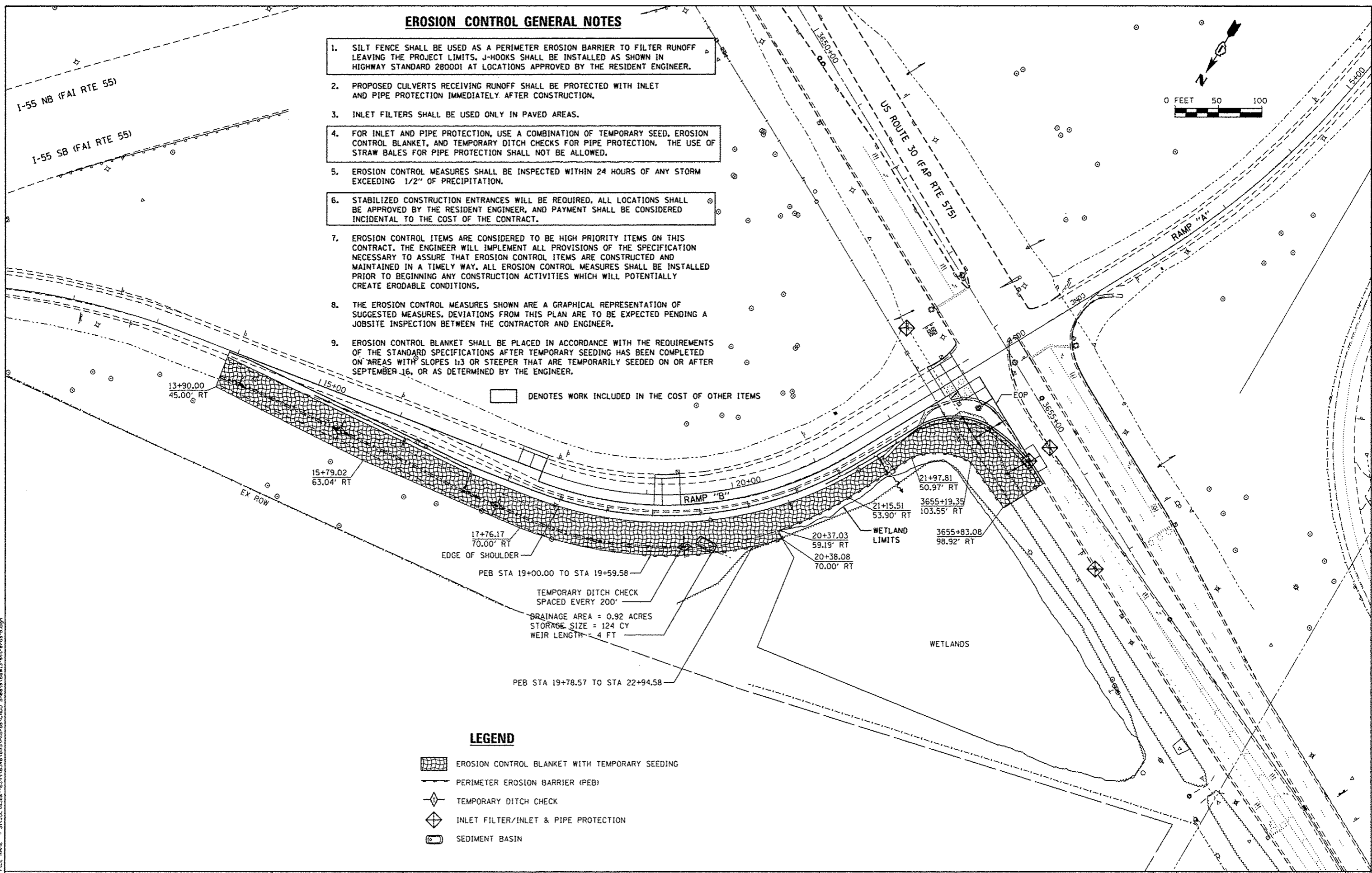
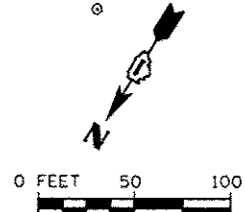

#### LEGEND

- EROSION CONTROL BLANKET WITH TEMPORARY SEEDING
- PERIMETER EROSION BARRIER (PEB)
- TEMPORARY DITCH CHECK
- INLET FILTER/INLET & PIPE PROTECTION
- SEDIMENT BASIN

FILE NAME = S:\J02\_16322-6399\6346\_0855\Micro\CA00\_Sheets\63M13.dwg

**SA**  
STRAND ASSOCIATES  
1170 SOUTH HOUBOLT ROAD  
JOLIET, ILLINOIS 60431  
(815) 744-4200

USER NAME = dennisw	DESIGNED - JLB	REVISED -
MODEL NAME = Default	DRAWN - DJW	REVISED -
PLOT SCALE = 100.0000' / in.	CHECKED - BMA	REVISED -
PLOT DATE = 12/10/2013	DATE - 12/17/13	REVISED -

**STATE OF ILLINOIS  
DEPARTMENT OF TRANSPORTATION**

**TEMPORARY EROSION CONTROL PLAN  
RAMP "B"**

SCALE: 1" = 50'    SHEET 1 OF 2 SHEETS    STA.    TO STA.

F.A.P. RTE. 575	SECTION 14-N	COUNTY WILL	TOTAL SHEETS 163	SHEET NO. 43
CONTRACT NO. 60W13			ILLINOIS FED. AID PROJECT	