

**TEMPORARY VIDEO DETECTION MOUNTING DETAIL**  
(NOT TO SCALE)

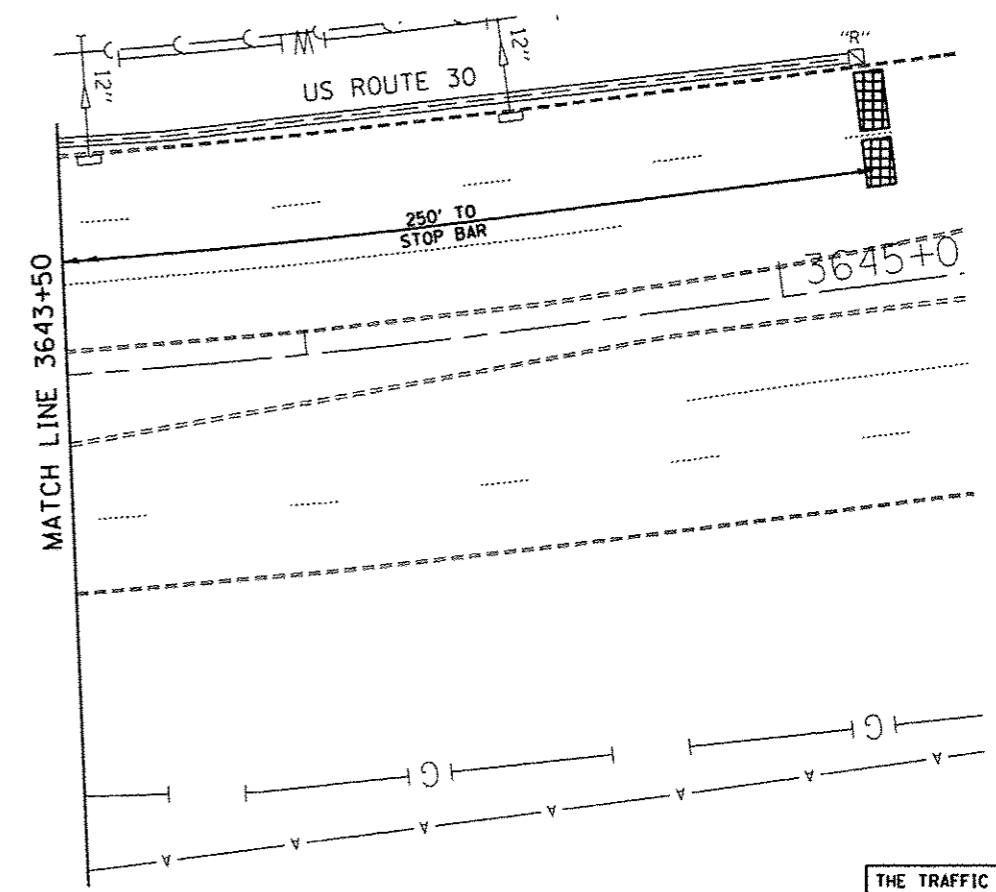

THE TRAFFIC SIGNAL CONTROL EQUIPMENT FOR THIS PROJECT SHALL BE "ECONOLITE" TO MATCH THE EXISTING ADJACENT SYSTEM.

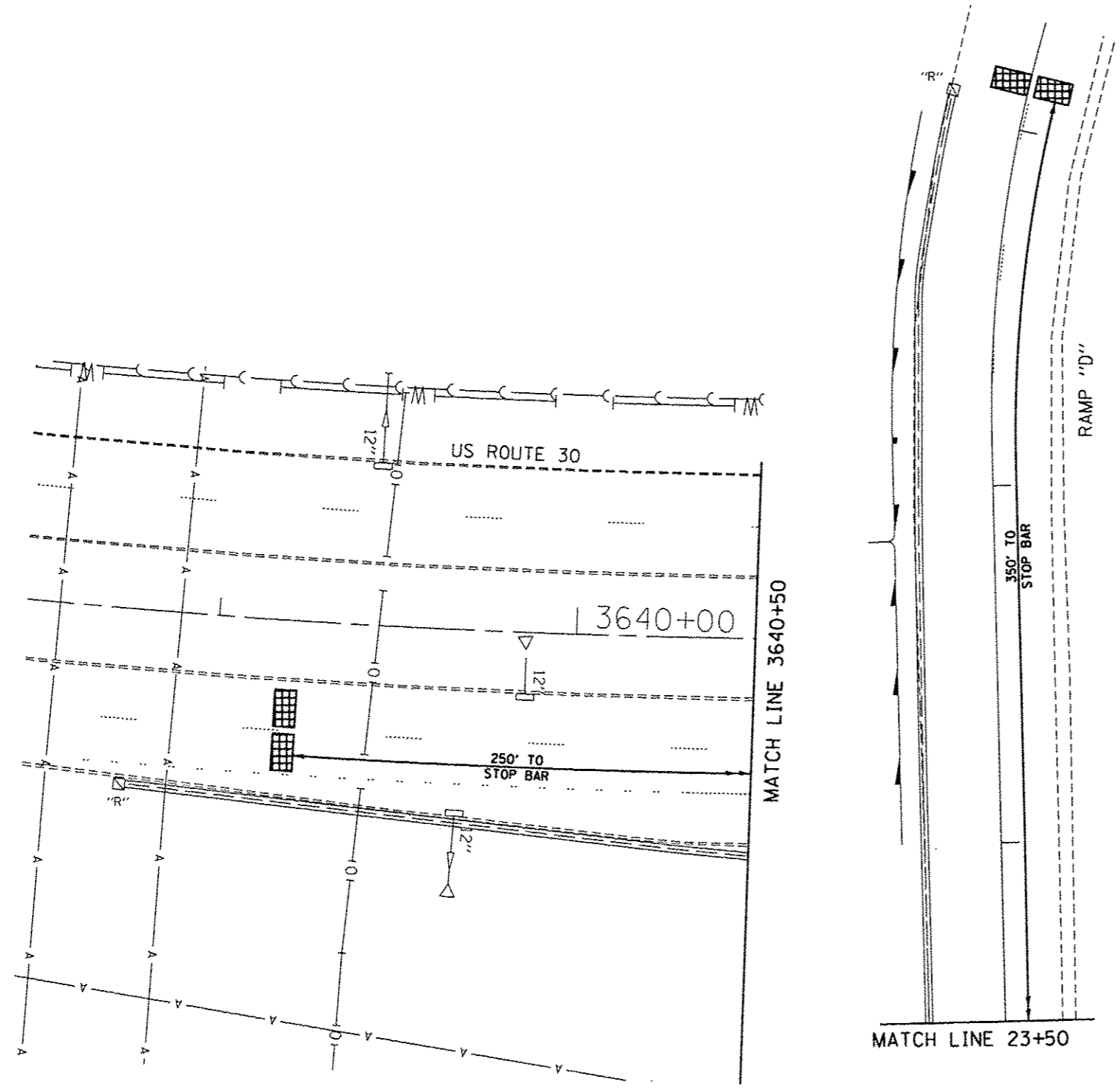

USER NAME = _USER_	DESIGNED - MG	REVISED -
FILE NAME = 6160413-shr-ts04.dgn	DRAWN - VP/MG	REVISED -
PLOT SCALE = 20.0000' / 1" in.	CHECKED - Y/KP	REVISED -
PLOT DATE = 12/17/2013	DATE - 12/17/2013	REVISED -

STATE OF ILLINOIS  
DEPARTMENT OF TRANSPORTATION

TEMPORARY TRAFFIC SIGNAL INSTALLATION PLAN  
US ROUTE 30 AT I-55 RAMPS C AND D

SCALE: 1"=20' SHEET 10 OF 33 SHEETS STA. TO STA.

F.A.P. RTE.	SECTION	COUNTY	TOTAL SHEETS	SHEET NO.
575	14-N	WILL	163	70
CONTRACT NO. 60W13				
ILLINOIS FED. AID PROJECT				