

NOTES

1. THE EXISTING LIGHT POLE IDENTIFICATION NUMBERS SHALL BE REMOVED AND NEW POLE IDENTIFICATION NUMBERS SHALL BE PROVIDED AS SHOWN ON THE PROPOSED LIGHTING PLANS AND LIGHTING CONTROLLER WIRING DIAGRAM. THIS WORK SHALL BE INCIDENTAL TO MAINTENANCE OF LIGHTING SYSTEM.
2. INSTALL LUMINAIRE SAFETY CABLE ASSEMBLY.
3. THE CONTRACTOR IS TO INSTALL NEW LIGHTING CONTROLLER "M" AND ASSOCIATED NEW CONNECTIONS TO EXISTING COMED SERVICE POLE AND EXISTING LIGHTING CIRCUITS PRIOR TO REMOVAL OF EXISTING CONTROLLER. REMOVAL AND REINSTALLATION SHALL OCCUR ON SAME DAY SO SYSTEM REMAINS OPERATIONAL AT ALL TIMES.
4. CONTRACTOR SHALL COORDINATE WITH COMED TO CONNECT SERVICE WIRE TO EXISTING TRANSFORMER. THE COST OF THE WORK SHALL BE INCLUDED IN ELECTRIC SERVICE INSTALLATION ITEM.

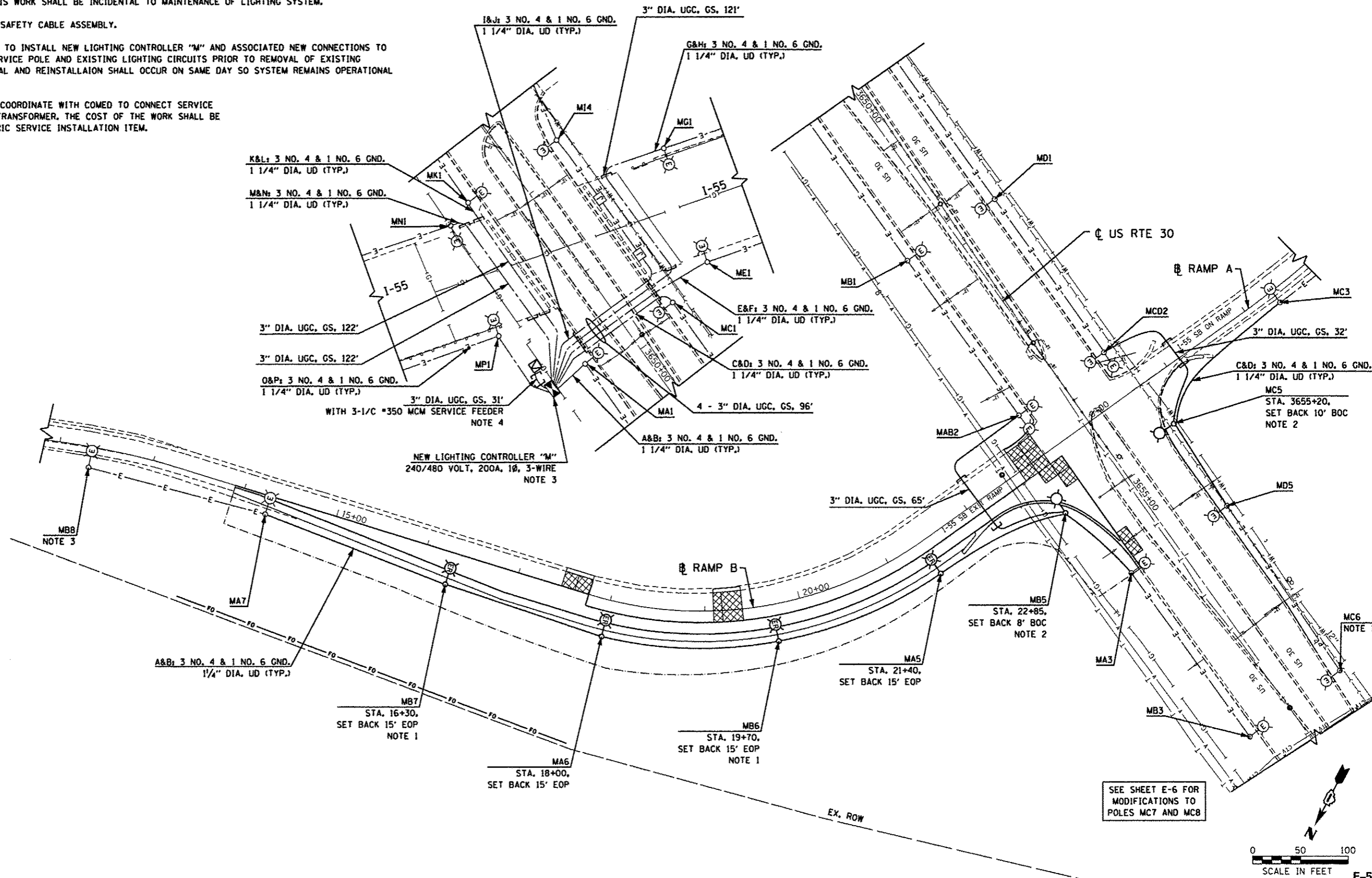

SEE SHEET E-6 FOR MODIFICATIONS TO POLES MC7 AND MC8

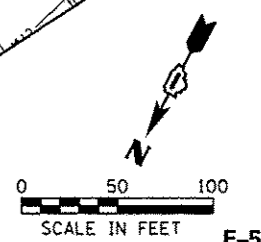

SINGH
SINGH & ASSOCIATES, INC.
CONSULTING ENGINEERS

USER NAME = USER	DESIGNED - RP/DJ	REVISED -
FILE NAME = 0160413-shc-light-05.dgn	DRAWN - RP/DJ	REVISED -
PLOT SCALE = 5/8" = 1' / in.	CHECKED - MK	REVISED -
PLOT DATE = 12/17/2013	DATE - 12/17/2013	REVISED -

STATE OF ILLINOIS
DEPARTMENT OF TRANSPORTATION

LIGHTING PLAN AT RAMP B
AND US ROUTE 30

SCALE: 1" = 50' SHEET 5 OF 8 SHEETS STA. 5+00 TO STA. 25+00

F.A.P. RTE. 575	SECTION 14-N	COUNTY WILL	TOTAL SHEETS 163	SHEET NO. 98
CONTRACT NO. 60W13				ILLINOIS FED. AID PROJECT