

FILE PATH = p:\388035-p\m\1\escomon\me\local\p\AEC\060\Documents\01\_Americas\Transportation\62629938\_Circle\Phase\_1\000\_CAD\005\_Roadway\Sheets\60W71\_Contract\0160W71-sht-ATB-05.dgn

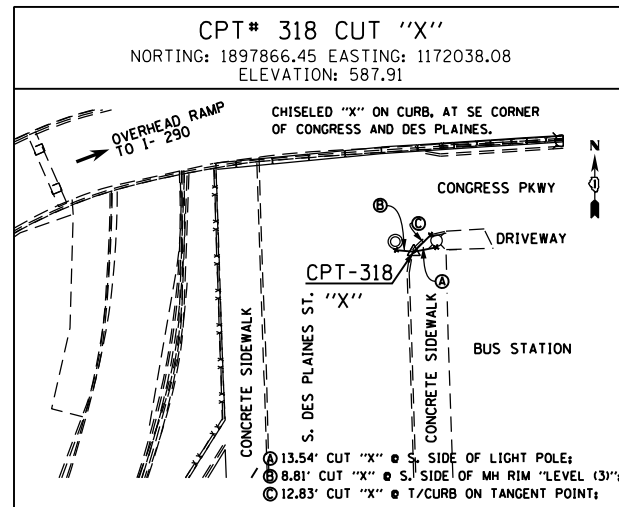

BENCHMARKS		
MONUMENT	ELEVATION	DESCRIPTION
BM 1100	582.6782	SET "X" @ CL OF EAST PIER @ CL OF VAN BUREN ST.
BM 1140	579.3332	SET "X" ON WESTERLY JAYWALL OF I-90 @ CL OF VAN BUREN ST.
BM 1141	575.1320	SET "X" ON WESTERLY JAYWALL OF I-90 @ CL OF OUTBOUND I-290 OVERPASS.
BM 1142	575.9003	SET "X" ON WESTERLY JAYWALL OF I-90 @ CL OF INBOUND I-290 OVERPASS.
BM 1143	580.1100	SET "X" ON WESTERLY JAYWALL OF I-90 ±35' SOUTH OF HARRISON ST. OVERPASS.
BM 1144	585.7601	CHISEL "X" ON OVERHEAD SIGN BOLT. SIGN #D1. W. SIDE OF HARRISON. (CENTER OF 3 EAST BOLTS)
BM 1145	586.1391	CHISEL "X" ON WESTERLY BOLT OF H.M.L.P. CL OF I-90 ± 200' S. OF PUMP/LIFT STATION.
BM 1146	582.9574	SET "X" ON WESTERLY JAYWALL OF I-90 WESTBOUND ± OPPOSITE SIGN #D4
BM 1147	579.4454	SET "X" ON WESTERLY JAYWALL OF ACCIDENT INVESTIGATION SITE ±35' N. OF E. I-90/94 SIGN.
BM 1345	594.1988	"+" CUT WSW FLANGE BOLT FH W. SIDE DES PLAINES ST. ±200' S. OF S HARRISON ST.
BM 1366	XXX.XXX	CUT SQUARE ON CENTER OF DOOR ENTRANCE TO 707 W. HARRISON ST. SOUTH SIDE OF HARRISON ST. ±90' WEST OF WEST LINE OF DES PLAINES ST.

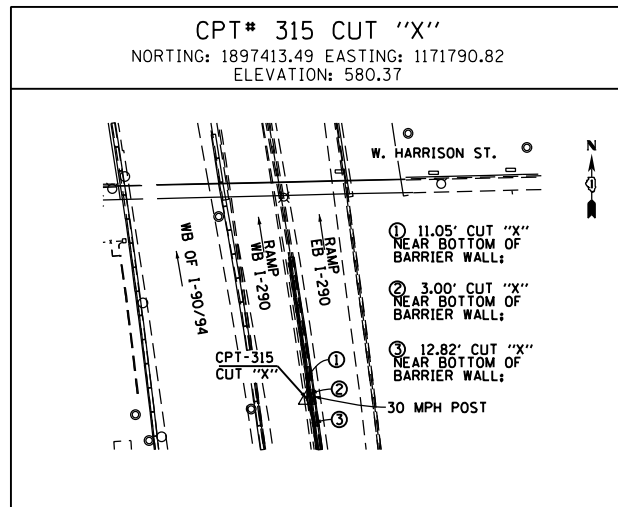
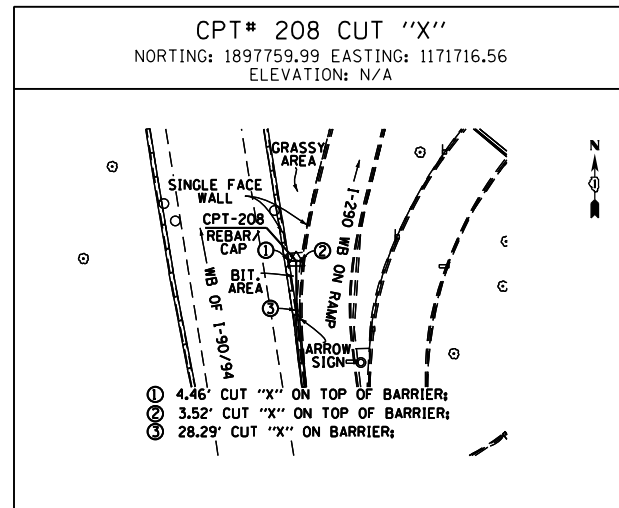
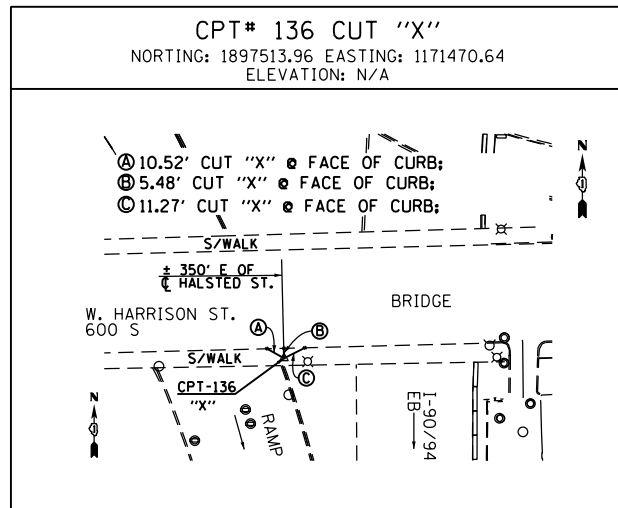
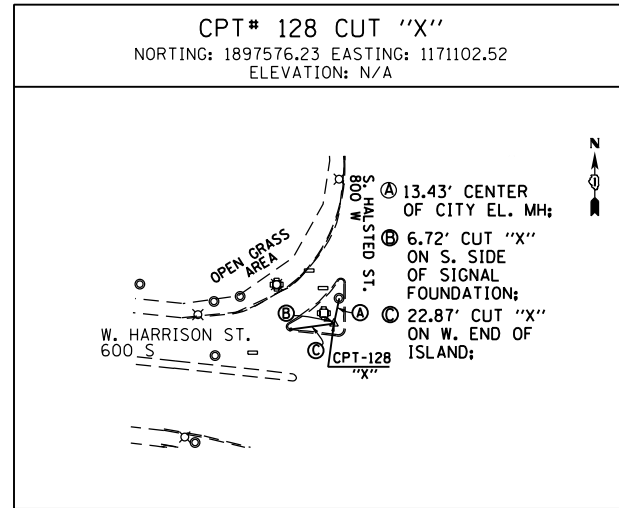
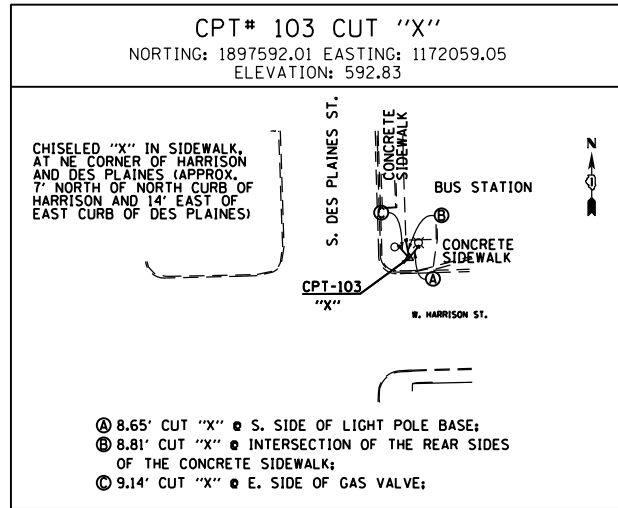

D:\60W71-sht-ATB-05.dgn  
 USER NAME = pimsarno  
 PLOT SCALE = 100.0000' / in.  
 PLOT DATE = 2/20/2014

DESIGNED - OPS  
 DRAWN - PHP  
 CHECKED - OPS  
 DATE - 02/19/14

REVISED -  
 REVISED -  
 REVISED -  
 REVISED -

STATE OF ILLINOIS  
 DEPARTMENT OF TRANSPORTATION

ALIGNMENT, TIES AND BENCHMARKS

SCALE: N.T.S. SHEET 5 OF 5 SHEETS STA. TO STA.

F.A.I. RTE.	SECTION	COUNTY	TOTAL SHEETS	SHEET NO.
90/94/290	2013-036R	COOK	256	31
CONTRACT NO. 60W71				
ILLINOIS FED. AID PROJECT				