

FILE PATH = p:\388035-p\m\1\escomon\me\local\p\AECD\000\Documents\01\_Americas\Transportation\62629938\_Circle\Phase\_1\000\_CAD\005\_Roadway\_Sheets\60W71\_Contract\0160W71-Sht-Plnprf-02.dgn

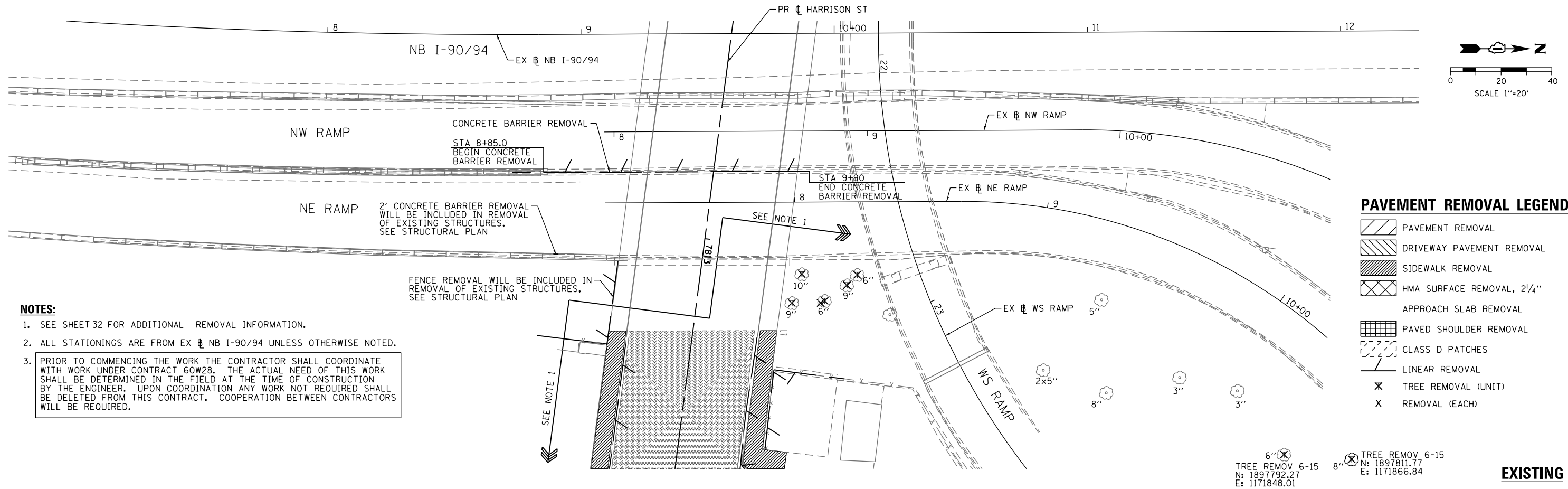

**NOTES:**

- SEE SHEET 32 FOR ADDITIONAL REMOVAL INFORMATION.
- ALL STATIONINGS ARE FROM EX NB I-90/94 UNLESS OTHERWISE NOTED.
- PRIOR TO COMMENCING THE WORK THE CONTRACTOR SHALL COORDINATE WITH WORK UNDER CONTRACT 60W28. THE ACTUAL NEED OF THIS WORK SHALL BE DETERMINED IN THE FIELD AT THE TIME OF CONSTRUCTION BY THE ENGINEER. UPON COORDINATION ANY WORK NOT REQUIRED SHALL BE DELETED FROM THIS CONTRACT. COOPERATION BETWEEN CONTRACTORS WILL BE REQUIRED.

**PAVEMENT REMOVAL LEGEND**

	PAVEMENT REMOVAL
	DRIVEWAY PAVEMENT REMOVAL
	SIDEWALK REMOVAL
	HMA SURFACE REMOVAL, 2 1/4"
	APPROACH SLAB REMOVAL
	PAVED SHOULDER REMOVAL
	CLASS D PATCHES
	LINEAR REMOVAL
	TREE REMOVAL (UNIT)
	REMOVAL (EACH)

6" (X) TREE REMOV 6-15  
 N: 1897792.27  
 E: 1171848.01  
 8" (X) TREE REMOV 6-15  
 N: 1897811.77  
 E: 1171866.84

**EXISTING**

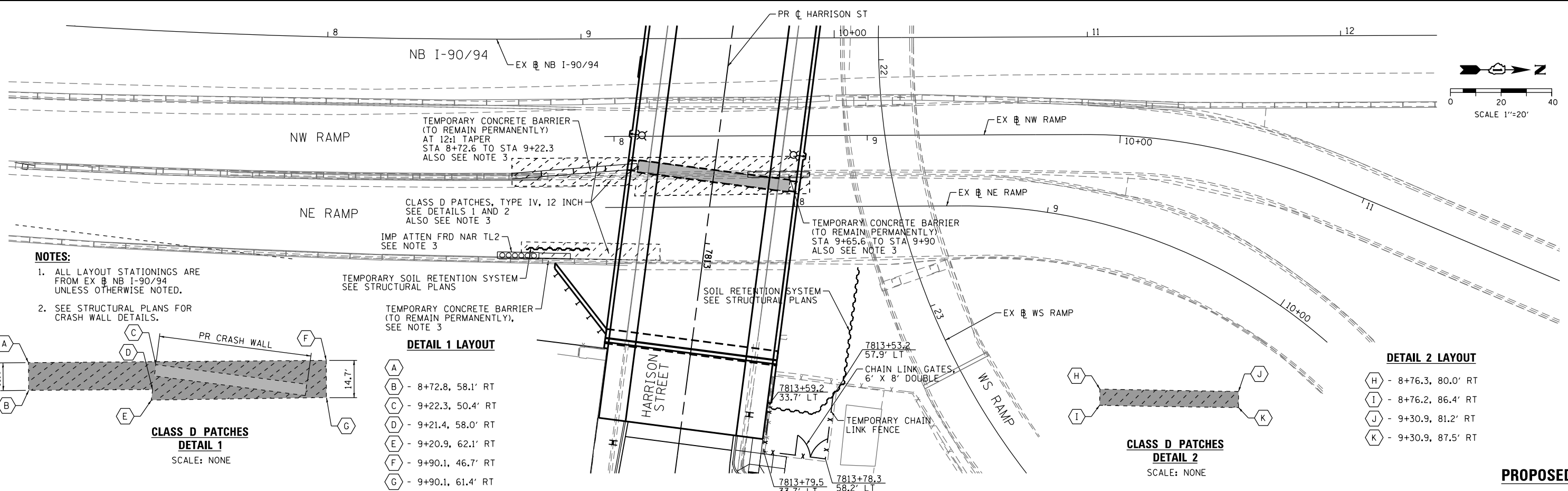

**NOTES:**

- ALL LAYOUT STATIONINGS ARE FROM EX NB I-90/94 UNLESS OTHERWISE NOTED.
- SEE STRUCTURAL PLANS FOR CRASH WALL DETAILS.

**DETAIL 1 LAYOUT**

A	- 8+72.8, 58.1' RT
B	- 9+22.3, 50.4' RT
C	- 9+21.4, 58.0' RT
D	- 9+20.9, 62.1' RT
E	- 9+90.1, 46.7' RT
F	- 9+90.1, 61.4' RT

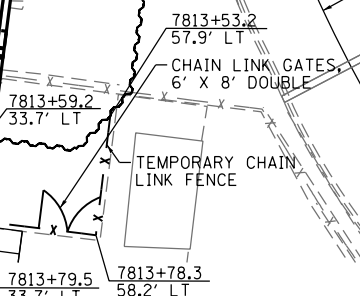
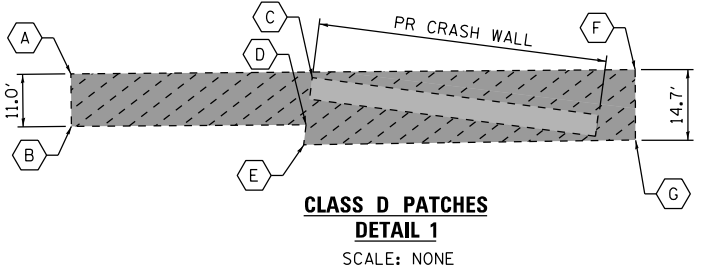

**DETAIL 2 LAYOUT**

H	- 8+76.3, 80.0' RT
I	- 8+76.2, 86.4' RT
J	- 9+30.9, 81.2' RT
K	- 9+30.9, 87.5' RT

**PROPOSED**



D160W71-Sht-Plnprf-02.dgn  
 USER NAME = pimsarno  
 PLOT SCALE = 40.0000' / in.  
 PLOT DATE = 2/20/2014

DESIGNED - OPS	REVISED -
DRAWN - OPS	REVISED -
CHECKED - DBM	REVISED -
DATE - 02/19/14	REVISED -

STATE OF ILLINOIS  
DEPARTMENT OF TRANSPORTATION

REMOVAL AND ROADWAY PLAN  
INTERSTATE

SCALE: 1" = 20' SHEET 1 OF 1 SHEETS STA. TO STA.

F.A.I. RTE.	SECTION	COUNTY	TOTAL SHEETS	SHEET NO.
90/94/290	2013-036R	COOK	256	33
CONTRACT NO. 60W71				
ILLINOIS FED. AID PROJECT				