

FILE PATH = p:\388035\pmt\ecom\line\local\p\AECD\00\Documents\01_Americas\Transportation\6269938_Circle\Phase_1\000_CAD\005_Roadway_Sheets\60W71-ht-Drain-05

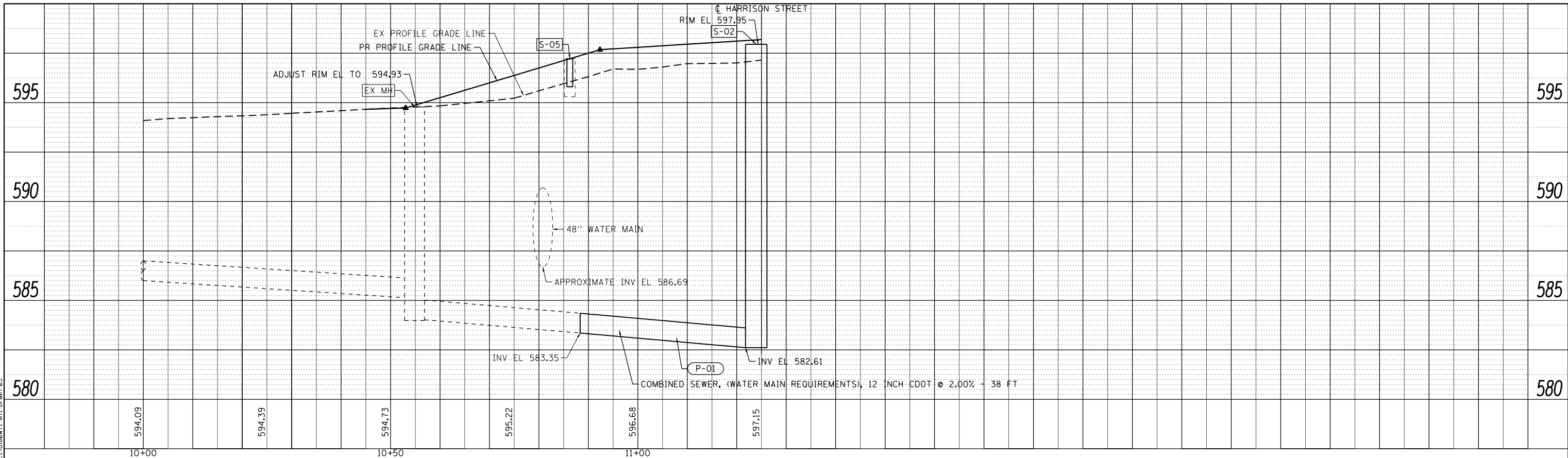

NOTES:
 EXISTING UTILITIES SHOWN ARE FOR LATERAL REFERENCE ONLY.
 THE CONTRACTOR IS RESPONSIBLE FOR IDENTIFYING ALL EXISTING
 SEWERS AND UTILITIES PRIOR TO CONSTRUCTION. THE CONTRACTOR
 SHALL REFER TO THE UTILITY LOCATION PLANS FOR ADDITIONAL
 INFORMATION.



D160W71-ht-Drain-05
 USER NAME = chitua
 PLOT SCALE = 10.0000' / in.
 PLOT DATE = 12/19/2013

DESIGNED - AFC	REVISED -
DRAWN - AFC	REVISED -
CHECKED - EY	REVISED -
DATE - 12/20/13	REVISED -

STATE OF ILLINOIS
 DEPARTMENT OF TRANSPORTATION

DRAINAGE AND UTILITY PROFILE
 EAST CERMAK PUMPING STATION
 SCALE: 1" = 10' SHEET 1 OF 1 SHEETS STA. TO STA.

F.A.I. RTE.	SECTION	COUNTY	TOTAL SHEETS	SHEET NO.
90/94	2013-036R	COOK	256	52
CONTRACT NO. 60W71				
ILLINOIS FED. AID PROJECT				