

NOTES:

1. SEE DRAWING E-01 FOR IDOT ELECTRICAL SYMBOLS.
2. PROVIDE AN EMPTY CONDUIT RUN FOR FUTURE USE.
3. ROUTE THE CONDUIT RUN DOWN THE BRIDGE PIER AND TERMINATE BELOW GRADE WITH PVC ELBOW ENCASED IN NON-REINFORCED CONCRETE AS SHOWN ON IDOT STANDARD DRAWING BE-902. THE CONCRETE ENCASED CONDUIT TRANSITION SHALL BE INCLUDED IN THE COST OF THE GALVANIZED RIGID STEEL CONDUIT PAY ITEMS. SEE SHEET E-04 FOR CONTINUATION OF THE LIGHTING CIRCUIT.

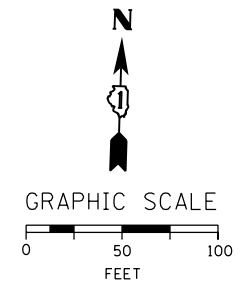
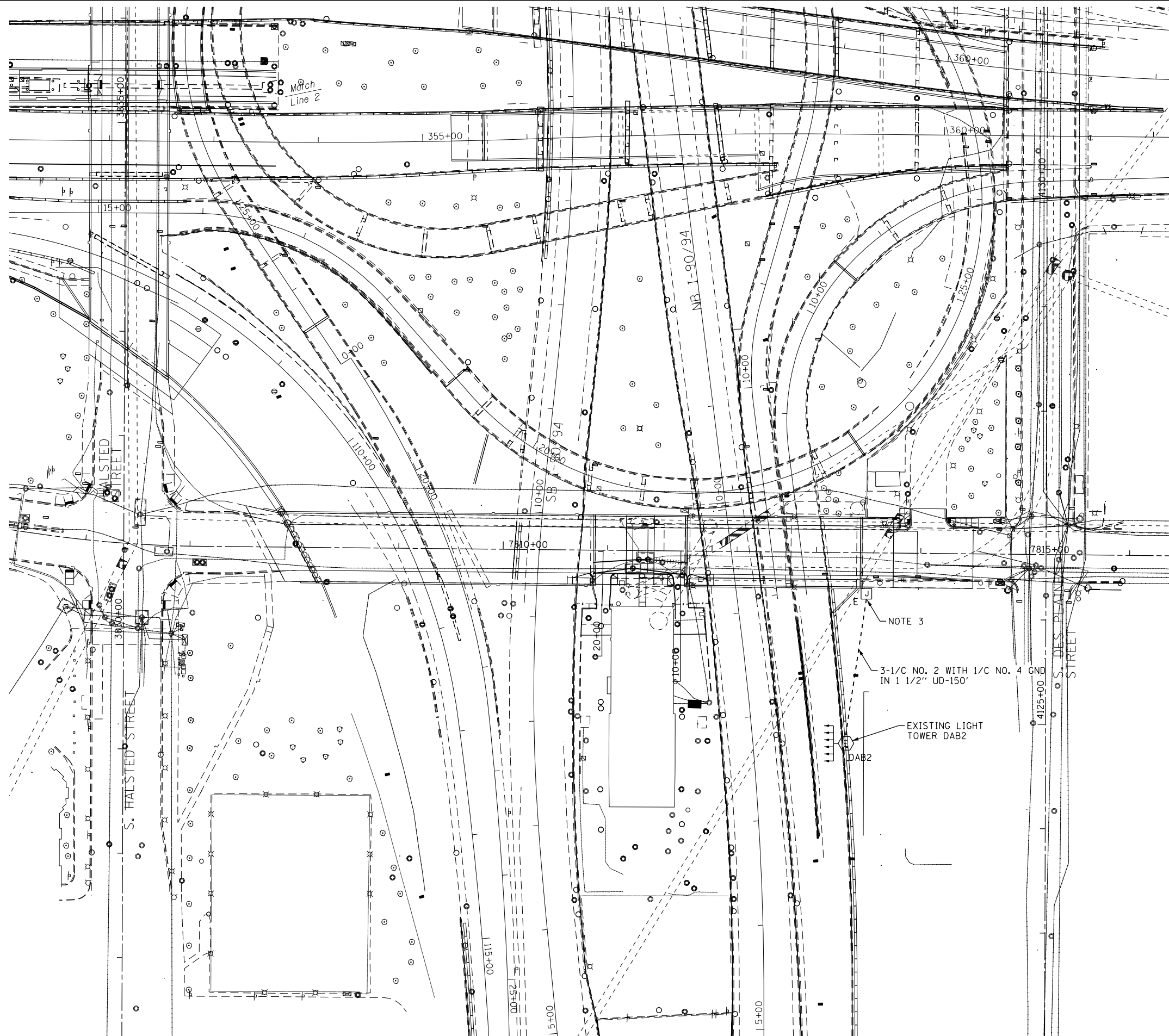

E-03

FILE PATH = p:\388035\pmt\escomonline\local\AECOM\Documents\01_Americas\Transportation\62629938_Circle\Phase_1\A\000_CAD\016_Electrical\Sheets\60W71_Contract\160W71-sht-Light-03



D160W71-sht-Light-03
 USER NAME = myersc
 PLOT SCALE = 50.0000' / 1" IN.
 PLOT DATE = 12/18/2013

DESIGNED - WDS	REVISED -
DRAWN - CAM	REVISED -
CHECKED - WDS	REVISED -
DATE - 12/20/13	REVISED -

**STATE OF ILLINOIS
 DEPARTMENT OF TRANSPORTATION**

I-90/94 PROPOSED LIGHTING PLAN

SCALE: 1"=50' SHEET 3 OF 19 SHEETS STA. TO STA.

F.A.I. RTE. 90/94/290	SECTION 2013-036R	COUNTY COOK	TOTAL SHEETS 256	SHEET NO. 75
CONTRACT NO. 60W71				
ILLINOIS FED. AID PROJECT				